







Coastal Wonders of Norway, the Faroe Islands, and Iceland

Trace the route of early Viking explorers and see their influence in wild, remote lands. Cruise the famed Norwegian fjords and the magical Lofoten islands, explore Stone Age sites in Scotland’s Shetland Islands, and come face to face with the legacy of the Vikings amid the turf-roofed cottages and ancient sites of the Faroe Islands. Then trace Iceland’s most remote shorelines, witnessing geological wonders from volcanoes to thundering waterfalls.

From
\$ 20,265 / per person
Does not include flights

 DATES Jun	 DURATION 16 Days
 SHIPS <i>National Geographic Endurance</i>	
 STARTS AT Tromsø, Norway	 ENDS AT Reykjavik

Highlights

- ★ Sail into Norway’s spectacular fjords and explore secluded inlets and coves by kayak or Zodiac
- ★ Observe nesting seabirds amid the towering peaks of the Lofoten islands, situated off Norway’s northwestern coast
- ★ Encounter the Bronze Age ruins and Viking longhouses of Jarlshof, a prehistoric settlement in the Shetland Islands
- ★ Zodiac cruise or hike in the scenic Westfjords of Iceland





Day by day

■ DAY 1

Oslo, Norway

Arrive in Oslo and transfer to our centrally located hotel. In the afternoon, our introduction to Norway begins with a tour of Oslo, including a visit to the Fram Museum, dedicated to the wooden ship sailed by Norwegian pole explorers such as Nansen and Amundsen. This evening, join your fellow travelers for a welcome reception.

Meals included: lunch, dinner

◇ DAY 2

Oslo / Tromsø / Embark Ship

Take a charter flight to Tromsø, known as the "gateway to the Arctic" due to the large number of Arctic expeditions that originated here. Visit the Arctic Cathedral, where the unique architecture evokes icebergs; and peruse the Polar Museum, which showcases the ships, equipment, and seafaring traditions of early Arctic settlers. Embark our ship this afternoon.

Meals included: breakfast, lunch, dinner

◇ DAY 3

Tysfjorden

This morning, enter the long fjord of Tysfjorden, where only a few small villages cling to the rocky shores. Glide beneath the fjord's steep walls on Zodiac and kayak excursions, and explore Hellemobotn Fjord, which reaches far inland, ending just a few miles from the border of Sweden.

Meals included: breakfast, lunch, dinner

◇ DAY 4

Lofoten Islands

Start your day on deck as we glide into Trollfjorden,

one of Norway's most dramatic fjords. Continue to the Lofoten archipelago, which boasts an enchanting landscape of picturesque villages framed by jagged, granite peaks that rise straight from the sea. Explore the many islets, and reposition to Værøy for walks and kayaking. Seek out Atlantic puffins, razorbills, and guillemots on a Zodiac cruise.

Meals included: breakfast, lunch, dinner

◇ DAYS 5-6

Exploring the Fjords of Norway

Carved by glaciers over millions of years, Norway's northern coast is laced with steep-walled fjords, mountainous islands, and chiseled peaks. Cruise in a Zodiac along vertical rock faces, kayak through serene fjords, or go ashore on a secluded sandy beach to hike amid verdant valleys and birch forests.

Meals included: breakfast, lunch, dinner

◇ DAY 7

At Sea / Shetland Islands, Scotland

Spend a relaxing morning at sea as we sail toward the Shetland Islands, an archipelago of about one hundred islands and islets located north of the Scottish mainland. Glide past the towering cliffs of Noss to look for murre, puffins, kittiwakes, and other seabirds. This evening, dock overnight in Lerwick.

Meals included: breakfast, lunch, dinner

◇ DAY 8

Lerwick / Foula

Lerwick is a town where Norse and Gaelic cultures intermingle. Explore the town, delve into local culture and history at the Shetland Museum and Archives, or embark on a bird-watching or geology

walk. Alternatively, venture to the prehistoric settlement of Jarlshof to examine its Bronze Age ruins and Viking longhouses. In the afternoon, continue to Foula, a stark but spectacular island edged with towering cliffs and blanketed with peat bogs, where people are drastically outnumbered by puffins.

Meals included: breakfast, lunch, dinner

◇ DAYS 9-10

Exploring the Faroe Islands

This morning, we arrive in the Faroe Islands, an autonomous archipelago within the Kingdom of Denmark. The legacy of the Vikings persists here, reflected in the language of the Faroese and their love of the sea. Visit Tórshavn, the colorful capital of the Faroe Islands, where even the government buildings are crafted in the traditional design of wooden siding with a turf roof. Visit the 12th-century St. Olav's Church alongside the ruins of Kirkjubøur's Magnus Cathedral, which was never completed. Navigate through the islands to one of the local communities on Eysturoy, the second largest island in the Faroes. Enjoy a day in the village experiencing the warm hospitality and stunning landscapes of their beautiful fjord.

Meals included: breakfast, lunch, dinner

◇ DAYS 11-12

At Sea / Seyðisfjörður, Iceland / Grímsey

After a day at sea, we awake along Iceland's rugged eastern coast, an unspoiled stretch of rocky outcrops, hidden coves, and hills that beckon hikers. We visit Seyðisfjörður, a charming fishing village located in the mouth of a majestic fjord and surrounded by dramatic mountains. Choose to explore the town or visit Skálanes Nature Reserve to see its colorful wildflowers and bird cliffs. Continue to Grímsey on the Arctic Circle.

Meals included: breakfast, lunch, dinner

◇ DAYS 13-14

Ísafjörður / Flatey Island

Located in the Westfjords region, the town of Ísafjörður lies on a tiny spit jutting out into the water against a backdrop of steep hills. Spend time hiking and watching for nesting seabirds in this remote setting. The next day, visit Flatey island, a fishing and trading post for centuries.

Meals included: breakfast, lunch, dinner

◇ DAY 15

Westman Islands

Spend the day in the Westman Islands, one of the world's younger archipelagos, formed by undersea volcanos some 11,000 years ago. In 1973, the isle of Heimaey was threatened by lava flows that nearly closed off the harbor. We visit the Eldfell volcanic crater, where the earth is still hot, and take in views over landscapes engulfed in lava rock. We also observe Surtsey, one of the world's youngest islands, which was formed by volcanic eruptions between 1963 and 1967.

Meals included: breakfast, lunch, dinner

■ DAY 16

Reykjavík / Disembark Ship / Home

Disembark in Reykjavík and take a morning excursion. After lunch, transfer to the airport for flights home.

Meals included: breakfast, lunch

2024 Expedition

Tromsø, Norway → Reykjavík

2024 Departure Dates

Aboard *National Geographic Endurance*

23 Jun		
--------	--	--

2025 Departure Dates

Aboard *National Geographic Endurance*

24 Jun		
--------	--	--



National Geographic Endurance

Guests	Cabins
138	76

The most advanced ice-class expedition ship afloat, the *National Geographic Endurance* offers unprecedented access to polar regions.

The first new polar build in Lindblad's 50-year history, *National Geographic Endurance* is named to honor explorer Ernest Shackleton and his legendary Transantarctic Expedition.

A fully-stabilized vessel of the highest ice class (PC5 Category A), she will enable adventurous guests to go where few have or can. Endurance's most striking exterior feature is her distinctive profile, the patented X-Bow®, a game-changing design that guarantees the smoothest, most comfortable ride in all kinds of conditions; and since it eliminates bow impact, a quieter ride, as well.

An equally impressive feature may well be her capacity: she carries just 138 guests, a commitment to expedition excellence over scale. Scandinavian-inflected, luxuriously appointed, her inviting interiors would be a destination in themselves. Because she is a Lindblad expedition ship, however, her attention is focused on the world outside—with acres of window glass to keep you connected to the stunning views beyond the pane, and a fleet of expedition tools to get you out exploring.

National Geographic Endurance and *National Geographic Resolution* are next-generation expedition ships. Purpose-built for polar navigation. Fully stabilized, highly strengthened, ice-class Polar Code PC5 (Category A) vessels, they are designed to navigate polar passages year-round, and safely explore uncharted waters, while providing exceptional comfort. The patented X-bow[®] is key to their design; its powerful wave-slicing action provides an extremely smooth ride even in adverse conditions, and even reduces spray on deck for superior observation. They carry a full suite of expedition tools, and offer a variety of experience enhancing amenities.



Cabin Categories

Category 1

Fore Deck: #406, 408, 411, 413, 415

Fore Deck, with two large windows, two singles that can convert to a queen, armchair, writing desk and chair, two bedside tables, window sofa, and a closet.



Category 2

Fore Deck: #410, 412, 414, 416-419, 421-427

Fore Deck, with two large windows, two single beds that can convert to a queen, window sofa, 2 seat sofa, coffee table, armchair, writing desk with an office chair, two bedside tables, and a closet.



Category 3

Main Deck: #512-524

Suite with balcony that features two balcony chairs, hammock, and a table; two single beds that convert to a queen, convertible sleeper sofa, writing desk with a chair, two bedside tables, and a closet.



Category 4

Lounge Deck: #608, 610, 612, 613-623

Suite with balcony that features two balcony chairs, hammock, and a table; two single beds that convert to a queen, convertible sleeper sofa, writing desk with a chair, two bedside tables, and a closet.



Category 5

Bridge Deck: #700-707, 712, 713, 715, 717

Cabin with balcony that features two balcony chairs, hammock, and a table; two single beds that convert to a queen; convertible sleeper sofa; coffee table; writing desk with chair; two bedside tables; and a closet.



Category 6

Bridge Deck: #714

Junior suite with balcony that features two balcony chairs, hammock, and table; two single beds that convert to a queen; pull-out sofa; writing desk with chair; two bedside tables; coffee table; espresso maker; and a closet. Guests receive a welcome amenity, complimentary laundry, priority access to one igloo reservation, and one spa appointment per departure.



Category 7

Bridge Deck: #708-711, 716, 718, 719, 721

These large balcony suites feature two balcony chairs, hammock, and table; two single beds that can convert to a queen; pull-out sofa; coffee table; writing desk and chair; espresso maker; hammock; and a large walk-in closet with full length mirror. Expanded bathroom has a double vanity, bathtub, towel warmer, and rain shower. Guests receive a welcome amenity, complimentary laundry, priority access to one igloo reservation, and one spa appointment per departure.



Category A Solo

Main Deck: #504-510, 513

Suite with balcony that features two balcony chairs and a table; single bed, writing desk with an office chair, bedside table, and a closet.



Category B Solo

Lounge Deck: #604-607, 609, 611

Suite with balcony that features two balcony chairs, hammock, and a table; single bed, bedside table, writing desk with chair, hammock, and a closet.



Observation Deck

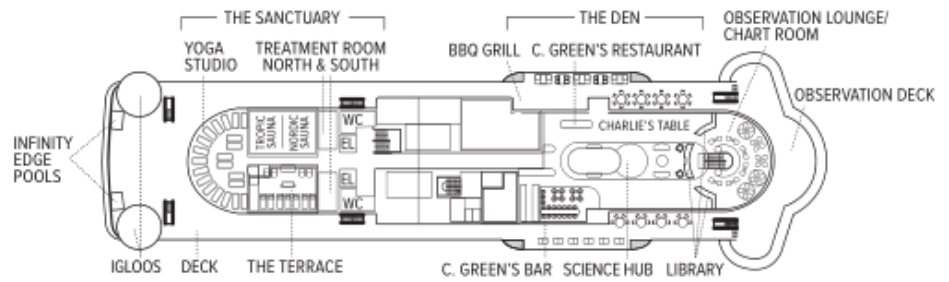

Bridge Deck

- Category 5
- Category 6
- Category 7

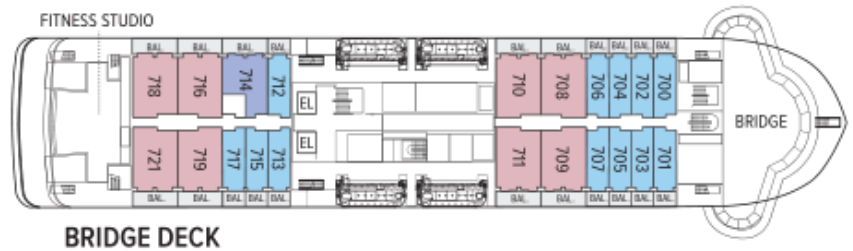

Lounge Deck

- Category 4
- Category B Solo



Main Deck

- Category 3
- Category 2 Solo



Fore Deck

- Category 1
- Category 2



Expedition Deck

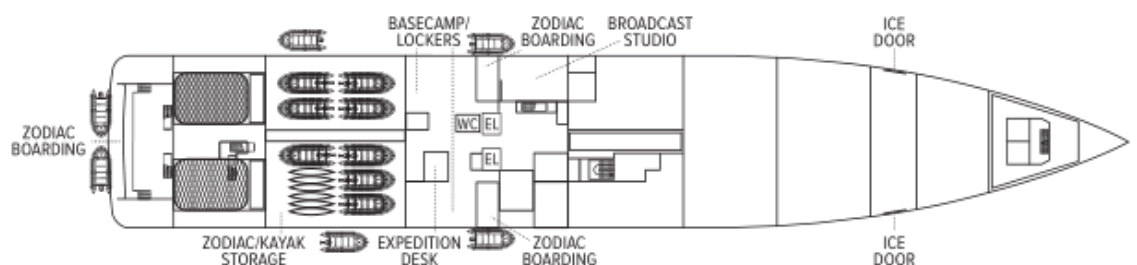

Ship amenities

Public Areas

Reception; three dining areas; an observation lounge with bar, gym, wellness area, infinity-style outdoor hot tubs with adjacent igloos; library; main lounge with full service bar, 24-hour beverage station, state-of-the-art tech for films/presentations; B&H Photo locker and a photo workshop area; science hub; an onboard broadcast studio; an expedition base with lockers for expedition gear; and open access to the Bridge, Captain, officers and on-duty wildlife spotters.

Meals

Restaurant 270° features wrap-around views; two other dining areas offer lighter, made-to-order fare or intimate, small group dinners. All feature sustainable choices, local where possible, and unassigned, flexible, inclusive seating.

Cabins

All cabins face outside with large windows, private bathroom, and climate controls. Cabins are equipped with expedition command centers with iPad tablets, multiple electrical and USB outlets, TVs, with on demand entertainment, phone, Wi-Fi, clock, barometers, hygrometers, vanity mirror, mini refrigerator, small safe, ice bucket, glasses, hair dryer, reading lights and National Geographic Atlas. Luxury linens and pillows. Bathrooms outfitted with Rain showers & hand held shower, botanically inspired shampoo, conditioner, shower gel and lotion. Complimentary insulated water bottles. Balcony cabins have hammocks, chairs and table.

Expedition Equipment

Zodiac landing craft, kayaks, snowshoes, cross-country skis, an ROV and underwater video camera for unique access to the polar undersea, hydrophone, aerial remote-controlled camera and video microscope.

Special Features

A full-time doctor, undersea specialist, National Geographic photographer, Lindblad-National Geographic certified photo instructor and video chronicler, an internet cafe and laundry. A forward and aft staircase, and elevators, reach all decks. Echoing the pioneering installation aboard *National Geographic Endurance*, artist Zaria Forman has curated a new exhibit, featuring a wide range of artists.



Wellness

A glass-enclosed yoga studio, gym, treatment rooms and spa relax area, and high and low-heat saunas with ocean views, staffed by wellness specialists.

Self-Disinfecting Ships

ACT Clean Coat™ is a light-activated, self-disinfecting cleaning process that continuously breaks down viruses, bacteria, mold, and airborne allergens across all ship surfaces. Not only does this create a cleaner, healthier shipboard environment for guests and crew alike, but this non-toxic, chemical-free system also saves more than one million gallons of water each year in our cleaning procedures, and reduces our carbon footprint as well as the amount of plastic and waste in our supply chain.

Special Offers

SUITE EXCLUSIVES

Spacious living areas and incredible views immerse you in the beauty of your marine surroundings.

Our new Suite Exclusives package helps make your voyage all the more memorable. [Learn more](#)

10% OFF BACK-TO-BACK VOYAGES

Save 10% on consecutive departures, applicable on voyage fares only and not valid on extensions or airfare. Valid for new bookings only, subject to availability, and may not be combined with other offers. Call for details.

CELEBRATE LIFE'S MILESTONES

Celebrate a milestone with a group of eight or more and enjoy a special amenity package including: 5% savings on voyage fares, custom group photo, US\$150 shipboard credit for the group, and other special gifts. Milestone celebration to be communicated at time of booking. Valid for new bookings only on select departures, subject to availability, not applicable on airfare or extensions, and may not be combined with other offers. Deposit, final payments, and cancellation policies for group travel vary from our regular policies. Call for details.

COMBINING OFFERS

Certain offers may be combinable, up to two savings opportunities, except where noted otherwise. For example, travel with a group of 8 or more on back-to-back expeditions, and take advantage of both savings.

BRINGING THE KIDS

We believe sharing an expedition with children is a life-enhancing experience. Take \$500 off for each child under the age of 18 on any departure. Not applicable on extensions or airfare. Call for details.

SAVE 5% TRAVELING AS A GROUP

Save 5% when traveling as a group of eight or more people. Valid on voyage fares only and not applicable on extensions or airfare. Deposit, final payments, and cancellation policies for group travel vary from our regular policies. Valid for new bookings only, subject to availability, and may not be combined with other offers. Call for details.

Included in price

All accommodations aboard ship or in hotels per itinerary; all meals as indicated in the itinerary, both aboard and onshore; beer, wine, cocktails, and spirits aboard the ship (except certain super premium brands which are available for purchase); hors d'oeuvres, 24-hour access to snacks, premium coffees and teas, non-alcoholic beverages, and filtered water; excursions and airport transfers to and from recommended flights, as indicated in the itinerary; crew gratuities; exploration tools curated to destination, such as Zodiacs, kayaks, guidance and company of our leading expedition staff; assistance by the National Geographic Photography Expert and Lindblad Expeditions-National Geographic certified photo instructor; access to the OM System Photo Gear Locker; presentations by expedition staff and expert guest speakers; complimentary parka or jacket, complimentary reusable water bottle; services of a physician, physician's assistant, nurse practitioner, or paramedic; morning stretch classes and 24-hour access to exercise equipment; 24-hour access to lounges, observation decks, library, and other shared spaces; park and site entrance fees, special access permits, and port taxes. Unused services or items included in our programs are non-refundable.

Not included in price

Airfare (except flights when indicated as included); pre- and post-expedition extensions; additional hotel nights (except when indicated as included); private transfers; laundry, spa treatments, Wi-Fi, and phone services (except when indicated as included); travel protection plans; and passport, visa, and immigration fees.

Travel protection plan

We strongly recommend our guests to take advantage of our Travel Protection Plan. This plan offers comprehensive coverage to protect you from cancellation fees, costs incurred due to trip delays/interruption, damage or loss of baggage, medical assistance, and evacuation during your travels. Our Travel Protection Plan is available for U.S. residents only, and may be purchased any time prior to final payment due date, Travel Protection premiums are non-refundable once plan is purchased. Learn more about our Travel Protection "Plus" Plan: <https://www.expeditions.com/terms-conditions/travel-protection-plan/>

Cancellation policy

Review our cancellation policy: <https://www.expeditions.com/cancellation-policy/>