



Alaska & North America
56° 46' N 132° 53' W

Treasures of the Inside Passage: Alaska and British Columbia

Enjoy active exploration amid a dramatic scenery of mountains, fjords, rivers and glaciers along the Inside Passage of Alaska and British Columbia. Led by our Expedition Team of naturalists and experts, learn all about the nature and wildlife we encounter. Learn about the living indigenous culture of the region from the Kwakwaka'wakw people; explore the charming provincial capital of Victoria; and sail the waters where orcas gather to hunt in Johnstone Strait.

From
\$ 9,124 / per person
Does not include flights



DATES

Apr, May and
Sep



DURATION

14 Days



SHIPS

National Geographic Venture
National Geographic Quest



STARTS AT

Seattle,
Washington



ENDS AT

Sitka, Alaska

Please review the [Essential Eligibility Criteria](#) for hiking activities on this voyage.

The [National Park Service](#) and the Department of the Interior authorize this institution to serve the public in Glacier Bay National Park and Preserve.

This institution is an [equal opportunity provider](#).

Highlights

- ★ Hike the San Juan Islands, and cruise where orcas gather annually to hunt within the isles' inlets and bays
- ★ Sail into Glacier Bay National Park and spend a full day discovering the grand scale of the mountains, fjords, and active glaciers
- ★ Stroll through the 100-year-old fishing town of Petersburg and learn about its Norwegian heritage
- ★ In Misty Fjords National Monument, kayak along sheer cliffs and forested backwaters





Day by day

■ DAY 1

Seattle, Washington / Embark Ship

Arrival Time: Arrive by 2:00 p.m. local time.

Arrival City: Seattle

Arrive in Seattle this afternoon and embark *National Geographic Quest* or *National Geographic Venture*.

Meals included: dinner

◇ DAY 2

San Juan Islands, Washington

Spend a full day exploring the San Juan Islands via Zodiac, kayak, and naturalist-led hikes. Search for whales, seals, and sea lions in rocky inlets, and marvel at bald eagles while walking through lush forests.

Meals included: breakfast, lunch, dinner

◇ DAY 3

Victoria, British Columbia

Clear into Canada in the charming city of Victoria and choose from several tailor-made options to explore based on your interests. Visit private gardens, bike along the waterfront, take a stroll through history in Old Town, or discover James Bay on an architecture tour. In the evening, enjoy a private reception at the Art Gallery of Greater Victoria.

Meals included: breakfast, lunch, dinner

◇ DAY 4

Gulf Islands

Located in the Strait of Georgia, between the mainland of British Columbia and Vancouver Island, the Gulf Islands are a kayaker's paradise. Explore the myriad islets and rocky coasts and keep an

eye out for harbor seals and an array of seabirds, shorebirds and birds of prey.

Meals included: breakfast, lunch, dinner

◇ DAY 5

Alert Bay and Johnstone Strait, British Columbia

Sail through Johnstone Strait, a waterway cut through a magnificently wild and scenic area of mountains and islands. These ocean waters are also home to extraordinary marine mammals and bird watching. Visit the Big House in the First Nations village of Alert Bay, Canada and gain insight from the Kwakwaka'wakw people who will share their art, music, and regional knowledge.

Meals included: breakfast, lunch, dinner

◇ DAYS 6-7

Inside Passage of British Columbia

Cruise northward along the pristine coastline in search of whales, dolphins, bears, deer, and other wildlife. Go ashore to explore or kayak among the many bays and inlets.

Meals included: breakfast, lunch, dinner

◇ DAY 8

Misty Fjords, Alaska

Enjoy the day soaking up the spectacular scenery of Alaska's Misty Fjords National Monument, a 2.3-million-acre wilderness of sheer rock walls, temperate rain forest, and glacier-sculpted waterways. Kayak in the still, forested backwaters of this protected national treasure and discover a pristine habitat for brown bears, bald eagles, harbor seals, and more.

Meals included: breakfast, lunch, dinner

◇ DAY 9

Petersburg

Search for humpback whales on the approach to picturesque Petersburg, a small fishing village on Alaska's Mitkof Island that retains much of its Norwegian heritage. Explore a unique Southeast Alaska ecosystem, the muskeg, with stunted trees and carnivorous plants. There is an opportunity to stretch your legs with an optional bike ride around town. This evening, enjoy a crab feast.

Meals included: breakfast, lunch, dinner

◇ DAY 10

Tracy Arm-Ford's Terror Wilderness

Voyage into Tracy or Endicott Arm, both spectacular fjords with waterfalls cascading from glacially carved walls. See the soaring Dawes or South Sawyer Glacier up close and take a cruise in a Zodiac for an unbeatable view among sculpted icebergs. Keep an eye out for harbor seals, harbor porpoises, and arctic terns.

Meals included: breakfast, lunch, dinner

◇ DAY 11

Glacier Bay National Park

Spend the entire day cruising amid the coves, fjords, tidewater glaciers, and majestic mountains of Glacier Bay National Park. See glaciers that end abruptly at the water's edge and observe them calving, when tons of ice separate and crash into the water accompanied by a thunderous sound.

Meals included: breakfast, lunch, dinner

◇ DAY 12

Inian Islands / Icy Strait

Cruise among the Inian Islands, where Steller sea lions and sea otters abound. Hike nearby islands, kayak, and search for whales in the nutrient-rich

waters of Icy Strait.

Meals included: breakfast, lunch, dinner

◇ DAY 13

Exploring Baranof or Chichagof Island

Spend a full day kayaking, hiking, and searching for bubble-net feeding or breaching humpback whales.

Meals included: breakfast, lunch, dinner

■ DAY 14

Sitka / Disembark Ship

Disembark after breakfast in scenic Sitka on the western coast of Baranof Island. Schedules permitting, walk among Tlingit and Haida totem poles at Sitka National Historic Park and visit the Alaska Raptor Center for an up-close look at Alaska's birds of prey. Transfer to the airport for flights home.

Departure Time: After 1:00 p.m. local time.

Departure City: Sitka, Alaska

Meals included: breakfast

Northbound

Seattle, Washington → Sitka, Alaska

2024 Departure Dates

Aboard *National Geographic Quest*

06 May

Aboard *National Geographic Venture*

28 Apr

2025 Departure Dates

Aboard *National Geographic Quest*

12 May

Aboard *National Geographic Venture*

27 Apr

Alternative Routes

Visit Expeditions.com for more information.

2024 Departure Dates

08 Sep

2025 Departure Dates

14 Sep



National Geographic Venture

Guests

100

Cabins

50

The *National Geographic Venture* is a state-of-the-art expedition ship ideal for discovering remote locations in domestic waters.

Following the build of *National Geographic Quest* at Nichols Brothers shipyard, her sister ship the 100 guest *National Geographic Venture* floated into the bay on Whidbey Island, becoming the 4th ship in the Lindblad fleet built at this storied PNW shipyard. In the 1970s, Nichols Brothers built the twin ships *National Geographic Sea Bird* and *National Geographic Sea Lion*, which continue to sail the waters of the west coast of North America and Central America.

Venture, like much of the wildlife she follows, is migratory. She follows the seasons from Alaska, along the coast of British Columbia, up the Columbia & Snake Rivers, and along the Baja coast and into the Sea of Cortez. In each region, her design innovations were informed by 50+ years of expedition expertise to ensure extraordinary discoveries. Larger than her sibling twin ships, *National Geographic Sea Bird* and *National Geographic Sea Lion*, *National Geographic Venture* has the same shallow draft, enabling her to nimbly navigate the same inner reaches and provide the same intimate, 'insider' experiences of the charismatic regions we explore.

Like her sister ship *National Geographic Quest*, *National Geographic Venture* has dual boarding platforms, enabling our team to load two Zodiacs at once means guests get off ship quickly, to take advantage of wildlife sightings and maximize exploring time. Modern, cleaned-lined, with large expanses of glass to keep you connected to the extraordinary views, *National Geographic Venture* enables you to see, do and experience the best of her geographies.



Cabin Categories

Category 1

Main Deck: #301-306

Cabins feature two single beds that can convert to a Queen, a writing desk, two nightstands and two portholes, full length mirror, and reading lights.



Category 2

Main Deck: #307-315

Cabins feature two single beds that can convert to a Queen, a writing desk, two nightstands and two portholes, full length mirror, and reading lights.



Category 3

Upper Deck: #201-206

Cabins feature two single beds that can convert to a Queen, a writing desk, two nightstands, a large view window, full-length mirror, and reading lights.



Category 4

Upper Deck: #207-229

Cabins feature two single beds that can convert to a Queen, a writing desk, closet, two nightstands, full-length mirror, reading lights, sliding glass door, and a small, private balcony.



Note: Solo occupancy cabins are available in Categories 1 and 2 only. Third person rates are available in Category 5 cabins at one half the double occupancy rate.

Connecting Cabins via internal doorway access:

Main Deck: #312-314, #311-315, #306-307;
Upper Deck: #224-226, #225-227

Category 5

Observation Deck: #101-108 (SUITE)

Cabins feature two single beds that can convert to a Queen, large view windows, closet, two nightstands, full-length mirror, reading lights, a suite-sized expanded bathroom, writing desk, ample storage space, and a convertible sofa bed to accommodate a third person.



Observation Deck

Category 5

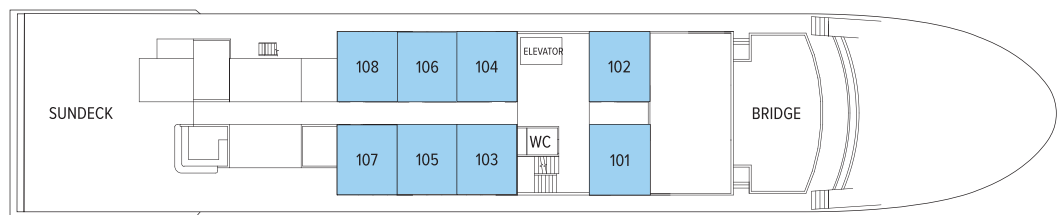

Lounge Deck

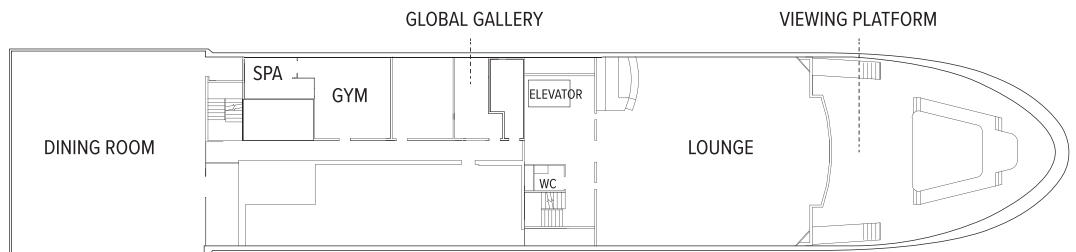

Upper Deck

Category 3

Category 4

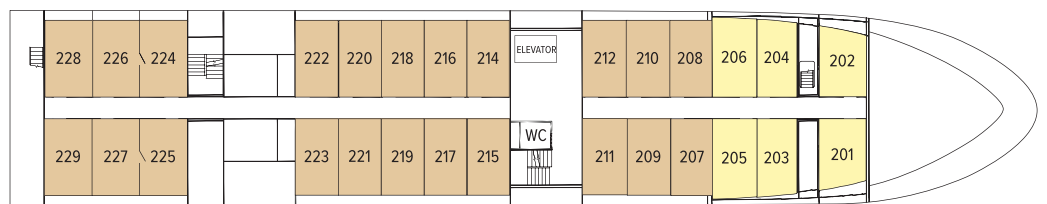

Main Deck

Category 1

Category 2

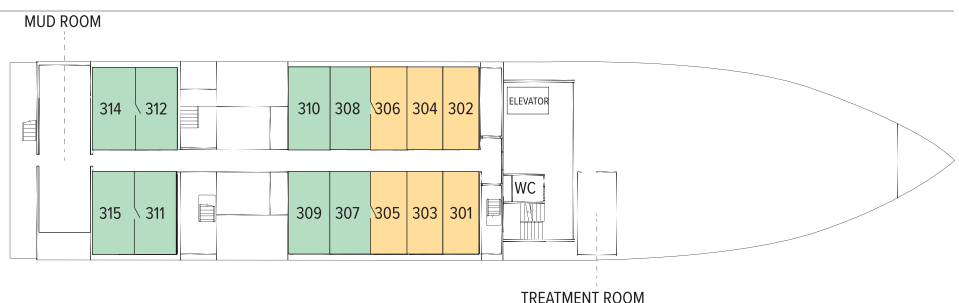

Ship amenities

Public Areas

Reception; main dining area; global gallery; fitness center; lounge with full-service bar and state-of-the-art presentation facilities; observation deck; mudroom with lockers for expedition gear; partially-covered furnished sundeck; plus open access to the Bridge, the Captain, officers and on-duty wildlife spotters.

Meals

Meals are served in the dining room at a single seating with unassigned tables for an informal atmosphere and easy mingling. Menus feature sustainable choices, local where possible.

Cabins

50 outside cabins. All cabins face outside with windows, private bathroom, and climate controls. Cabins are equipped with Wi-Fi, phone, multiple electrical and USB outlets, and phones. Luxury linens and pillows. Botanically inspired shampoo, conditioner, shower gel, and lotion are all available in cabin bathrooms, as well as an Expedition Essential Kit. Hair dryers, complimentary insulated water bottles and a National Geographic Atlas are also available in each cabin.

Expedition Equipment

A fleet of 8 Zodiacs, 24 kayaks, paddleboards; an ROV, hydrophone, splash-cam, underwater video camera, video microscope; snorkeling gear and wet suits for all guests (where applicable).

Special Features

Lindblad-National Geographic certified photo instructor, undersea specialist and video chronicler. Internet access. Elevator. The design of the outside decks—with the perfect wildlife viewing platform. And the way the proximity of the Lounge to the deck gives you instant access to spontaneous sightings. Have your camera ready!

Wellness

A fitness center with elliptical, treadmill, weights, resistance bands; LEXspa treatment room, staffed by wellness specialists.



Self-Disinfecting Ships

ACT Clean Coat™ is a light-activated, self-disinfecting cleaning process that continuously breaks down viruses, bacteria, mold, and airborne allergens across all ship surfaces. Not only does this create a cleaner, healthier shipboard environment for guests and crew alike, but this non-toxic, chemical-free system also saves more than one million gallons of water each year in our cleaning procedures, and reduces our carbon footprint as well as the amount of plastic and waste in our supply chain.



National Geographic Quest

Guests

100

Cabins

50

***National Geographic Quest*, built in 2017, is designed for sailing into fast-moving channels and shallow coves in pan-American waters.**

When she rolled out of Nichols Brothers shipyard and into the bay on Whidbey Island, the 100 guest *National Geographic Quest* became the third ship in the Lindblad fleet built at this storied Pacific Northwest shipyard. In the 1970s, Nichols Brothers built the twin ships *National Geographic Sea Bird* and *National Geographic Sea Lion*, which continue to sail the waters of the west coast of North America and Central America.

National Geographic Quest was purpose-built to explore the fast-moving channels and narrow straits of Alaska, along the coast of Costa Rica, and into the gray whale nursery lagoons of Baja, her design and engineering informed by our nearly 40 years of experience in these regions. Her twin boarding platforms, for example, were suggested by a veteran staffer. Enabling our team to load two Zodiacs at once means guests get off the ship quickly to take advantage of wildlife sightings and maximize exploring time.

Larger than her siblings *National Geographic Sea Bird* and *National Geographic Sea Lion*, *National Geographic Quest* has the same shallow draft, allowing her captain to navigate the same inner reaches and provide the same intimate, "insider" experiences in these charismatic regions. Modern, clean-lined, with large expanses of glass to keep you connected to the extraordinary views, *National Geographic Quest* enables you to see, do, and experience the best of her geographies.



Cabin Categories

Category 1

Main Deck: #301-306

Cabins feature two single beds that can convert to a Queen, a writing desk, two nightstands and two portholes, full length mirror, and reading lights.



Category 2

Main Deck: #307-315

Cabins feature two single beds that can convert to a Queen, a writing desk, two nightstands and two portholes, full length mirror, and reading lights.



Category 3

Upper Deck: #201-206

Cabins feature two single beds that can convert to a Queen, a writing desk, two nightstands, a large view window, full-length mirror, and reading lights.



Category 4

Upper Deck: #207-229

Cabins feature two single beds that can convert to a Queen, a writing desk, closet, two nightstands, full-length mirror, reading lights, sliding glass door, and a small, private balcony.



Note: Solo occupancy cabins are available in Categories 1 and 2 only. Third person rates are available in Category 5 cabins at one half the double occupancy rate.

Connecting Cabins via internal doorway access:

Main Deck: #312-314, #311-315, #306-307;
Upper Deck: #224-226, #225-227

Category 5

Observation Deck: #101-108 (SUITE)

Cabins feature two single beds that can convert to a Queen, large view windows, closet, two nightstands, full-length mirror, reading lights, a suite-sized expanded bathroom, writing desk, ample storage space, and a convertible sofa bed to accommodate a third person.



Observation Deck

Category 5

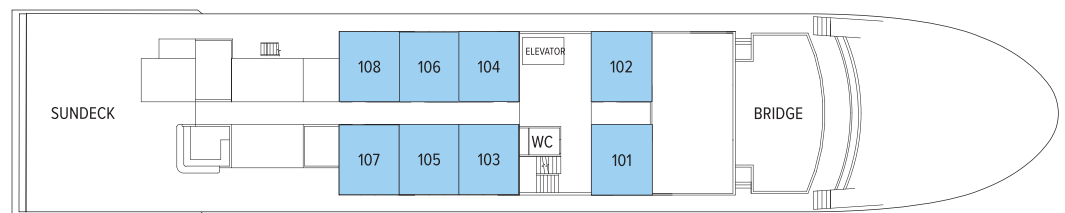

Lounge Deck

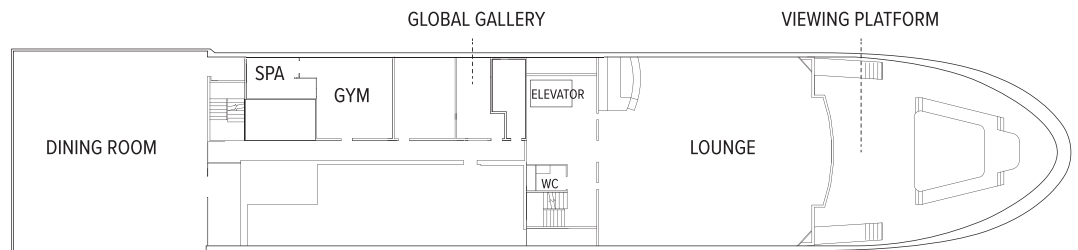

Upper Deck

Category 3

Category 4

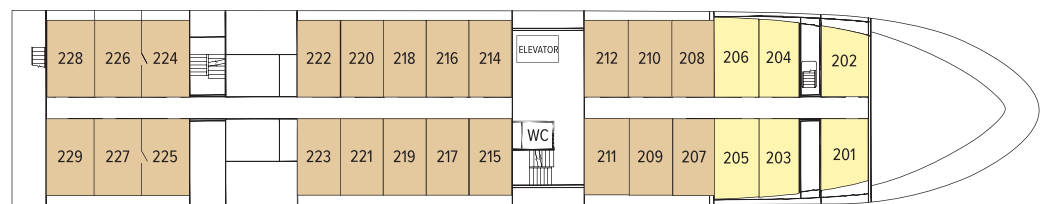

Main Deck

Category 1

Category 2

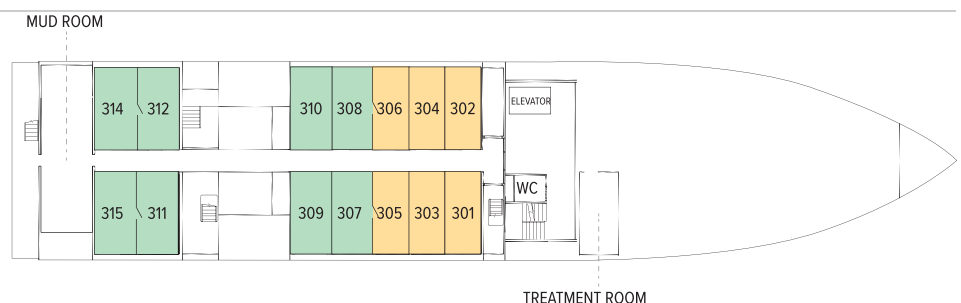

Ship amenities

Public Areas

Reception; main dining area; global gallery; fitness center; lounge with full-service bar and state-of-the-art presentation facilities; observation deck; mudroom with lockers for expedition gear; partially-covered furnished sundeck; plus open access to the Bridge, the Captain, officers and on-duty wildlife spotters.

Meals

Meals are served in the dining room at a single seating with unassigned tables for an informal atmosphere and easy mingling. Menus feature sustainable choices, local where possible.

Cabins

50 outside cabins. All cabins face outside with windows, private bathroom, and climate controls. Cabins are equipped with Wi-Fi, phone, multiple electrical and USB outlets, and phones. Luxury linens and pillows. Botanically inspired shampoo, conditioner, shower gel, and lotion are all available in cabin bathrooms, as well as an Expedition Essential Kit. Hair dryers, complimentary insulated water bottles and a National Geographic Atlas are also available in each cabin.

Expedition Equipment

A fleet of 8 Zodiacs, 24 kayaks, paddleboards; an ROV, hydrophone, splash-cam, underwater video camera, video microscope; snorkeling gear and wet suits for all guests (where applicable).

Special Features

Lindblad-National Geographic certified photo instructor, undersea specialist and video chronicler. Internet access. Elevator. The design of the outside decks—with the perfect wildlife viewing platform. And the way the proximity of the Lounge to the deck gives you instant access to spontaneous sightings. Have your camera ready!

Wellness

A fitness center with elliptical, treadmill, weights, resistance bands; LEXspa treatment room, staffed by wellness specialists.



Self-Disinfecting Ships

ACT Clean Coat™ is a light-activated, self-disinfecting cleaning process that continuously breaks down viruses, bacteria, mold, and airborne allergens across all ship surfaces. Not only does this create a cleaner, healthier shipboard environment for guests and crew alike, but this non-toxic, chemical-free system also saves more than one million gallons of water each year in our cleaning procedures, and reduces our carbon footprint as well as the amount of plastic and waste in our supply chain.

Special Offers

SUITE EXCLUSIVES

Spacious living areas and incredible views immerse you in the beauty of your marine surroundings. Our new Suite Exclusives package helps make your voyage all the more memorable. [Learn more](#)

10% OFF BACK-TO-BACK VOYAGES

Save 10% on consecutive departures, applicable on voyage fares only and not valid on extensions or airfare. Valid for new bookings only, subject to availability, and may not be combined with other offers. Call for details.

BRINGING THE KIDS

We believe sharing an expedition with children is a life-enhancing experience. Take \$500 off for each child under the age of 18 on any departure. Not applicable on extensions or airfare. Call for details.

SAVE 5% TRAVELING AS A GROUP

Save 5% when traveling as a group of eight or more people. Valid on voyage fares only and not applicable on extensions or airfare. Deposit, final payments, and cancellation policies for group travel vary from our regular policies. Valid for new bookings only, subject to availability, and may not be combined with other offers. Call for details.

CELEBRATE LIFE'S MILESTONES

Celebrate a milestone with a group of eight or more and enjoy a special amenity package including: 5% savings on voyage fares, custom group photo, US\$150 shipboard credit for the group, and other special gifts. Milestone celebration to be communicated at time

of booking. Valid for new bookings only on select departures, subject to availability, not applicable on airfare or extensions, and may not be combined with other offers. Deposit, final payments, and cancellation policies for group travel vary from our regular policies. Call for details.

COMBINING OFFERS

Certain offers may be combinable, up to two savings opportunities, except where noted otherwise. For example, travel with a group of 8 or more on back-to-back expeditions, and take advantage of both savings.

Included in price

All accommodations aboard ship or in hotels per itinerary; all meals as indicated in the itinerary, both aboard and onshore; beer and wine on all 2023 departures (starting in 2024, spirits and cocktails are also included, with super premium wines and liquors available for purchase); hors d'oeuvres, 24-hour access to snacks, premium coffees and teas, non-alcoholic beverages, and filtered water; excursions and airport transfers to and from recommended flights, as indicated in the itinerary; exploration tools curated to destination, such as Zodiacs, stand-up paddleboards, kayaks; guidance and company of our leading expedition staff; assistance by the Lindblad Expeditions-National Geographic certified photo instructor; access to the OM System Photo Gear Locker; presentations by expedition staff and expert guest speakers; complimentary reusable water bottle; services of a physician, physician's assistant, nurse practitioner, or paramedic; morning stretch classes and 24-hour access to exercise equipment; 24-hour access to lounges, observation decks, library, and other shared spaces; park and site entrance fees, special access permits, and port taxes. Unused services or items included in our programs are non-refundable.

Not included in price

Airfare (except flights when indicated as included); pre- and post-expedition extensions; additional hotel nights (except when indicated as included); crew gratuities; private transfers; laundry, spa treatments, Wi-Fi, and phone services (except when indicated as included); travel protection plans; and passport, visa, and immigration fees.

Travel protection plan

We strongly recommend our guests to take advantage of our Travel Protection Plan. This plan offers comprehensive coverage to protect you from cancellation fees, costs incurred due to trip delays/interruption, damage or loss of baggage, medical assistance, and evacuation during your travels. Our Travel Protection Plan is available for U.S. residents only, and may be purchased any time prior to final payment due date, Travel Protection premiums are non-refundable once plan is purchased. Learn more about our Travel Protection "Plus" Plan: <https://www.expeditions.com/terms-conditions/travel-protection-plan/>

Cancellation policy

Review our cancellation policy: <https://www.expeditions.com/cancellation-policy/>