







Svalbard in Spring: Polar Bears, Arctic Light, and Epic Ice

See Svalbard the way few ever have—in spring. The archipelago will be covered in snow, surrounded by sea ice, and bathed in astonishing light. Stunningly beautiful vistas of snow and ice will be bathed in near-perfect light as the spring sun rises higher in the Arctic sky each day. Scan the icescapes for emerging bears, seals, and other wildlife. Walk on a frozen sea, conditions permitting.

From
\$ 14,276 / per person
Does not include flights

 DATES Apr and May	 DURATION 10 Days
 SHIPS <i>National Geographic Resolution</i>	
 STARTS AT Longyearbyen, Norway	 ENDS AT Longyearbyen, Norway

Highlights

- ★ Be among the few travelers to sail the region at this time of year, exploring aboard the supremely comfortable *National Geographic Resolution*, whose polar-class capabilities allow her to navigate these icy waters
- ★ Experience pristine snow and ice conditions during the early season in Svalbard
- ★ Search for adult male polar bears in their natural habitat, the sea ice
- ★ Walk on the frozen sea in the Arctic, an adventure only possible in early spring





Day by day

DAY 1

Oslo, Norway

Arrive in Oslo and transfer to our centrally located hotel. Our introduction to Norway begins with an afternoon tour of Oslo, including a visit the Fram Museum, dedicated to the wooden ship sailed by Norwegian pole explorers such as Nansen and Amundsen. This evening, join your fellow travelers for a welcome cocktail reception, followed by dinner.

Meals included: lunch, dinner

DAY 2

Oslo / Longyearbyen / Embark Ship

Depart Oslo on a charter flight and enjoy breathtaking vistas enroute to Longyearbyen. On arrival, explore this northern outpost and research center, including the expansive views of the icy fjord and surrounding mountain ranges. Embark the *National Geographic Resolution*, our base of exploration for the coming six days.

Meals included: breakfast, lunch, dinner

DAYS 3-8

Svalbard

By design, our travel in the archipelago is truly exploratory and our exact day-to-day movements will remain flexible, depending on local conditions. Our main focus will be to explore and absorb the stunning early-season ice and dynamic landscapes each day under near-ideal light for photography. Like the icons of this icy realm—the walrus and the polar bear—our movements will be in reaction to the frozen seas and the shifting currents as we search for the creatures who thrive in this wintry wilderness. The polar bears will be returning to the spring ice floes where the seals are pupping, and

our experienced staff will be on constant lookout for wildlife sightings. We will use our agile Zodiac fleet to cruise among the small ice floes and icebergs and maybe even set foot on the frozen ocean (only possible in the early season). The Arctic light at this time of year is exceptional and ever-changing and we will have the rare opportunity to witness it; we will chase the light with a National Geographic photography expert guiding us to assist in capturing the best photographs.

Meals included: breakfast, lunch, dinner

DAYS 9-10

Longyearbyen / Disembark Ship / Oslo

Disembark in Longyearbyen and soak in the atmosphere of this exploration outpost once again before transferring to the airport. Fly back to Oslo and overnight at the Radisson Blu Airport Hotel. The next day, walk across the street to the airport for flights home. Breakfast, lunch, and dinner are provided on Day 9; breakfast is provided on Day 10.

Expedition

Longyearbyen, Norway → Longyearbyen, Norway

2025 Departure Dates

Aboard *National Geographic Resolution*

29 Apr		
06 May		



National Geographic Resolution

Guests

138

Cabins

76

**The sister ship to *National Geographic Endurance*,
she explores polar & temperate regions**

Our second new polar build, *National Geographic Resolution*, is named to honor the second voyage of the legendary Captain James Cook.

A fully-stabilized vessel of the highest ice class (PC5 Category A), she will enable adventurous guests to go where few have or can. *Resolution's* most striking exterior feature is her distinctive profile, the patented X-Bow®, a game-changing design that guarantees the smoothest, most comfortable ride in all kinds of conditions; and since it eliminates bow impact, a quieter ride, as well.

An equally impressive feature may well be her capacity: she carries just 138 guests, a commitment to expedition excellence over scale. Scandinavian-inflected, luxuriously appointed, her inviting interiors would be a destination in themselves. Because she is a Lindblad expedition ship, however, her attention is focused on the world outside— with acres of window glass to keep you connected to the stunning views beyond the pane, and a fleet of expedition tools to get you out exploring.

National Geographic Endurance and *National Geographic Resolution* are next-generation expedition ships. Purpose-built for polar navigation. Fully stabilized, highly strengthened, ice-class Polar Code PC5 (Category A) vessels, they are designed to navigate polar passages year-round, and safely explore uncharted waters, while providing exceptional comfort. The patented X-bow[®] is key to their design; its powerful wave-slicing action provides an extremely smooth ride even in adverse conditions, and even reduces spray on deck for superior observation. They carry a full suite of expedition tools, and offer a variety of experience enhancing amenities.



Cabin Categories

Category 1

Fore Deck: #406, 408, 411, 413, 415

Fore Deck, with two large windows, two singles that can convert to a queen, armchair, writing desk and chair, two bedside tables, window sofa, and a closet.



Category 2

Fore Deck: #410, 412, 414, 416-419, 421-427

Fore Deck, with two large windows, two single beds that can convert to a queen, window sofa, 2 seat sofa, coffee table, armchair, writing desk with an office chair, two bedside tables, and a closet.



Category 3

Main Deck: #512-524

Suite with balcony that features two balcony chairs, hammock, and a table; two single beds that convert to a queen, convertible sleeper sofa, writing desk with a chair, two bedside tables, and a closet.



Category 4

Lounge Deck: #608, 610, 612, 613-623

Suite with balcony that features two balcony chairs, hammock, and a table; two single beds that convert to a queen, convertible sleeper sofa, writing desk with a chair, two bedside tables, and a closet.



Category 5

Bridge Deck: #700-707, 712, 713, 715, 717

Cabin with balcony that features two balcony chairs, hammock, and a table; two single beds that convert to a queen; convertible sleeper sofa; coffee table; writing desk with chair; two bedside tables; and a closet.



Category 6

Bridge Deck: #714

Junior suite with balcony that features two balcony chairs, hammock, and table; two single beds that convert to a queen; pull-out sofa; writing desk with chair; two bedside tables; coffee table; espresso maker; and a closet. Guests receive a welcome amenity, complimentary laundry, priority access to one igloo reservation, and one spa appointment per departure.

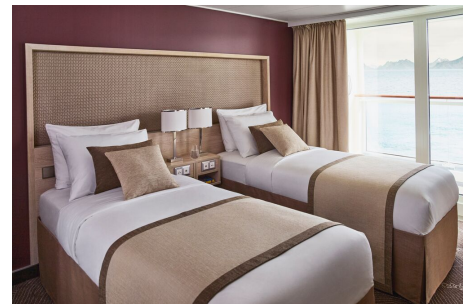

Category 7

Bridge Deck: #708-711, 716, 718, 719, 721

These large balcony suites feature two balcony chairs, hammock, and table; two single beds that can convert to a queen; pull-out sofa; coffee table; writing desk and chair; espresso maker; hammock; and a large walk-in closet with full length mirror. Expanded bathroom has a double vanity, bathtub, towel warmer, and rain shower. Guests receive a welcome amenity, complimentary laundry, priority access to one igloo reservation, and one spa appointment per departure.

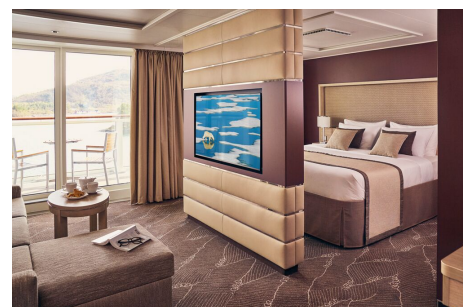

Category A Solo

Main Deck: #504-510, 513

Suite with balcony that features two balcony chairs and a table; single bed, writing desk with an office chair, bedside table, and a closet.



Category B Solo

Lounge Deck: #604-607, 609, 611

Suite with balcony that features two balcony chairs, hammock, and a table; single bed, bedside table, writing desk with chair, hammock, and a closet.



Observation Deck

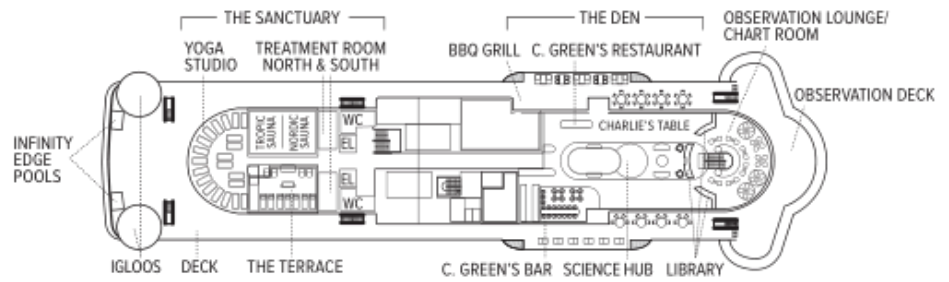

Bridge Deck

- Category 5
- Category 6
- Category 7

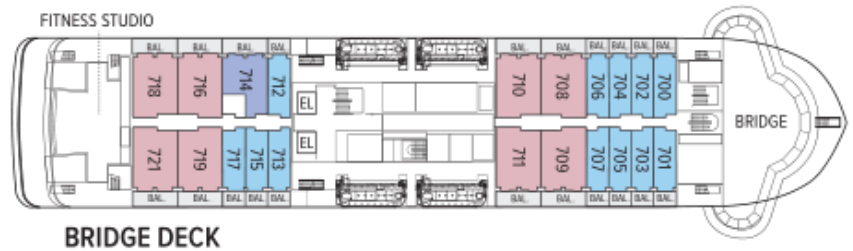

Lounge Deck

- Category 4
- Category B Solo

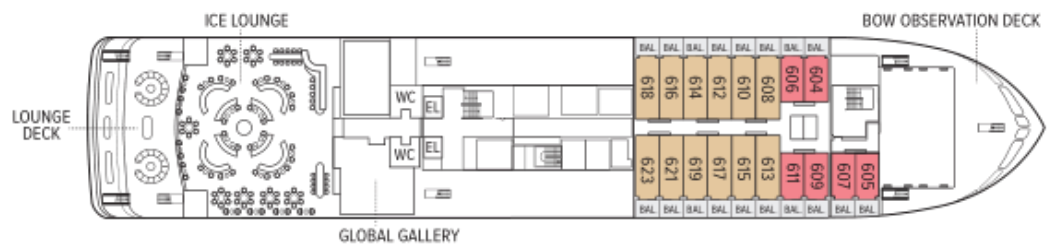

Main Deck

- Category 3
- Category 2 Solo



Fore Deck

- Category 1
- Category 2



Expedition Deck

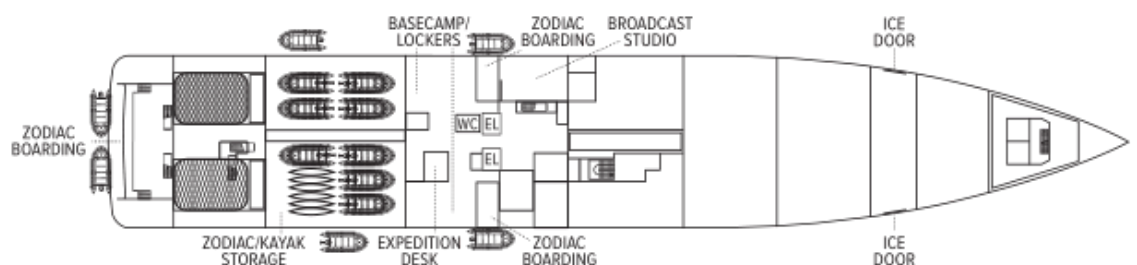

Ship amenities

Public Areas

Reception; three dining areas; an observation lounge with bar, gym, wellness area, infinity-style outdoor hot tubs with adjacent igloos; library; main lounge with full service bar, 24-hour beverage station, state-of-the-art tech for films/presentations; B&H Photo locker and a photo workshop area; science hub; an onboard broadcast studio; an expedition base with lockers for expedition gear; and open access to the Bridge, Captain, officers and on-duty wildlife spotters.

Meals

Restaurant 270° features wrap-around views; two other dining areas offer lighter, made-to-order fare or intimate, small group dinners. All feature sustainable choices, local where possible, and unassigned, flexible, inclusive seating.

Cabins

All cabins face outside with large windows, private bathroom, and climate controls. Cabins are equipped with expedition command centers with iPad tablets, multiple electrical and USB outlets, TVs, with on demand entertainment, phone, Wi-Fi, clock, barometers, hygrometers, vanity mirror, mini refrigerator, small safe, ice bucket, glasses, hair dryer, reading lights and National Geographic Atlas. Luxury linens and pillows. Bathrooms outfitted with Rain showers & hand held shower, botanically inspired shampoo, conditioner, shower gel and lotion. Complimentary insulated water bottles. Balcony cabins have hammocks, chairs and table.

Expedition Equipment

Zodiac landing craft, kayaks, snowshoes, cross-country skis, an ROV and underwater video camera for unique access to the polar undersea, hydrophone, aerial remote-controlled camera and video microscope.

Special Features

A full-time doctor, undersea specialist, National Geographic photographer, Lindblad-National Geographic certified photo instructor and video chronicler, an internet cafe and laundry. A forward and aft staircase, and elevators, reach all decks. Echoing the pioneering installation aboard *National Geographic Endurance*, artist Zaria Forman has curated a new exhibit, featuring a wide range of artists.



Wellness

A glass-enclosed yoga studio, gym, treatment rooms and spa relax area, and high and low-heat saunas with ocean views, staffed by wellness specialists.

Self-Disinfecting Ships

ACT Clean Coat™ is a light-activated, self-disinfecting cleaning process that continuously breaks down viruses, bacteria, mold, and airborne allergens across all ship surfaces. Not only does this create a cleaner, healthier shipboard environment for guests and crew alike, but this non-toxic, chemical-free system also saves more than one million gallons of water each year in our cleaning procedures, and reduces our carbon footprint as well as the amount of plastic and waste in our supply chain.

Special Offers

SUITE EXCLUSIVES

Spacious living areas and incredible views immerse you in the beauty of your marine surroundings. Our new Suite Exclusives package helps make your voyage all the more memorable. [Learn more](#)

10% OFF BACK-TO-BACK VOYAGES

Save 10% on consecutive departures, applicable on voyage fares only and not valid on extensions or airfare. Valid for new bookings only, subject to availability, and may not be combined with other offers. Call for details.

SAVE 5% TRAVELING AS A GROUP

Save 5% when traveling as a group of eight or more people. Valid on voyage fares only and not applicable on extensions or airfare. Deposit, final payments, and cancellation policies for group travel vary from our regular policies. Valid for new bookings only, subject to availability, and may not be combined with other offers. Call for details.

BRINGING THE KIDS

We believe sharing an expedition with children is a life-enhancing experience. Take \$500 off for each child under the age of 18 on any departure. Not applicable on extensions or airfare. Call for details.

CELEBRATE LIFE'S MILESTONES

Celebrate a milestone with a group of eight or more and enjoy a special amenity package including: 5% savings on voyage fares, custom group photo, US\$150 shipboard credit for the group, and other special gifts. Milestone celebration to be communicated at time

of booking. Valid for new bookings only on select departures, subject to availability, not applicable on airfare or extensions, and may not be combined with other offers. Deposit, final payments, and cancellation policies for group travel vary from our regular policies. Call for details.

COMBINING OFFERS

Certain offers may be combinable, up to two savings opportunities, except where noted otherwise. For example, travel with a group of 8 or more on back-to-back expeditions, and take advantage of both savings.

Included in price

All accommodations aboard ship or in hotels per itinerary or similar; all meals and alcoholic beverages aboard ship (except certain super-premium brands); meals on land as indicated, accompanied by nonalcoholic beverages; tips (including to ship's crew); air transportation where indicated as included; shore excursions; sightseeing and entrance fees; special access permits; transfers to and from designated flights; use of kayaks; taxes and service charges; services of a ship physician and services of our expedition staff. Unused services or items included in our programs are non-refundable.

Not included in price

Air transportation (except where specified as included); charter airfare; extensions; passport; visa; immigration fees; meals not indicated; travel protection plan; and items of a personal nature, such as internet access and laundry.

Travel protection plan

We strongly recommend our guests to take advantage of our Travel Protection Plan. This plan offers comprehensive coverage to protect you from cancellation fees, costs incurred due to trip delays/interruption, damage or loss of baggage, medical assistance, and evacuation during your travels. Our Travel Protection Plan is available for U.S. residents only, and may be purchased any time prior to final payment due date, Travel Protection premiums are non-refundable once plan is purchased. Learn more about our Travel Protection "Plus" Plan: <https://www.expeditions.com/terms-conditions/travel-protection-plan/>

Cancellation policy

Review our cancellation policy: <https://www.expeditions.com/cancellation-policy/>