





 Alaska, Japan, Asia & North America
43° 13' N 142° 51' E

A Journey from Nome to Tokyo: Ring of Fire to Ainu Culture

Follow the Pacific’s “Ring of Fire” from Alaska’s volcanic Aleutian Islands to the rugged island of Hokkaido, Japan. Discover the wild, seldom-visited islands of the Bering Sea, encountering millions of seabirds as well as northern fur seals and bears in the Pribilof and Aleutian Islands. View towering volcanic cones in the distance on our way to Hokkaido—home to more than 51 volcanoes. Cap off your voyage with two days in vibrant Tokyo.

From
\$ 31,590 / per person
Does not include flights

	DATES Aug		DURATION 21 Days
	SHIPS <i>National Geographic Resolution</i>		
	STARTS AT Nome, Alaska	→	 ENDS AT Tokyo, Japan

Highlights

- ★ Watch for a profusion of rare wildlife in Alaska’s Pribilof and Aleutian Islands: from whiskered auklets and northern fur seals to Steller’s sea eagles and brown bears
- ★ Search for the sacred red-crowned crane on a visit to the wetlands of Kushiro on Hokkaido
- ★ Learn about the culture of Hokkaido’s indigenous Ainu people on visits to a village and a living history museum
- ★ Delve into the history of the shoguns and samurai while visiting castle ruins in Sendai, and the beautiful Kairakuen Garden in Mito



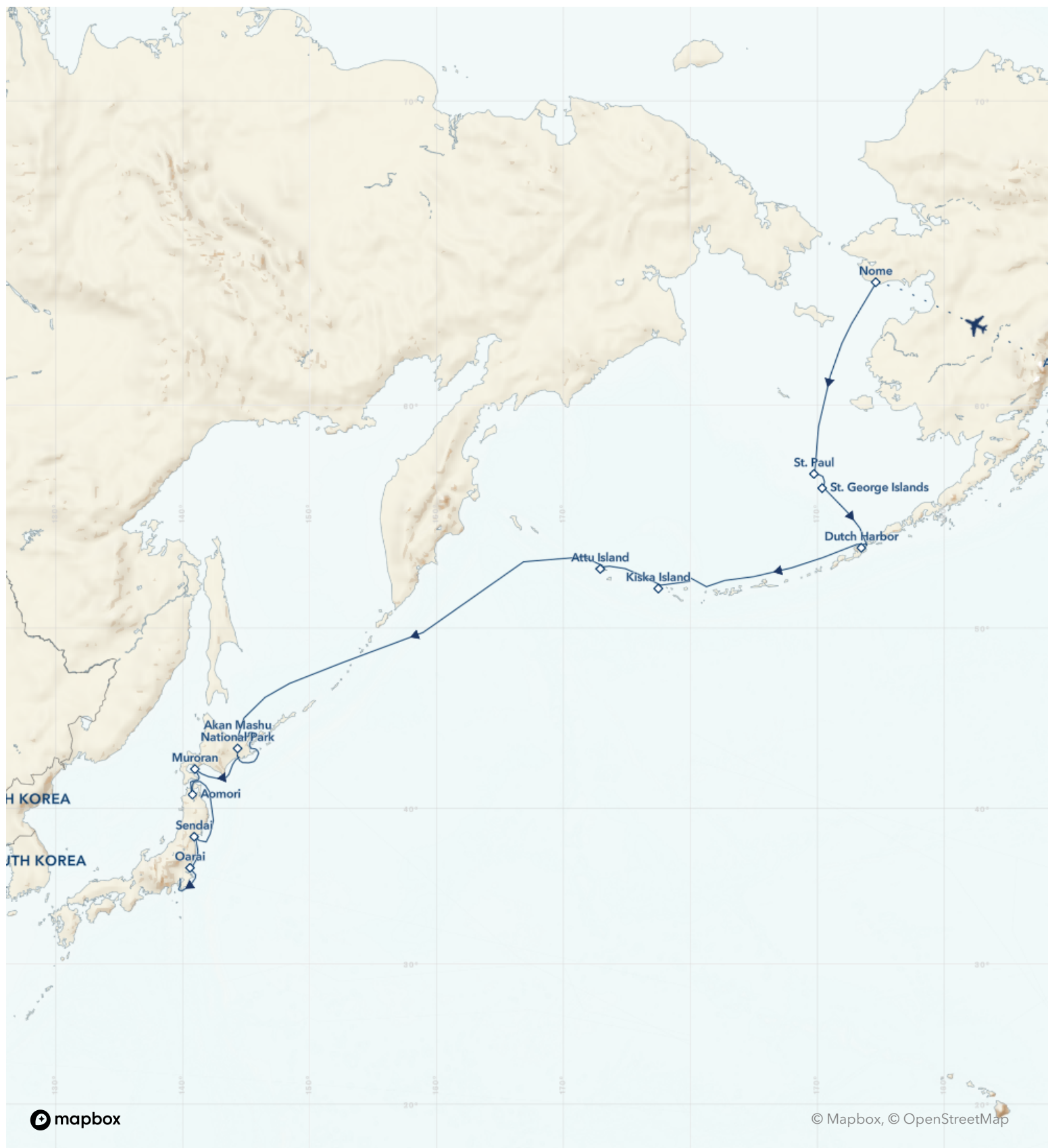

Day by day

DAY 1

Anchorage, Alaska / Nome / Embark Ship

Arrive in Anchorage and fly to Nome, Alaska. Embark *National Geographic Resolution* in the afternoon.

Arrival Time: Arrive before 9:00 a.m. local time.

Arrival City: Anchorage, Alaska

Meals included: dinner

◇ DAYS 2-3

Pribilof Islands / St. Paul and St. George Islands

A naturalist's paradise, the Pribilof Islands welcome three million seabirds and a million marine mammals each summer during the breeding season. Cruise beneath the cliffs of St. George, rocky outcrops that harbor one of the largest seabird colonies in the Northern Hemisphere. Watch for horned and tufted puffins, red-legged kittiwakes, crested auklets, and rare Asian vagrant species seldom seen in North America. Go ashore on St. Paul, home to the majority of the Pribilofs' more than half a million northern fur seals.

Meals included: breakfast, lunch, dinner

◇ DAY 4

Baby Islands / Dutch Harbor

The westernmost tip of the Alaskan mainland gives way to a 1,100-mile-long string of islands that separate the Bering Sea from the northern Pacific: the Aleutian Islands. Begin our exploration of wildlife-rich archipelago at the Baby Islands, east of Unalaska. Here, dynamic tides offer the chance to look for sea otters and fur seals, as well as rare

seabirds. Watch from on deck as the ship navigates Baby Pass, and be on the lookout for the islands' wildlife. Arrive at Dutch Harbor, site of a fierce World War II battle and now one of the world's most important fishing ports.

Meals included: breakfast, lunch, dinner

◇ DAYS 5-8

Exploring the Aleutian Islands

With 69 islands, countless islets, and tens of millions of seabirds, the Aleutians offer much to discover. Spend four days exploring these rugged and remote volcanic islands—some of which still harbor active volcanoes. Learn about the culture of the Aleuts, a fishing and hunting people who have inhabited these islands for millennia. Observe marine mammals such as northern fur seals, Steller sea lions, and a variety of whales, as well as prolific birdlife. When conditions permit, venture out by Zodiac or kayak to explore the wild shores of these islands. Among the islands we visit are Attu and Kiska, both of which were occupied by the Japanese for nearly a year during World War II.

Meals included: breakfast, lunch, dinner

◇ DAYS 9-12

At Sea

As we set a course for Japan, enjoy discussions with our naturalists as they set the stage for our time exploring the northern shores of Hokkaido. Join our naturalists on deck to identify the seabirds that follow us and the volcanic cones in the distance that make up the "Ring of Fire." There are also an array of shipboard activities to enjoy: attend a photo workshop with our National Geographic Photography Expert, treat yourself to a massage or a wellness class, or snuggle up in the library and enjoy a good book. As we make our way to Asia, we lose

a day crossing the International Date Line.

Meals included: breakfast, lunch, dinner

◇ DAY 13

Abashiri, Japan / Shiretoko National Park

Arrive in Abashiri on the island of Hokkaido. After our ship's clearance into Japan, visit the Hokkaido Museum of Northern Peoples, dedicated to the cultures of the indigenous tribes of the Earth's subarctic regions. Later, we venture to Shiretoko—the "end of the Earth" in the native Ainu dialect. One of Japan's most spectacular national parks Shiretoko provides a habitat for numerous species of land and marine mammals, such as brown bears, Steller sea lions, and sperm whales. We are also on the lookout for white-tailed eagles, Blakiston's fish owls, and Steller's sea eagles, which spend the winters here.

Meals included: breakfast, lunch, dinner

◇ DAY 14

Kushiro Shitsugen National Park / Akan Mashu National Park

Cruise Hokkaido's northeastern coast to Kushiro and head inland to explore Kushiro Shitsugen National Park, Japan's largest wetland and home to the endangered red-crowned crane, which was thought to be extinct in the early 20th century. Then drive to Akan Mashu National Park, known for its ethereal, mist-shrouded lakes, where we delve into forests of Sakhalin spruce and visit a charming Ainu village.

Meals included: breakfast, lunch, dinner

◇ DAY 15

Muroran

Dock at Muroran and choose to drive to Shikotsu-Tōya National Park, filled with mirror-like lakes and forest-covered hills set against the

silhouette of the snowcapped Mount Yotei stratovolcano. Alternatively, drive to the lush town of Shiraoi to visit the newly opened National Ainu Museum and Park, an open-air museum where visitors can experience various elements of Ainu culture.

Meals included: breakfast, lunch, dinner

◇ DAY 16

Aomori

Our first call on the northern coast of Japan's main island of Honshu is Aomori City. With the Hakkoda mountains in the distance, this bountiful countryside is famous for apple orchards, world famous seafood, local treasures of Tsugaru lacquerware and painted kites, and one of the four Japanese UNESCO World Heritage sites—Shirakami Sanchi and its primeval beech trees. We will explore this magical blend of historic temples, fresh cuisine and natural wonder.

Meals included: breakfast, lunch, dinner

◇ DAY 17

Sendai

Nestled between mountains and sea, Sendai's lush greenery earned it the nickname of "Forest City." As we tour this beautiful city, we wind our way to the hills above town to the site of Sendai Castle. Built in 1600 by the powerful feudal lord, Date Masamune, the castle has survived anti-feudal warfare, bombings of World War II and the powerful earthquake of 2011. Continue on to Zuihoden, the mausoleum of the Date clan, whose spectacular grounds and intricate design pay tribute to the powerful Masamune and his descendants. Just outside of the city, explore the secluded bay on the shores of Matsushima. Known as one of Japan's three most scenic views, this gorgeous bay is dotted with pine-clad islets.

Meals included: breakfast, lunch, dinner

◇ DAY 18

Oarai / Mito City

Today long stretches of white sand beaches welcome us to the seaside city of Oarai. Heading inland we visit Mito, a power base during the Edo period and best known today for Kairakuen Garden, considered one of Japan's three finest landscape gardens. Originally created in 1841 for the ruling lord, the park was also intended for the enjoyment of all. Paths wind through 3,000 plum trees, cedar woods, and a bamboo grove. Learn about the treasures of the Samurai that went beyond swords and armor. The Tokugawa Museum houses exhibits chronicling the life of the powerful Tokugawa family, as well as those who lived under their rule.

Meals included: breakfast, lunch, dinner

Departure City: Tokyo, Japan

Meals included: breakfast

◇ DAYS 19-20

Tokyo / Disembark Ship

Today we disembark in the vibrant city of Tokyo. For the next two days we'll explore both the ultra-modern and storied past of this amazing city. Visit the serene Meiji Jingu shrine, dedicated to the spirit of Emperor Meiji, who ruled over Japan from 1867 to 1912 and helped transform the country into a modern power. At the Edo-Tokyo Museum, learn about the Tokugawa shogunate, the powerful military government that preceded the Meiji era. Delve into the bustling lanes of the Asakusa district and visit the iconic Sensoji temple, Tokyo's oldest Buddhist temple.

Meals included: breakfast, lunch, dinner

■ DAY 21

Tokyo

After breakfast, depart for the airport to connect to your flight home.

Departure Time: Depart after 11:00 a.m. local time.

Expedition

Nome, Alaska → Tokyo, Japan

2024 Departure Dates

Aboard *National Geographic Resolution*

13 Aug		
--------	--	--



National Geographic Resolution

Guests

138

Cabins

76

**The sister ship to *National Geographic Endurance*,
she explores polar & temperate regions**

Our second new polar build, *National Geographic Resolution*, is named to honor the second voyage of the legendary Captain James Cook.

A fully-stabilized vessel of the highest ice class (PC5 Category A), she will enable adventurous guests to go where few have or can. *Resolution's* most striking exterior feature is her distinctive profile, the patented X-Bow®, a game-changing design that guarantees the smoothest, most comfortable ride in all kinds of conditions; and since it eliminates bow impact, a quieter ride, as well.

An equally impressive feature may well be her capacity: she carries just 138 guests, a commitment to expedition excellence over scale. Scandinavian-inflected, luxuriously appointed, her inviting interiors would be a destination in themselves. Because she is a Lindblad expedition ship, however, her attention is focused on the world outside— with acres of window glass to keep you connected to the stunning views beyond the pane, and a fleet of expedition tools to get you out exploring.

National Geographic Endurance and *National Geographic Resolution* are next-generation expedition ships. Purpose-built for polar navigation. Fully stabilized, highly strengthened, ice-class Polar Code PC5 (Category A) vessels, they are designed to navigate polar passages year-round, and safely explore uncharted waters, while providing exceptional comfort. The patented X-bow[®] is key to their design; its powerful wave-slicing action provides an extremely smooth ride even in adverse conditions, and even reduces spray on deck for superior observation. They carry a full suite of expedition tools, and offer a variety of experience enhancing amenities.



Cabin Categories

Category 1

Fore Deck: #406, 408, 411, 413, 415

Fore Deck, with two large windows, two singles that can convert to a queen, armchair, writing desk and chair, two bedside tables, window sofa, and a closet.



Category 2

Fore Deck: #410, 412, 414, 416-419, 421-427

Fore Deck, with two large windows, two single beds that can convert to a queen, window sofa, 2 seat sofa, coffee table, armchair, writing desk with an office chair, two bedside tables, and a closet.



Category 3

Main Deck: #512-524

Suite with balcony that features two balcony chairs, hammock, and a table; two single beds that convert to a queen, convertible sleeper sofa, writing desk with a chair, two bedside tables, and a closet.



Category 4

Lounge Deck: #608, 610, 612, 613-623

Suite with balcony that features two balcony chairs, hammock, and a table; two single beds that convert to a queen, convertible sleeper sofa, writing desk with a chair, two bedside tables, and a closet.



Category 5

Bridge Deck: #700-707, 712, 713, 715, 717

Cabin with balcony that features two balcony chairs, hammock, and a table; two single beds that convert to a queen; convertible sleeper sofa; coffee table; writing desk with chair; two bedside tables; and a closet.



Category 6

Bridge Deck: #714

Junior suite with balcony that features two balcony chairs, hammock, and table; two single beds that convert to a queen; pull-out sofa; writing desk with chair; two bedside tables; coffee table; espresso maker; and a closet. Guests receive a welcome amenity, complimentary laundry, priority access to one igloo reservation, and one spa appointment per departure.

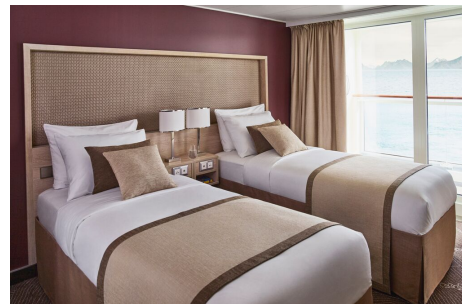

Category 7

Bridge Deck: #708-711, 716, 718, 719, 721

These large balcony suites feature two balcony chairs, hammock, and table; two single beds that can convert to a queen; pull-out sofa; coffee table; writing desk and chair; espresso maker; hammock; and a large walk-in closet with full length mirror. Expanded bathroom has a double vanity, bathtub, towel warmer, and rain shower. Guests receive a welcome amenity, complimentary laundry, priority access to one igloo reservation, and one spa appointment per departure.



Category A Solo

Main Deck: #504-510, 513

Suite with balcony that features two balcony chairs and a table; single bed, writing desk with an office chair, bedside table, and a closet.



Category B Solo

Lounge Deck: #604-607, 609, 611

Suite with balcony that features two balcony chairs, hammock, and a table; single bed, bedside table, writing desk with chair, hammock, and a closet.



Observation Deck

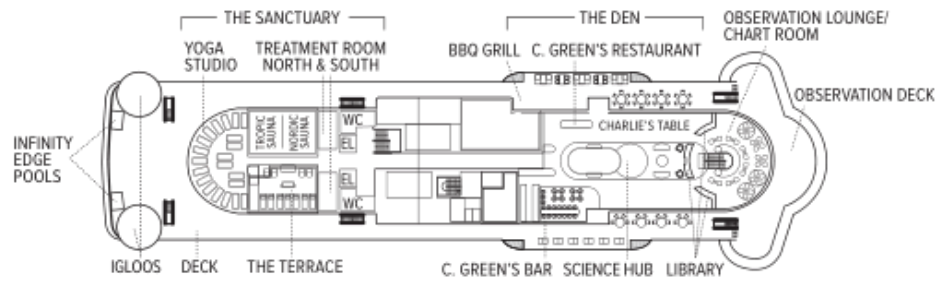

Bridge Deck

- Category 5
- Category 6
- Category 7

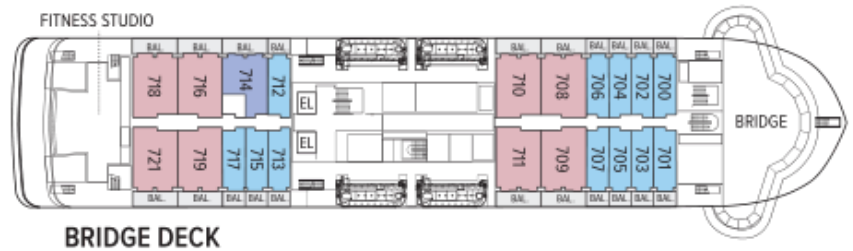

Lounge Deck

- Category 4
- Category B Solo



Main Deck

- Category 3
- Category 2 Solo



Fore Deck

- Category 1
- Category 2



Expedition Deck

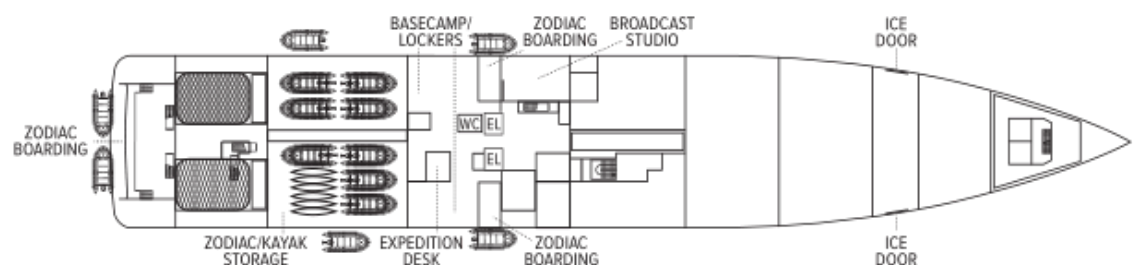

Ship amenities

Public Areas

Reception; three dining areas; an observation lounge with bar, gym, wellness area, infinity-style outdoor hot tubs with adjacent igloos; library; main lounge with full service bar, 24-hour beverage station, state-of-the-art tech for films/presentations; B&H Photo locker and a photo workshop area; science hub; an onboard broadcast studio; an expedition base with lockers for expedition gear; and open access to the Bridge, Captain, officers and on-duty wildlife spotters.

Meals

Restaurant 270° features wrap-around views; two other dining areas offer lighter, made-to-order fare or intimate, small group dinners. All feature sustainable choices, local where possible, and unassigned, flexible, inclusive seating.

Cabins

All cabins face outside with large windows, private bathroom, and climate controls. Cabins are equipped with expedition command centers with iPad tablets, multiple electrical and USB outlets, TVs, with on demand entertainment, phone, Wi-Fi, clock, barometers, hygrometers, vanity mirror, mini refrigerator, small safe, ice bucket, glasses, hair dryer, reading lights and National Geographic Atlas. Luxury linens and pillows. Bathrooms outfitted with Rain showers & hand held shower, botanically inspired shampoo, conditioner, shower gel and lotion. Complimentary insulated water bottles. Balcony cabins have hammocks, chairs and table.

Expedition Equipment

Zodiac landing craft, kayaks, snowshoes, cross-country skis, an ROV and underwater video camera for unique access to the polar undersea, hydrophone, aerial remote-controlled camera and video microscope.

Special Features

A full-time doctor, undersea specialist, National Geographic photographer, Lindblad-National Geographic certified photo instructor and video chronicler, an internet cafe and laundry. A forward and aft staircase, and elevators, reach all decks. Echoing the pioneering installation aboard *National Geographic Endurance*, artist Zaria Forman has curated a new exhibit, featuring a wide range of artists.



Wellness

A glass-enclosed yoga studio, gym, treatment rooms and spa relax area, and high and low-heat saunas with ocean views, staffed by wellness specialists.

Self-Disinfecting Ships

ACT Clean Coat™ is a light-activated, self-disinfecting cleaning process that continuously breaks down viruses, bacteria, mold, and airborne allergens across all ship surfaces. Not only does this create a cleaner, healthier shipboard environment for guests and crew alike, but this non-toxic, chemical-free system also saves more than one million gallons of water each year in our cleaning procedures, and reduces our carbon footprint as well as the amount of plastic and waste in our supply chain.

Special Offers

SUITE EXCLUSIVES

Spacious living areas and incredible views immerse you in the beauty of your marine surroundings. Our new Suite Exclusives package helps make your voyage all the more memorable. [Learn more](#)

CELEBRATE LIFE'S MILESTONES

Celebrate a milestone with a group of eight or more and enjoy a special amenity package including: 5% savings on voyage fares, custom group photo, US\$150 shipboard credit for the group, and other special gifts. Milestone celebration to be communicated at time of booking. Valid for new bookings only on select departures, subject to availability, not applicable on airfare or extensions, and may not be combined with other offers. Deposit, final payments, and cancellation policies for group travel vary from our regular policies. Call for details.

10% OFF BACK-TO-BACK VOYAGES

Save 10% on consecutive departures, applicable on voyage fares only and not valid on extensions or airfare. Valid for new bookings only, subject to availability, and may not be combined with other offers. Call for details.

BRINGING THE KIDS

We believe sharing an expedition with children is a life-enhancing experience. Take \$500 off for each child under the age of 18 on any departure. Not applicable on extensions or airfare. Call for details.

SAVE 5% TRAVELING AS A GROUP

Save 5% when traveling as a group of eight or more

people. Valid on voyage fares only and not applicable on extensions or airfare. Deposit, final payments, and cancellation policies for group travel vary from our regular policies. Valid for new bookings only, subject to availability, and may not be combined with other offers. Call for details.

COMBINING OFFERS

Certain offers may be combinable, up to two savings opportunities, except where noted otherwise. For example, travel with a group of 8 or more on back-to-back expeditions, and take advantage of both savings.

Included in price

All accommodations aboard ship or in hotels per itinerary; all meals as indicated in the itinerary, both aboard and onshore; beer, wine, cocktails, and spirits aboard the ship (except certain super premium brands which are available for purchase); hors d'oeuvres, 24-hour access to snacks, premium coffees and teas, non-alcoholic beverages, and filtered water; excursions and airport transfers to and from recommended flights, as indicated in the itinerary; crew gratuities; exploration tools curated to destination, such as Zodiacs and kayaks; guidance and company of our leading expedition staff; assistance by the National Geographic Photography Expert and Lindblad Expeditions-National Geographic certified photo instructor; access to the OM System Photo Gear Locker; presentations by expedition staff and expert guest speakers; complimentary reusable water bottle; services of a physician, physician's assistant, nurse practitioner, or paramedic; morning stretch classes and 24-hour access to exercise equipment; 24-hour access to lounges, observation decks, library, and other shared spaces; park and site entrance fees, special access permits, and port taxes. Unused services or items included in our programs are non-refundable.

Not included in price

Airfare (except flights when indicated as included); pre- and post-expedition extensions; additional hotel nights (except when indicated as included); private transfers; laundry, spa treatments, Wi-Fi, and phone services (except when indicated as included); travel protection plans; and passport, visa, and immigration fees.

Travel protection plan

We strongly recommend our guests to take advantage of our Travel Protection Plan. This plan offers comprehensive coverage to protect you from cancellation fees, costs incurred due to trip delays/interruption, damage or loss of baggage, medical assistance, and evacuation during your travels. Our Travel Protection Plan is available for U.S. residents only, and may be purchased any time prior to final payment due date, Travel Protection premiums are non-refundable once plan is purchased. Learn more about our Travel Protection "Plus" Plan: <https://www.expeditions.com/terms-conditions/travel-protection-plan/>

Cancellation policy

Review our cancellation policy: <https://www.expeditions.com/cancellation-policy/>