



Arctic, New and Noteworthy & Europe
78° 13' N 15° 37' E

Norwegian Discovery: Svalbard and the Northern Fjords

From the remarkable wilderness of the high Arctic to the fabled fjords of Norway, explore two distinct but intertwined regions. Spend several days amid the ice floes and islands of Svalbard in search of the polar bear, plus see walruses, seals, and myriad seabirds. Kayak, Zodiac cruise, and go ashore to hike. Then head south to the indented coastline of Norway, where nature flourishes.

From

\$ 16,726 / per person
Does not include flights



DATES

Jun



DURATION

12 Days



SHIPS

National Geographic Endurance



STARTS AT

Longyearbyen, →
Svalbard
(Norway)



ENDS AT

Tromsø,
Norway

Highlights

- ★ Sail to the high Arctic archipelago of Svalbard under the midnight sun in search of polar bears hunting along the pack ice
- ★ Zodiac cruise along the towering cliffs of Bear Island that rise straight from the sea and are home to tens of thousands of raucous seabirds
- ★ On Senja Island visit pristine Ånderdalen National Park to search for reindeer, elk, red foxes, and more
- ★ Explore the lovely fjords of Sørøya by Zodiac and kayak, and hike on shore





Day by day

■ DAY 1

Oslo, Norway

Arrive in Oslo, and transfer to our centrally located hotel. After lunch, our introduction to Norway begins with a tour of Oslo, including a visit to the Fram Museum, dedicated to the wooden ship sailed by Norwegian pole explorers such as Nansen and Amundsen. This evening, join your fellow travelers for a welcome cocktail reception, followed by dinner.

Meals included: lunch

◇ DAY 2

Oslo / Longyearbyen / Embark Ship

Depart Oslo on a charter flight and enjoy breathtaking vistas over icy fjords and the Barents Sea enroute to Longyearbyen. On arrival to this Arctic outpost, explore the world's northernmost settlement, which has morphed from a coal mining hub to a base for exploration and science in recent history. Witness daily life and delve into this history before embarking the ship.

Meals included: breakfast, lunch, dinner

◇ DAYS 3-8

Exploring Svalbard

We operate in true expedition style, letting nature dictate our day-to-day movements within an immense Arctic wonderland. Our fully stabilized, ice-class expedition ship probes deep into the ice where the polar bears forage, walrus sun themselves, and the Svalbard reindeer roam. Join our spotters on the Bridge as we scan the floes and islands for these iconic creatures, along with bearded and ringed seals; Arctic fox; and whales that call these waters home, like beluga, fin, and minke. There's no greater thrill than a sighting that

brings everyone rushing to the bow or Bridge for a close-up view.

Sail deep into protected bays and fjords, where even a novice kayaker can comfortably paddle surrounded by sparkling bergs and dramatic mountains. Video from our Remotely Operated Vehicle (ROV) allows you to peer into the mysterious world that exists 1,000 feet below us during Recaps with our multi-talented field staff.

Meals included: breakfast, lunch, dinner

◇ DAY 9

Bear Island (Bjørnøya)

Sitting at the confluence of the Norwegian and Barents Seas, Bear Island is ironically known as a birdwatcher's paradise. The island also houses one remote meteorological station. With conditions permitting, enjoy a Zodiac cruise around the southernmost member of the Svalbard archipelago and revel at the bird cliffs, home to countless thousands of fulmars, kittiwakes, and guillemots.

Meals included: breakfast, lunch, dinner

◇ DAYS 10-11

Sørøya and Senja Islands

Off Norway's coast, two of its largest islands offer stunning landscapes, challenging and rewarding hikes, and protected fjords to explore. The mountainous island of Sørøya, known for its scenic bays, pristine nature reserves, and large populations of *skrei*, or cod, welcomes us to its shores as we make our way south from Bear Island. After exploring this gateway to Finnmark, Norway's northernmost county, we head south to Senja Island. Capture panoramic landscapes along your certified photo instructor, glide amongst islands in a kayak, or explore village streets and shops as we get to know

Norway's second-largest island.

Meals included: breakfast, lunch, dinner

■ DAY 12

Tromsø / Disembark Ship

Disembark our ship in Tromsø and transfer to the airport for flights home.

Meals included: breakfast

Expedition

Longyearbyen, Svalbard (Norway) → Tromsø,
Norway

2024 Departure Dates

Aboard *National Geographic Endurance*

13 Jun		
--------	--	--

2025 Departure Dates

Aboard *National Geographic Endurance*

14 Jun		
--------	--	--



National Geographic Endurance

Guests	Cabins
138	76

The most advanced ice-class expedition ship afloat, the *National Geographic Endurance* offers unprecedented access to polar regions.

The first new polar build in Lindblad's 50-year history, *National Geographic Endurance* is named to honor explorer Ernest Shackleton and his legendary Transantarctic Expedition.

A fully-stabilized vessel of the highest ice class (PC5 Category A), she will enable adventurous guests to go where few have or can. Endurance's most striking exterior feature is her distinctive profile, the patented X-Bow®, a game-changing design that guarantees the smoothest, most comfortable ride in all kinds of conditions; and since it eliminates bow impact, a quieter ride, as well.

An equally impressive feature may well be her capacity: she carries just 138 guests, a commitment to expedition excellence over scale. Scandinavian-inflected, luxuriously appointed, her inviting interiors would be a destination in themselves. Because she is a Lindblad expedition ship, however, her attention is focused on the world outside—with acres of window glass to keep you connected to the stunning views beyond the pane, and a fleet of expedition tools to get you out exploring.

National Geographic Endurance and *National Geographic Resolution* are next-generation expedition ships. Purpose-built for polar navigation. Fully stabilized, highly strengthened, ice-class Polar Code PC5 (Category A) vessels, they are designed to navigate polar passages year-round, and safely explore uncharted waters, while providing exceptional comfort. The patented X-bow[®] is key to their design; its powerful wave-slicing action provides an extremely smooth ride even in adverse conditions, and even reduces spray on deck for superior observation. They carry a full suite of expedition tools, and offer a variety of experience enhancing amenities.



Cabin Categories

Category 1

Fore Deck: #406, 408, 411, 413, 415

Fore Deck, with two large windows, two singles that can convert to a queen, armchair, writing desk and chair, two bedside tables, window sofa, and a closet.



Category 2

Fore Deck: #410, 412, 414, 416-419, 421-427

Fore Deck, with two large windows, two single beds that can convert to a queen, window sofa, 2 seat sofa, coffee table, armchair, writing desk with an office chair, two bedside tables, and a closet.



Category 3

Main Deck: #512-524

Suite with balcony that features two balcony chairs, hammock, and a table; two single beds that convert to a queen, convertible sleeper sofa, writing desk with a chair, two bedside tables, and a closet.



Category 4

Lounge Deck: #608, 610, 612, 613-623

Suite with balcony that features two balcony chairs, hammock, and a table; two single beds that convert to a queen, convertible sleeper sofa, writing desk with a chair, two bedside tables, and a closet.



Category 5

Bridge Deck: #700-707, 712, 713, 715, 717

Cabin with balcony that features two balcony chairs, hammock, and a table; two single beds that convert to a queen; convertible sleeper sofa; coffee table; writing desk with chair; two bedside tables; and a closet.



Category 6

Bridge Deck: #714

Junior suite with balcony that features two balcony chairs, hammock, and table; two single beds that convert to a queen; pull-out sofa; writing desk with chair; two bedside tables; coffee table; espresso maker; and a closet. Guests receive a welcome amenity, complimentary laundry, priority access to one igloo reservation, and one spa appointment per departure.



Category 7

Bridge Deck: #708-711, 716, 718, 719, 721

These large balcony suites feature two balcony chairs, hammock, and table; two single beds that can convert to a queen; pull-out sofa; coffee table; writing desk and chair; espresso maker; hammock; and a large walk-in closet with full length mirror. Expanded bathroom has a double vanity, bathtub, towel warmer, and rain shower. Guests receive a welcome amenity, complimentary laundry, priority access to one igloo reservation, and one spa appointment per departure.



Category A Solo

Main Deck: #504-510, 513

Suite with balcony that features two balcony chairs and a table; single bed, writing desk with an office chair, bedside table, and a closet.



Category B Solo

Lounge Deck: #604-607, 609, 611

Suite with balcony that features two balcony chairs, hammock, and a table; single bed, bedside table, writing desk with chair, hammock, and a closet.



Observation Deck

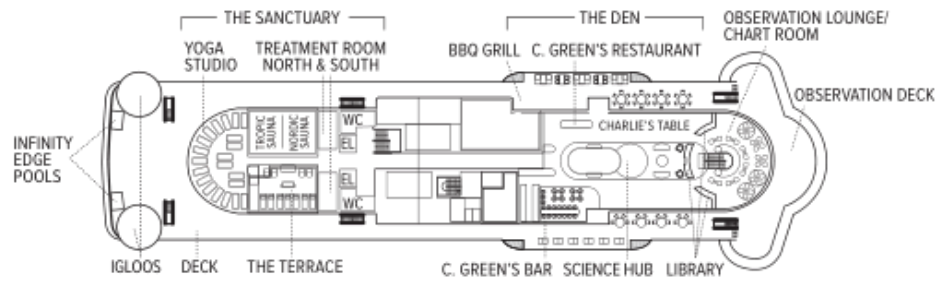

Bridge Deck

- Category 5
- Category 6
- Category 7

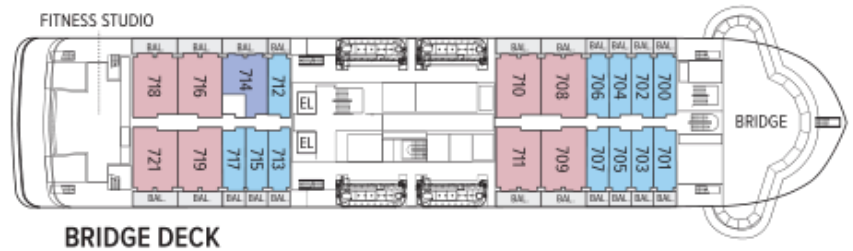

Lounge Deck

- Category 4
- Category B Solo



Main Deck

- Category 3
- Category 2 Solo



Fore Deck

- Category 1
- Category 2



Expedition Deck

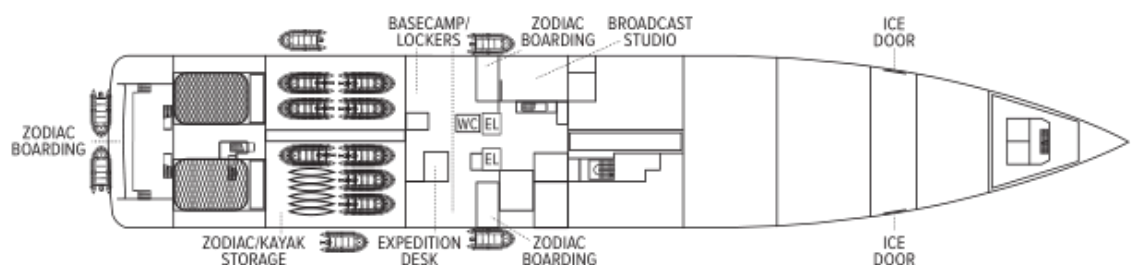

Ship amenities

Public Areas

Reception; three dining areas; an observation lounge with bar, gym, wellness area, infinity-style outdoor hot tubs with adjacent igloos; library; main lounge with full service bar, 24-hour beverage station, state-of-the-art tech for films/presentations; B&H Photo locker and a photo workshop area; science hub; an onboard broadcast studio; an expedition base with lockers for expedition gear; and open access to the Bridge, Captain, officers and on-duty wildlife spotters.

Meals

Restaurant 270° features wrap-around views; two other dining areas offer lighter, made-to-order fare or intimate, small group dinners. All feature sustainable choices, local where possible, and unassigned, flexible, inclusive seating.

Cabins

All cabins face outside with large windows, private bathroom, and climate controls. Cabins are equipped with expedition command centers with iPad tablets, multiple electrical and USB outlets, TVs, with on demand entertainment, phone, Wi-Fi, clock, barometers, hygrometers, vanity mirror, mini refrigerator, small safe, ice bucket, glasses, hair dryer, reading lights and National Geographic Atlas. Luxury linens and pillows. Bathrooms outfitted with Rain showers & hand held shower, botanically inspired shampoo, conditioner, shower gel and lotion. Complimentary insulated water bottles. Balcony cabins have hammocks, chairs and table.

Expedition Equipment

Zodiac landing craft, kayaks, snowshoes, cross-country skis, an ROV and underwater video camera for unique access to the polar undersea, hydrophone, aerial remote-controlled camera and video microscope.

Special Features

A full-time doctor, undersea specialist, National Geographic photographer, Lindblad-National Geographic certified photo instructor and video chronicler, an internet cafe and laundry. A forward and aft staircase, and elevators, reach all decks. Echoing the pioneering installation aboard *National Geographic Endurance*, artist Zaria Forman has curated a new exhibit, featuring a wide range of artists.



Wellness

A glass-enclosed yoga studio, gym, treatment rooms and spa relax area, and high and low-heat saunas with ocean views, staffed by wellness specialists.

Self-Disinfecting Ships

ACT Clean Coat™ is a light-activated, self-disinfecting cleaning process that continuously breaks down viruses, bacteria, mold, and airborne allergens across all ship surfaces. Not only does this create a cleaner, healthier shipboard environment for guests and crew alike, but this non-toxic, chemical-free system also saves more than one million gallons of water each year in our cleaning procedures, and reduces our carbon footprint as well as the amount of plastic and waste in our supply chain.

Special Offers

SUITE EXCLUSIVES

Spacious living areas and incredible views immerse you in the beauty of your marine surroundings. Our new Suite Exclusives package helps make your voyage all the more memorable. [Learn more](#)

10% OFF BACK-TO-BACK VOYAGES

Save 10% on consecutive departures, applicable on voyage fares only and not valid on extensions or airfare. Valid for new bookings only, subject to availability, and may not be combined with other offers. Call for details.

BRINGING THE KIDS

We believe sharing an expedition with children is a life-enhancing experience. Take \$500 off for each child under the age of 18 on any departure. Not applicable on extensions or airfare. Call for details.

SAVE 5% TRAVELING AS A GROUP

Save 5% when traveling as a group of eight or more people. Valid on voyage fares only and not applicable on extensions or airfare. Deposit, final payments, and cancellation policies for group travel vary from our regular policies. Valid for new bookings only, subject to availability, and may not be combined with other offers. Call for details.

CELEBRATE LIFE'S MILESTONES

Celebrate a milestone with a group of eight or more and enjoy a special amenity package including: 5% savings on voyage fares, custom group photo, US\$150 shipboard credit for the group, and other special gifts. Milestone celebration to be communicated at time

of booking. Valid for new bookings only on select departures, subject to availability, not applicable on airfare or extensions, and may not be combined with other offers. Deposit, final payments, and cancellation policies for group travel vary from our regular policies. Call for details.

COMBINING OFFERS

Certain offers may be combinable, up to two savings opportunities, except where noted otherwise. For example, travel with a group of 8 or more on back-to-back expeditions, and take advantage of both savings.

Included in price

All accommodations aboard ship or in hotels per itinerary; all meals as indicated in the itinerary, both aboard and onshore; beer, wine, cocktails, and spirits aboard the ship (except certain super premium brands which are available for purchase); hors d'oeuvres, 24-hour access to snacks, premium coffees and teas, non-alcoholic beverages, and filtered water; excursions and airport transfers to and from recommended flights, as indicated in the itinerary; crew gratuities; exploration tools curated to destination, such as Zodiacs, kayaks, guidance and company of our leading expedition staff; assistance by the National Geographic Photography Expert and Lindblad Expeditions-National Geographic certified photo instructor; access to the OM System Photo Gear Locker; presentations by expedition staff and expert guest speakers; complimentary parka or jacket, complimentary reusable water bottle; services of a physician, physician's assistant, nurse practitioner, or paramedic; morning stretch classes and 24-hour access to exercise equipment; 24-hour access to lounges, observation decks, library, and other shared spaces; park and site entrance fees, special access permits, and port taxes. Unused services or items included in our programs are non-refundable.

Not included in price

Airfare (except flights when indicated as included); pre- and post-expedition extensions; additional hotel nights (except when indicated as included); private transfers; laundry, spa treatments, Wi-Fi, and phone services (except when indicated as included); travel protection plans; and passport, visa, and immigration fees.

Travel protection plan

We strongly recommend our guests to take advantage of our Travel Protection Plan. This plan offers comprehensive coverage to protect you from cancellation fees, costs incurred due to trip delays/interruption, damage or loss of baggage, medical assistance, and evacuation during your travels. Our Travel Protection Plan is available for U.S. residents only, and may be purchased any time prior to final payment due date, Travel Protection premiums are non-refundable once plan is purchased. Learn more about our Travel Protection "Plus" Plan: <https://www.expeditions.com/terms-conditions/travel-protection-plan/>

Cancellation policy

Review our cancellation policy: <https://www.expeditions.com/cancellation-policy/>