

# Fabled Lands Of The North: Greenland to Newfoundland

Explore three remarkable regions of the north on a far-ranging expedition through ice-laden waters encompassing Greenland’s spectacular, 100-mile-long Kangerlussuaq Fjord and Ilulissat Icefjord, Nunavut’s Baffin Island, and the wild coastline of Newfoundland and Labrador. Encounter a historic Viking village and the fascinating traditions of local Inuit communities. Hike the tundra in search of caribou and arctic foxes. Kayak and cruise by Zodiac to spot whales, walruses, and polar bears along the rugged shores.

From  
**\$ 19,161** / per person  
Does not include flights

 <b>DATES</b> Aug	 <b>DURATION</b> 16 Days
 <b>SHIPS</b> <i>National Geographic Explorer</i>	
 <b>STARTS AT</b> Nuuk, Greenland	  <b>ENDS AT</b> St. Johns, Newfoundland



## Highlights

- ★ Explore two UNESCO World Heritage sites: glide among soaring icebergs at the mouth of the Ilulissat Icefjord, and walk through the remains of the 11th-century Viking village at L'Anse aux Meadows
- ★ Meet Inuit artisans on Baffin Island and learn about their carving and weaving traditions
- ★ Join our naturalists to search for polar bears, caribou, arctic foxes, humpback and minke whales, walruses, and more in their natural habitat
- ★ Explore the untamed coasts of Newfoundland and Labrador, discovering spectacular fjords and cliffs on foot and by kayak and Zodiac





## Day by day

### ■ DAY 1

#### **Boston, MA**

Arrive in Boston, MA. Check into your hotel in the late afternoon. In the evening, join fellow travelers for a group dinner at the hotel.

Meals included: dinner

### ◇ DAY 2

#### **Boston / Nuuk, Greenland / Embark Ship**

Fly from the U.S. by chartered aircraft to Nuuk, Greenland's thriving capital city. Settle into your cabin and enjoy a scenic sailing out of the Nuuk fjord, and into the open water of the Davis Strait, as we navigate north along the coastline.

Meals included: breakfast, lunch, dinner

### ◇ DAY 3

#### **Greenland's West Coast & Sisimiut**

Dozens of deep fjords carve into Greenland's west coast, many with glaciers fed by the ice sheet that covers about 80 percent of the country. Discover this beautiful and rugged coastline in Zodiacs, keeping an eye out for humpback and minke whales. At Sisimiut, a former whaling port, enjoy a guided walking tour of the colorful wooden buildings that create this tiny hamlet. Visit the museum and discover the tastes of Greenland hosted by a local chef.

Meals included: breakfast, lunch, dinner

### ◇ DAY 4

#### **Disko Bay and Ilulissat**

Sail into Qeqertarsuup Tunua, also known as Disko Bay, to explore the World Heritage site of Ilulissat Icefjord, a tongue of the Greenland ice cap that

extends to the sea. Take an extraordinary small boat cruise with locals among towering icebergs at the mouth of the fjord. Watch for whales along the nutrient-rich edges of the icefjord. Visit the town of Ilulissat and the recently opened Ilulissat Icefjord Centre and/or hike to the archaeological site in Sermermiut, an abandoned valley previously inhabited by several distinct Inuit cultures.

Meals included: breakfast, lunch, dinner

### ◇ DAY 5

#### **At Sea / Davis Strait**

Spend time on the bow of the ship watching for whales, polar bears, and other wildlife; enjoy the ship's amenities; and attend expert-led talks about the Arctic as we navigate the massive icebergs of Davis Strait on the way to Baffin Island.

Meals included: breakfast, lunch, dinner

### ◇ DAY 6

#### **Cumberland Sound, Baffin Island, Canada**

Disembark at the hamlet of Pangnirtung—home to the Inuit for thousands of years—and interact with its thriving community of artists. Visit a craft center to see soapstone carvings, weavings, and prints depicting life in the Arctic. Hike along a riverside trail for sweeping views of Auyuittuq National Park, and discover the remains of a bygone whaling era on uninhabited Kekerten Island.

Meals included: breakfast, lunch, dinner

### ◇ DAYS 7-8

#### **Frobisher Bay, Baffin Island**

Spend two days exploring Frobisher Bay and the islands south of Baffin Island as we make our way south towards the northern tip of Labrador. Hike the



tundra in search of arctic foxes and walruses hauled out on the shore. Set out in pursuit of polar bears, which often find themselves stranded on the Lower Savage Islands and Resolution Island after the pack ice retreats during the summer. Be on the lookout for seabirds and marine mammals during kayak and Zodiac excursions along the coast.

Meals included: breakfast, lunch, dinner

◇ DAYS 9-13

## Exploring the Labrador Coast

Spend five days tracing the beautiful, wild coast of Labrador, exploring on foot and by kayak and Zodiac. Explore the shores throughout Torngat National Park and start to delve into the local Inuit history with our onboard archeologist. Stop at the deserted outpost of Hebron, the peninsula's northernmost settlement, to walk among the historic buildings of the Moravian Mission Station established here in the 1830s. Watch for peregrine falcons and other birds soaring over the rocky shorelines of the spectacularly narrow Mugford Tickle, and take in the impressive sight of the 4,000-foot-high Kaumajet Mountains. Head into the tiny fishing settlement of Indian Harbour to observe vast colonies of common murre along the sea cliffs. Continue to scenic Battle Harbour to discover the reconstructed 19th-century buildings and legacy of this historic fishing village.

Meals included: breakfast, lunch, dinner

◇ DAY 14

## L'Anse aux Meadows

In the 1960s, the remains of a Viking village established in the 11th century were excavated at L'Anse aux Meadows, now a UNESCO World Heritage site. Walk among the Norse ruins and reconstructed sod huts, and learn the saga of the Vikings in North America, who arrived here nearly 500 years before the explorations of Columbus.

Meals included: breakfast, lunch, dinner

◇ DAY 15

## Northern Newfoundland

Cliffs, fjords, and beaches grace the northwestern tip of Newfoundland. Hike, kayak, and explore by Zodiac with our experts amid this stunning scenery and keep an eye out for migrating birds and whales.

Meals included: breakfast, lunch, dinner

■ DAY 16

## St. John's, Newfoundland / Disembark Ship

Today, disembark in St. John's and transfer to the airport for your flight home.

Meals included: breakfast

**2025 Expedition**

Nuuk, Greenland → St. Johns, Newfoundland

**2025 Departure Dates**

Aboard *National Geographic Explorer*

16 Aug

**Alternative Routes**

Visit [Expeditions.com](http://Expeditions.com) for more information.

**2024 Departure Dates**

28 Aug



## ***National Geographic Explorer***

---

**Guests**

148

**Cabins**

81

---

**Built to handle deep swells and towering waves, the *National Geographic Explorer* lends herself to globe-spanning travel and a dedication to curiosity and wonder.**

Originally constructed for service along Norway's coast as part of the famed Hurtigruten, or Coastal Express, she ferried passengers among the fjords of this iconic coast in conditions that could deteriorate into heavy seas in a matter of minutes. She had to be able to handle deep swells and towering waves—and have a high degree of maneuverability. Those traits, and an ideal size, made her a natural choice for addition to the Lindblad fleet.

The plans to completely rebuild her drew on 50 years of pioneering expedition history and expertise. *National Geographic Explorer* was equipped with an ice-strengthened hull and advanced navigation equipment for polar expeditions; a roster of tools for exploration; and a well-appointed interior with vast expanses of glass for an unprecedented connection to the environment. Her interior and exterior design embodied the Lindblad expedition ethos—the privilege of wildness and the luxury of comfort.

For many guests she remains their paradigm of an expedition ship. She is devoted to exploration—from her Welcoming Bridge, and the Chart Room below it where you can tuck in to warm up with a hot chocolate, to her high-perched Observation deck with its aqueous light and compelling 24/7 views. Even the art on the walls— from the Hurley prints of Shackleton’s expedition to the stunning National Geographic photos— tells an uber- narrative of globe-spanning travel and a dedication to curiosity and wonder.

*National Geographic Explorer* is a state-of-the-art expedition ship. She is a fully stabilized, ice-class vessel, with an ice-reinforced hull, enabling her to navigate polar passages while providing exceptional comfort.





# Cabin Categories

## Category 1

**Main Deck: #301-308**

Cabins feature one or two portholes. Most cabins feature two single beds that can be converted to a queen. Cabins #301-306 feature one queen-sized bed. All cabins feature a writing desk, floor length mirror, reading lamps, well-appointed bathrooms with a roomy glass-wall shower, and a TV.



## Category 2

**Main Deck: #317-320, 335-336**

Cabins feature two single beds (some can convert to a queen-sized bed), and one large window. They offer a writing desk, floor length mirror, reading lamps, sitting chair, well-appointed bathrooms with a roomy glass-wall shower, and a TV.



## Category 3

**Main Deck: #313-316, 321-328, 337-340, 342, 344, 348, 350**

Cabins feature two single beds (some can convert to a queen-sized bed), one large window, and two sitting chairs and a small table and ample storage. They have a writing desk, floor length mirror, reading lamps, well-appointed bathrooms with a roomy glass-wall shower, and a TV. Cabins 341 & 343 have a sofa bed for a triple.



## Category 4

**Upper Deck:** #201-202, 204-207, 210, 212, 217, 226, 228

Cabins feature two single beds and at least one large window. All cabins can convert between two single beds to a queen, except Cabins 217, 226 & 228 that feature one queen-size bed only. All cabins feature climate controls, sitting chairs, and a TV. Bathrooms are also generously sized with a roomy glass-walled shower stall.



**Veranda Deck:** #103-104, 107-108

Cabins feature two single beds that can convert into a queen. They have a writing desk, floor length mirror, reading lamps, sitting chair, private bathrooms with a glass-wall shower, and a TV.

## Category 5

**Upper Deck:** #209, 211, 214, 216, 218, 220-222, 224

Cabins feature a balcony with sliding glass doors, one queen-sized bed, writing desk, floor length mirror, reading lamps, private bathrooms with a glass-wall shower, and a TV. (Cabin 221 has two single beds that can convert to a queen.)



## Category 6

**Upper Deck:** #213

This spacious cabin has a private balcony, two single beds that can be converted into a queen, a writing desk, double closet, bookcase, pull-out sofa, armchairs, two large windows, and a TV. The sleeping area has a glass partition separating the living room. Bathrooms are generously sized with a roomy glass-walled shower stall and twin sinks.



**Veranda Deck:** #101-102

These spacious cabins can be converted into triples. They have two single beds that can be converted into a queen, a writing desk, double closet, bookcase, sofa-bed, chairs, two large windows, and a TV. The sleeping area can be closed off with the glass partition. Bathrooms are generously sized with a roomy glass-walled shower stall and twin sinks.

## Category 7

**Upper Deck:** #215, 219, 230

These large cabins with private balconies have two single beds that can convert to an Olympic-sized queen. They have seating areas with a sofa-bed and can be converted to triples. Cabins also include a desk with chairs, coffee table with sitting chair, and a small table. Bathrooms are generously sized with a roomy glass-walled shower stall and twin sinks.



## Category A Solo

**Main Deck:** #309-311, 329-334

These cabins feature one single bed and a large window, a writing desk, reading lamp, bathroom with a roomy glass-wall shower stall, and a TV.



## Category B Solo

**Upper Deck:** #203, 208

**Veranda Deck:** #105-106

These cabins feature one single bed and a large window, a writing desk, reading lamp, bathroom with a roomy glass-wall shower stall, and a TV.





## Bridge Deck



## Wellness Deck



## Veranda Deck

- Category 4
- Category 6
- Category B Solo

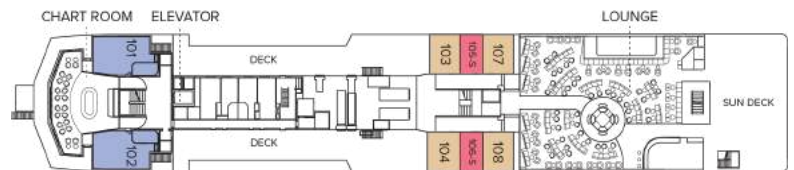

## Upper Deck

- Category 4
- Category 5
- Category 6
- Category 7
- Category B Solo



## Main Deck

- Category 1
- Category 2
- Category 3
- Category 2 Solo



## B Deck



# Ship amenities

## Public Areas

Reception; three dining areas; global gallery; library, B&H Photo locker; 24-hour Bistro area beverage bar; lounge with bar and state-of-the-art presentation facilities; observation lounge; mudroom with lockers for expedition gear; plus open access to the Bridge, the Captain, officers and on-duty wildlife spotters.

## Meals

Meals are served in the dining room, Bistro bar, or the Observation lounge, at a single seating with unassigned tables for an informal atmosphere and easy mingling. Menus feature sustainable choices, local where possible.

## Cabins

81 outside cabins. All cabins face outside with windows or portholes, private bathroom, and climate controls. Cabins are equipped with Wi-Fi, multiple electrical outlets, USB outlets, full length mirror and phones. TV featuring entertainment on demand, live feed for onboard presentations, bow camera and ship's position. Luxury bed linens and pillows. Botanically inspired shampoo, conditioner, shower gel, and lotion are all available in cabin bathrooms, as well as an Expedition Essential Kit. Hair dryers, complimentary insulated water bottles and a National Geographic Atlas is available in each cabin.

## Expedition Equipment

Zodiac landing craft, a fleet of double kayaks, a crow's nest camera, a hydrophone, underwater video cameras, video microscope, and an ROV. Plus, for South Pacific voyages: snorkeling gear for all guests, scuba gear for a number of pre-qualified guests, stand-up paddleboards, glass-bottom Zodiac, and splash-cam.



## Special Features

A full-time doctor, undersea specialist, National Geographic photographer, Lindblad-National Geographic certified photo instructor and video chronicler, internet café and laundry. Enjoy a session in the topside library with a good book, or with the book in your lap, eyes trained on the horizon.

## Wellness

A glass-enclosed fitness center, outdoor stretching area, a LEXspa treatment room and sauna, staffed by wellness specialists.

## Self-Disinfecting Ships

ACT Clean Coat™ is a light-activated, self- disinfecting cleaning process that continuously breaks down viruses, bacteria, mold, and airborne allergens across all ship surfaces. Not only does this create a cleaner, healthier shipboard environment for guests and crew alike, but this non-toxic, chemical- free system also saves more than one million gallons of water each year in our cleaning procedures, and reduces our carbon footprint as well as the amount of plastic and waste in our supply chain.

# Special Offers

## SUITE EXCLUSIVES

Spacious living areas and incredible views immerse you in the beauty of your marine surroundings. Our new Suite Exclusives package helps make your voyage all the more memorable. [Learn more](#)

## 10% OFF BACK-TO-BACK VOYAGES

Save 10% on consecutive departures, applicable on voyage fares only and not valid on extensions or airfare. Valid for new bookings only, subject to availability, and may not be combined with other offers. Call for details.

## BRINGING THE KIDS

We believe sharing an expedition with children is a life-enhancing experience. Take \$500 off for each child under the age of 18 on any departure. Not applicable on extensions or airfare. Call for details.

## SAVE 5% TRAVELING AS A GROUP

Save 5% when traveling as a group of eight or more people. Valid on voyage fares only and not applicable on extensions or airfare. Deposit, final payments, and cancellation policies for group travel vary from our regular policies. Valid for new bookings only, subject to availability, and may not be combined with other offers. Call for details.

## CELEBRATE LIFE'S MILESTONES

Celebrate a milestone with a group of eight or more and enjoy a special amenity package including: 5% savings on voyage fares, custom group photo, US\$150 shipboard credit for the group, and other special gifts. Milestone celebration to be communicated at time

of booking. Valid for new bookings only on select departures, subject to availability, not applicable on airfare or extensions, and may not be combined with other offers. Deposit, final payments, and cancellation policies for group travel vary from our regular policies. Call for details.

## COMBINING OFFERS

Certain offers may be combinable, up to two savings opportunities, except where noted otherwise. For example, travel with a group of 8 or more on back-to-back expeditions, and take advantage of both savings.



## Included in price

All accommodations aboard ship or in hotels per itinerary; all meals as indicated in the itinerary, both aboard and onshore; beer, wine, cocktails, and spirits aboard the ship (except certain super premium brands which are available for purchase); hors d'oeuvres, 24-hour access to snacks, premium coffees and teas, non-alcoholic beverages, and filtered water; excursions and airport transfers to and from recommended flights, as indicated in the itinerary; crew gratuities; exploration tools curated to destination, such as Zodiacs, kayaks, guidance and company of our leading expedition staff; assistance by the National Geographic Photography Expert and Lindblad Expeditions-National Geographic certified photo instructor; access to the OM System Photo Gear Locker; presentations by expedition staff and expert guest speakers; complimentary parka or jacket, complimentary reusable water bottle; services of a medical professional; morning stretch classes and 24-hour access to exercise equipment; 24-hour access to lounges, observation decks, library, and other shared spaces; park and site entrance fees, special access permits, and port taxes. Unused services or items included in our programs are non-refundable.

## Not included in price

Airfare (except flights when indicated as included); pre- and post-expedition extensions; additional hotel nights (except when indicated as included); private transfers; laundry, spa treatments, Wi-Fi, and phone services (except when indicated as included); travel protection plans; and passport, visa, and immigration fees.

## Travel protection plan

We strongly recommend our guests to take advantage of our Travel Protection Plan. This plan offers comprehensive coverage to protect you from cancellation fees, costs incurred due to trip delays/interruption, damage or loss of baggage, medical assistance, and evacuation during your travels. Our Travel Protection Plan is available for U.S. residents only, and may be purchased any time prior to final payment due date, Travel Protection premiums are non-refundable once plan is purchased. Learn more about our Travel Protection "Plus" Plan: <https://www.expeditions.com/terms-conditions/travel-protection-plan/>

## Cancellation policy

Review our cancellation policy: <https://www.expeditions.com/cancellation-policy/>