

Alaska, Canada & North America  
53° 23' N 128° 55' W

## Voyage to Great Bear Rainforest: Native Culture and Wildlife in the Land of the Spirit Bear

Aboard *National Geographic Venture*, explore the northern coast of British Columbia and sail into Great Bear Rainforest, the only place where the elusive Kermode bear, or spirit bear, can be found. Get immersed in the region's pristine natural beauty, and search for wildlife on land and sea—from orcas and sea lions to grizzly bears and golden eagles—as we navigate glacier-cut fjords, soaring granite peaks, and moss-draped forests.

From

**\$ 5,788** / per person  
Does not include flights



### DATES

Sep



### DURATION

8 Days



### SHIPS

*National Geographic Venture*



### STARTS AT

Ketchikan,  
Alaska



### ENDS AT

Prince  
Rupert,  
British  
Columbia

Please review the [Essential Eligibility Criteria](#) for hiking activities on this voyage.

The [National Park Service](#) and the Department of the Interior authorize this institution to serve the public in Glacier Bay National Park and Preserve.

This institution is an [equal opportunity provider](#).

# Highlights

- ★ Take kayaks and Zodiacs deep into verdant fjords and wildlife-rich shores in search of bears, golden eagles, river otters, pods of orcas, and more
- ★ Journey into pristine forests inaccessible by road and managed by First Nations people
- ★ Learn the human history of the region from our cultural interpreter and on visits to fascinating First Nations museums
- ★ Kayak among massive smacks of jellyfish and witness the surprising undersea through video shot by our undersea specialist





## Day by day

### ■ DAY 1

#### Ketchikan, Alaska / Embark Ship

Arrive in Ketchikan, the southernmost city in Alaska, spread at the base of forested slopes on Revillagigedo Island, in the early afternoon. Its many monikers, from "salmon capital of the world" to "rain capital of Alaska," capture the spirit of this city, famous for colorful buildings and abundant fishing boats and canneries. Embark *National Geographic Venture* in time for cocktails and an introduction of the vessel staff and crew.

Meals included: dinner

### ◇ DAY 2

#### Prince Rupert, British Columbia, Canada

Wake up in Prince Rupert, a scenic harbor town on British Columbia's rugged northwest coast. Get immersed in First Nations history at the Museum of Northern British Columbia, built in the style of a coastal longhouse. Breathe in the scent of cedar beams and peruse an impressive collection of ornate carvings, weavings, ceremonial objects, and regalia. Visit the North Pacific Cannery Museum, a collection of cannery buildings located in pristine wilderness surroundings that highlight British Columbia's economic, cultural, and natural development over the last century.

Meals included: breakfast, lunch, dinner

### ◇ DAYS 3-6

#### Exploring the Great Bear Rainforest and Rugged Coastline of British Columbia

Over the course of the next four days, we cruise far into the fjords and deep valleys that carve into the

Coast Range looking for black and grizzly bears. We are accompanied by a cultural interpreter\* who will share local Indigenous knowledge, culture, and practice, offering unparalleled insights. We will cruise the eastern coast of Princess Royal Island in search of the elusive spirit bear. It is believed that between 10 to 20 percent of bears in this region are born with the recessive gene that causes the white fur; fewer than 400 are estimated to exist.

British Columbia has one of the highest proportions of protected land of any jurisdiction in the world. Almost 15 percent of the land is protected, with a wide range of provincial parks, national parks, and UNESCO World Heritage sites. We go ashore and explore several remote locations where few people venture. Discover hidden gems by Zodiac and kayak, navigate the tidal narrows that lead to the backs of bays while constantly scanning for bears along the rocky shoreline and meadows such as Gilttoyes Inlet.

*\*Please note: Cultural interpreter is dependent on availability.*

Meals included: breakfast, lunch, dinner

### ◇ DAY 7

#### Cruising and Lowe Inlet Provincial Marine Park

Seek out pods of killer whales and foraging bears as we sail north through the narrow Grenville Channel between Pitt Island and the mainland, a dramatic navigational experience. Not only does the channel narrow to less than a quarter of a mile across, but a slight bend in the passage makes the waterway seem to disappear into the hills ahead and behind the ship. Here, we will drop our Zodiacs and kayaks to explore the salmon run at Verney Falls in Lowe Inlet Provincial Marine Park on our way to Prince

Rupert.

Meals included: breakfast, lunch, dinner

■ DAY 8

## Prince Rupert / Disembark Ship / Seattle / Fly Home

Disembark in Prince Rupert and transfer to the airport in Terrace. Board a charter flight to Seattle for your connecting flight home.

Meals included: breakfast

**Expedition**

Ketchikan, Alaska → Prince Rupert, British  
Columbia

**2024 Departure Dates**

Aboard *National Geographic Venture*

02 Sep	09 Sep	16 Sep	
--------	--------	--------	--

**2025 Departure Dates**

Aboard *National Geographic Venture*

01 Sep	08 Sep	15 Sep	
--------	--------	--------	--



## ***National Geographic Venture***

---

**Guests**

100

**Cabins**

50

---

**The *National Geographic Venture* is a state-of-the-art expedition ship ideal for discovering remote locations in domestic waters.**

Following the build of *National Geographic Quest* at Nichols Brothers shipyard, her sister ship the 100 guest *National Geographic Venture* floated into the bay on Whidbey Island, becoming the 4th ship in the Lindblad fleet built at this storied PNW shipyard. In the 1970s, Nichols Brothers built the twin ships *National Geographic Sea Bird* and *National Geographic Sea Lion*, which continue to sail the waters of the west coast of North America and Central America.

*Venture*, like much of the wildlife she follows, is migratory. She follows the seasons from Alaska, along the coast of British Columbia, up the Columbia & Snake Rivers, and along the Baja coast and into the Sea of Cortez. In each region, her design innovations were informed by 50+ years of expedition expertise to ensure extraordinary discoveries. Larger than her sibling twin ships, *National Geographic Sea Bird* and *National Geographic Sea Lion*, *National Geographic Venture* has the same shallow draft, enabling her to nimbly navigate the same inner reaches and provide the same intimate, 'insider' experiences of the charismatic regions we explore.

Like her sister ship *National Geographic Quest*, *National Geographic Venture* has dual boarding platforms, enabling our team to load two Zodiacs at once means guests get off ship quickly, to take advantage of wildlife sightings and maximize exploring time. Modern, cleaned-lined, with large expanses of glass to keep you connected to the extraordinary views, *National Geographic Venture* enables you to see, do and experience the best of her geographies.



# Cabin Categories

## Category 1

**Main Deck: #301-306**

Cabins feature two single beds that can convert to a Queen, a writing desk, two nightstands and two portholes, full length mirror, and reading lights.



## Category 2

**Main Deck: #307-315**

Cabins feature two single beds that can convert to a Queen, a writing desk, two nightstands and two portholes, full length mirror, and reading lights.



## Category 3

**Upper Deck: #201-206**

Cabins feature two single beds that can convert to a Queen, a writing desk, two nightstands, a large view window, full-length mirror, and reading lights.



## Category 4

**Upper Deck: #207-229**

Cabins feature two single beds that can convert to a Queen, a writing desk, closet, two nightstands, full-length mirror, reading lights, sliding glass door, and a small, private balcony.



**Note:** Solo occupancy cabins are available in Categories 1 and 2 only. Third person rates are available in Category 5 cabins at one half the double occupancy rate.

### Connecting Cabins via internal doorway access:

Main Deck: #312-314, #311-315, #306-307;  
Upper Deck: #224-226, #225-227

## Category 5

### Observation Deck: #101-108 (SUITE)

Cabins feature two single beds that can convert to a Queen, large view windows, closet, two nightstands, full-length mirror, reading lights, a suite-sized expanded bathroom, writing desk, ample storage space, and a convertible sofa bed to accommodate a third person.



## Observation Deck

Category 5

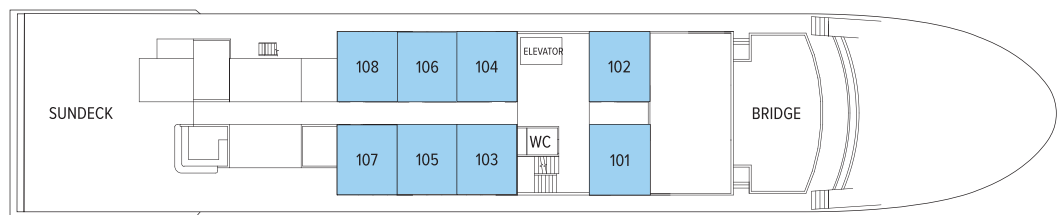

## Lounge Deck

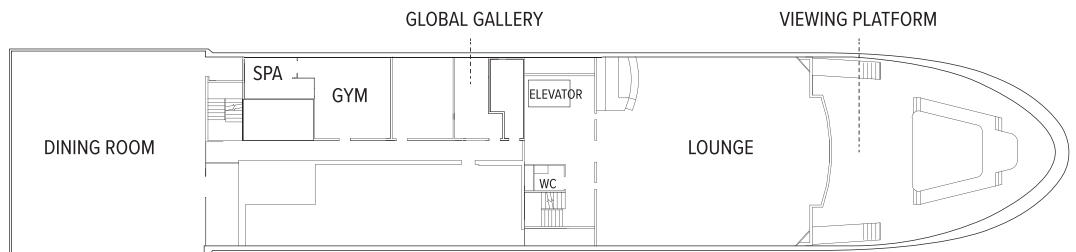

## Upper Deck

Category 3

Category 4

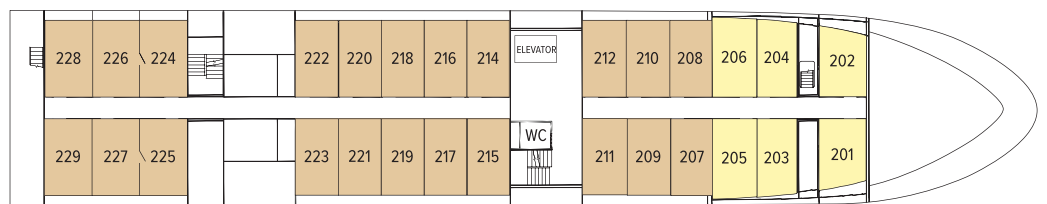

## Main Deck

Category 1

Category 2

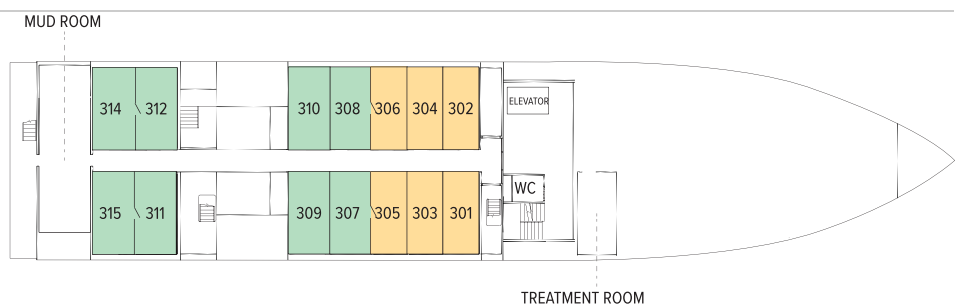

# Ship amenities

## Public Areas

Reception; main dining area; global gallery; fitness center; lounge with full-service bar and state-of-the-art presentation facilities; observation deck; mudroom with lockers for expedition gear; partially-covered furnished sundeck; plus open access to the Bridge, the Captain, officers and on-duty wildlife spotters.

## Meals

Meals are served in the dining room at a single seating with unassigned tables for an informal atmosphere and easy mingling. Menus feature sustainable choices, local where possible.

## Cabins

50 outside cabins. All cabins face outside with windows, private bathroom, and climate controls. Cabins are equipped with Wi-Fi, phone, multiple electrical and USB outlets, and phones. Luxury linens and pillows. Botanically inspired shampoo, conditioner, shower gel, and lotion are all available in cabin bathrooms, as well as an Expedition Essential Kit. Hair dryers, complimentary insulated water bottles and a National Geographic Atlas are also available in each cabin.

## Expedition Equipment

A fleet of 8 Zodiacs, 24 kayaks, paddleboards; an ROV, hydrophone, splash-cam, underwater video camera, video microscope; snorkeling gear and wet suits for all guests (where applicable).

## Special Features

Lindblad-National Geographic certified photo instructor, undersea specialist and video chronicler. Internet access. Elevator. The design of the outside decks—with the perfect wildlife viewing platform. And the way the proximity of the Lounge to the deck gives you instant access to spontaneous sightings. Have your camera ready!

## Wellness

A fitness center with elliptical, treadmill, weights, resistance bands; LEXspa treatment room, staffed by wellness specialists.



## Self-Disinfecting Ships

ACT Clean Coat™ is a light-activated, self-disinfecting cleaning process that continuously breaks down viruses, bacteria, mold, and airborne allergens across all ship surfaces. Not only does this create a cleaner, healthier shipboard environment for guests and crew alike, but this non-toxic, chemical-free system also saves more than one million gallons of water each year in our cleaning procedures, and reduces our carbon footprint as well as the amount of plastic and waste in our supply chain.

# Special Offers

## SUITE EXCLUSIVES

Spacious living areas and incredible views immerse you in the beauty of your marine surroundings. Our new Suite Exclusives package helps make your voyage all the more memorable. [Learn more](#)

## 10% OFF BACK-TO-BACK VOYAGES

Save 10% on consecutive departures, applicable on voyage fares only and not valid on extensions or airfare. Valid for new bookings only, subject to availability, and may not be combined with other offers. Call for details.

## BRINGING THE KIDS

We believe sharing an expedition with children is a life-enhancing experience. Take \$500 off for each child under the age of 18 on any departure. Not applicable on extensions or airfare. Call for details.

## CELEBRATE LIFE'S MILESTONES

Celebrate a milestone with a group of eight or more and enjoy a special amenity package including: 5% savings on voyage fares, custom group photo, US\$150 shipboard credit for the group, and other special gifts. Milestone celebration to be communicated at time of booking. Valid for new bookings only on select departures, subject to availability, not applicable on airfare or extensions, and may not be combined with other offers. Deposit, final payments, and cancellation policies for group travel vary from our regular policies. Call for details.

## SAVE 5% TRAVELING AS A GROUP

Save 5% when traveling as a group of eight or more

people. Valid on voyage fares only and not applicable on extensions or airfare. Deposit, final payments, and cancellation policies for group travel vary from our regular policies. Valid for new bookings only, subject to availability, and may not be combined with other offers. Call for details.

## COMBINING OFFERS

Certain offers may be combinable, up to two savings opportunities, except where noted otherwise. For example, travel with a group of 8 or more on back-to-back expeditions, and take advantage of both savings.

## Included in price

All accommodations aboard ship or in hotels per itinerary; all meals as indicated in the itinerary, both aboard and onshore; beer and wine on all 2023 departures (starting in 2024, spirits and cocktails are also included, with super premium wines and liquors available for purchase); hors d'oeuvres, 24-hour access to snacks, premium coffees and teas, non-alcoholic beverages, and filtered water; excursions and airport transfers to and from recommended flights, as indicated in the itinerary; exploration tools curated to destination, such as Zodiacs, stand-up paddleboards, kayaks; guidance and company of our leading expedition staff; assistance by the Lindblad Expeditions-National Geographic certified photo instructor; access to the OM System Photo Gear Locker; presentations by expedition staff and expert guest speakers; complimentary reusable water bottle; services of a physician, physician's assistant, nurse practitioner, or paramedic; morning stretch classes and 24-hour access to exercise equipment; 24-hour access to lounges, observation decks, library, and other shared spaces; park and site entrance fees, special access permits, and port taxes. Unused services or items included in our programs are non-refundable.

## Not included in price

Airfare (except flights when indicated as included); pre- and post-expedition extensions; additional hotel nights (except when indicated as included); crew gratuities; private transfers; laundry, spa treatments, Wi-Fi, and phone services (except when indicated as included); travel protection plans; and passport, visa, and immigration fees.

## Travel protection plan

We strongly recommend our guests to take advantage of our Travel Protection Plan. This plan offers comprehensive coverage to protect you from cancellation fees, costs incurred due to trip delays/interruption, damage or loss of baggage, medical assistance, and evacuation during your travels. Our Travel Protection Plan is available for U.S. residents only, and may be purchased any time prior to final payment due date, Travel Protection premiums are non-refundable once plan is purchased. Learn more about our Travel Protection "Plus" Plan: <https://www.expeditions.com/terms-conditions/travel-protection-plan/>

## Cancellation policy

Review our cancellation policy: <https://www.expeditions.com/cancellation-policy/>