

 Iceland, Arctic & Europe
 66° 1' N 16° 30' W

Fire and Ice: An 8-Day Sail Around Iceland

Sail around Iceland on an 8-day expedition that reveals its famed natural wonders. Hike or bike to explore remote waterfalls, secluded valleys, dramatic fjords, black-sand beaches, and forest-filled canyons. Spot an abundance of seabirds from Atlantic puffins to Arctic terns and cruise into an otherworldly glacier lagoon. Along the way, meet locals who will share Icelandic traditions as well as a glimpse into daily life, both past and present, on this subarctic island.

From
\$ 8,946 / per person
 Does not include flights

 DATES May, Jun, Jul and Aug	 DURATION 8 Days
 SHIPS <i>National Geographic Explorer</i>	
 STARTS AT Reykjavík, Iceland	→  ENDS AT Reykjavík, Iceland

Highlights

- ★ Sail around the Island of Fire and Ice, discovering its wealth of wildlife, striking geological formations, and a culture steeped in saga and exploration history
- ★ Explore a variety of landscapes across the island, from lava fields and geothermal springs to black-sand beaches and thundering waterfalls
- ★ Hike the rim of a volcanic crater for spectacular views of the Westman Islands
- ★ Walk along boardwalks for close views of puffins at Borgarfjarðarhöfn, often called the 'puffin capital of Iceland'





Day by day

■ DAY 1

Reykjavík, Iceland / Embark Ship

Arrive in Reykjavík, the world's northernmost capital, which lies just below the Arctic Circle. Transfer from the airport to the city and spend the day exploring at your own pace. Check in with the hospitality desk this afternoon before embarking the ship.

Meals included: dinner

◇ DAY 2

Westfjords

Explore the beautiful and peaceful Westfjords region of Iceland. Hike or kayak along the base of a fjord to discover a towering waterfall. Enter Ísafjarðardjúp, known for its wealth of animal life, including whales, seals and countless nesting seabirds. Land at Vigur Island, a fragile wildlife sanctuary, where the landowners continue the traditional eiderdown collection and cleaning process and are active stewards of the colonies of puffins and black guillemots who call the island home.*

**Visit subject to nesting seabird season and not available on all dates.*

Meals included: breakfast, lunch, dinner

◇ DAY 3

Siglufjörður

Siglufjörður was the center of Iceland's once-thriving herring industry. Stop by the Herring Museum for a salting demonstration and a tasting. Enjoy the surroundings of Iceland's northernmost mainland settlement by joining the local forestry association, one of over 50 associations in Iceland, for an afternoon of conservation in their local forest. Learn what it takes to maintain and develop a forest on

this volcanic island.

Meals included: breakfast, lunch, dinner

◇ DAY 4

Húsavík

Húsavík, the site of the oldest settlement in Iceland, is your gateway to the geological exploration of northern Iceland. Depart for a full day overland visiting one of the largest waterfalls in Iceland, Goðafoss, as well as the Lake Mývatn area, the most geologically active area in Iceland. Alternatively, enjoy an adventurous journey hiking through Ásbyrgi Canyon, said to be formed by the hoof of Odin's eight-legged horse, or stay along the coast and choose a slower pace for the day with forest bathing, bird watching and a soak in the Geo Sea bath.

Meals included: breakfast, lunch, dinner

◇ DAY 5

Borgarfjarðarhöfn

Located on the eastern shore of Iceland, Bakkagerði is well known for its welcoming local puffin colony. Walk across boardwalks to witness these colorful symbols of Icelandic wildlife. Once you've captured your best photo of the famous auk species, take an invigorating hike up to the best panoramic view of the fjord or challenge yourself to a backcountry mountain bike journey to remote overlooks and stunning vistas.

Meals included: breakfast, lunch, dinner

◇ DAY 6

Djúpivogur

Arrive in the town of Djúpivogur and set out by 4x4 vehicle to visit some of the secluded valleys and remote waterfalls in the surrounding countryside.

Alternatively, drive down the coast to explore the foot of the vast Vatnajökull icecap and the deep blue icebergs of the large ice lagoon of Jökulsárlón. Or, join a hike to the black-sand beaches near the town center.

Meals included: breakfast, lunch, dinner

◇ DAY 7

Heimaey and Surtsey, Westman Islands

The Westman Islands were formed by undersea volcanoes between 5,000 and 10,000 years ago and are among the youngest of the world's archipelagos. In 1963, the world witnessed on film the birth of its newest island, Surtsey—a UNESCO World Heritage site—which you'll see as you cruise past the coast. In 1973, Heimaey was threatened by lava flows that nearly closed off its harbor. Visit the crater, where the earth is still hot, for amazing views of areas that had been engulfed by lava.

Meals included: breakfast, lunch, dinner

■ DAY 8

Reykjavík / Disembark Ship

Disembark in Reykjavík and transfer to the airport for flights home.

Meals included: breakfast

Expedition

Reykjavík, Iceland → Reykjavík, Iceland

2025 Departure Dates

Aboard *National Geographic Explorer*

27 May				
03 Jun	10 Jun	17 Jun	24 Jun	
01 Jul	08 Jul	15 Jul	22 Jul	29 Jul
05 Aug				



National Geographic Explorer

Guests 148	Cabins 81
----------------------	---------------------

Built to handle deep swells and towering waves, the *National Geographic Explorer* lends herself to globe-spanning travel and a dedication to curiosity and wonder.

Originally constructed for service along Norway's coast as part of the famed Hurtigruten, or Coastal Express, she ferried passengers among the fjords of this iconic coast in conditions that could deteriorate into heavy seas in a matter of minutes. She had to be able to handle deep swells and towering waves—and have a high degree of maneuverability. Those traits, and an ideal size, made her a natural choice for addition to the Lindblad fleet.

The plans to completely rebuild her drew on 50 years of pioneering expedition history and expertise. *National Geographic Explorer* was equipped with an ice-strengthened hull and advanced navigation equipment for polar expeditions; a roster of tools for exploration; and a well-appointed interior with vast expanses of glass for an unprecedented connection to the environment. Her interior and exterior design embodied the Lindblad expedition ethos—the privilege of wildness and the luxury of comfort.

For many guests she remains their paradigm of an expedition ship. She is devoted to exploration—from her Welcoming Bridge, and the Chart Room below it where you can tuck in to warm up with a hot chocolate, to her high-perched Observation deck with its aqueous light and compelling 24/7 views. Even the art on the walls— from the Hurley prints of Shackleton’s expedition to the stunning National Geographic photos— tells an uber- narrative of globe-spanning travel and a dedication to curiosity and wonder.

National Geographic Explorer is a state-of-the-art expedition ship. She is a fully stabilized, ice-class vessel, with an ice-reinforced hull, enabling her to navigate polar passages while providing exceptional comfort.



Cabin Categories

Category 1

Main Deck: #301-308

Cabins feature one or two portholes. Most cabins feature two single beds that can be converted to a queen. Cabins #301-306 feature one queen-sized bed. All cabins feature a writing desk, floor length mirror, reading lamps, well-appointed bathrooms with a roomy glass-wall shower, and a TV.



Category 2

Main Deck: #317-320, 335-336

Cabins feature two single beds (some can convert to a queen-sized bed), and one large window. They offer a writing desk, floor length mirror, reading lamps, sitting chair, well-appointed bathrooms with a roomy glass-wall shower, and a TV.



Category 3

Main Deck: #313-316, 321-328, 337-340, 342, 344, 348, 350

Cabins feature two single beds (some can convert to a queen-sized bed), one large window, and two sitting chairs and a small table and ample storage. They have a writing desk, floor length mirror, reading lamps, well-appointed bathrooms with a roomy glass-wall shower, and a TV. Cabins 341 & 343 have a sofa bed for a triple.



Category 4

Upper Deck: #201-202, 204-207, 210, 212, 217, 226, 228

Cabins feature two single beds and at least one large window. All cabins can convert between two single beds to a queen, except Cabins 217, 226 & 228 that feature one queen-size bed only. All cabins feature climate controls, sitting chairs, and a TV. Bathrooms are also generously sized with a roomy glass-walled shower stall.



Veranda Deck: #103-104, 107-108

Cabins feature two single beds than can convert into a queen. They have a writing desk, floor length mirror, reading lamps, sitting chair, private bathrooms with a glass-wall shower, and a TV.

Category 5

Upper Deck: #209, 211, 214, 216, 218, 220-222, 224

Cabins feature a balcony with sliding glass doors, one queen-sized bed, writing desk, floor length mirror, reading lamps, private bathrooms with a glass-wall shower, and a TV. (Cabin 221 has two single beds that can convert to a queen.)



Category 6

Upper Deck: #213

This spacious cabin has a private balcony, two single beds that can be converted into a queen, a writing desk, double closet, bookcase, pull-out sofa, armchairs, two large windows, and a TV. The sleeping area has a glass partition separating the living room. Bathrooms are generously sized with a roomy glass-walled shower stall and twin sinks.



Veranda Deck: #101-102

These spacious cabins can be converted into triples. They have two single beds that can be converted into a queen, a writing desk, double closet, bookcase, sofa-bed, chairs, two large windows, and a TV. The sleeping area can be closed off with the glass partition. Bathrooms are generously sized with a roomy glass-walled shower stall and twin sinks.

Category 7

Upper Deck: #215, 219, 230

These large cabins with private balconies have two single beds that can convert to an Olympic-sized queen. They have seating areas with a sofa-bed and can be converted to triples. Cabins also include a desk with chairs, coffee table with sitting chair, and a small table. Bathrooms are generously sized with a roomy glass-walled shower stall and twin sinks.



Category A Solo

Main Deck: #309-311, 329-334

These cabins feature one single bed and a large window, a writing desk, reading lamp, bathroom with a roomy glass-wall shower stall, and a TV.



Category B Solo

Upper Deck: #203, 208

Veranda Deck: #105-106

These cabins feature one single bed and a large window, a writing desk, reading lamp, bathroom with a roomy glass-wall shower stall, and a TV.



Bridge Deck

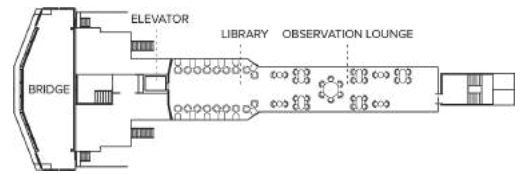

Wellness Deck

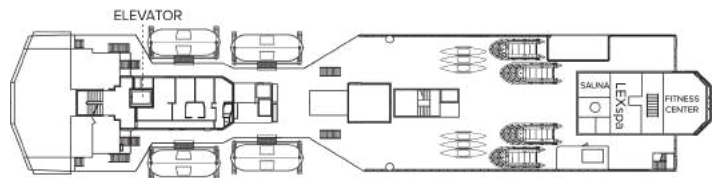

Veranda Deck

- Category 4
- Category 6
- Category B Solo

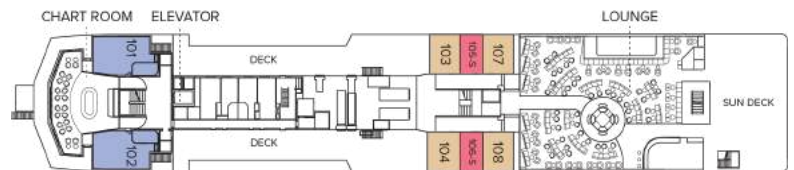

Upper Deck

- Category 4
- Category 5
- Category 6
- Category 7
- Category B Solo

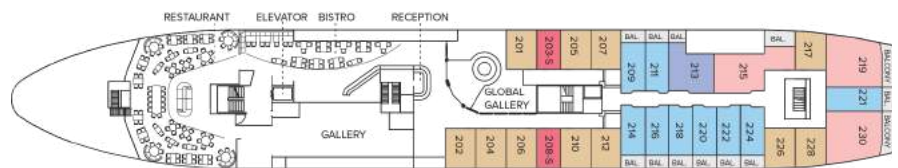

Main Deck

- Category 1
- Category 2
- Category 3
- Category 2 Solo

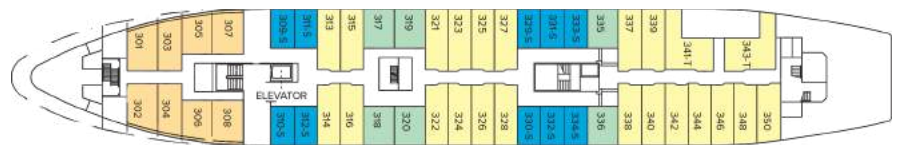

B Deck

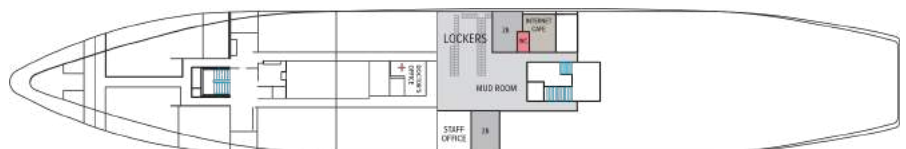

Ship amenities

Public Areas

Reception; three dining areas; global gallery; library, B&H Photo locker; 24-hour Bistro area beverage bar; lounge with bar and state-of-the-art presentation facilities; observation lounge; mudroom with lockers for expedition gear; plus open access to the Bridge, the Captain, officers and on-duty wildlife spotters.

Meals

Meals are served in the dining room, Bistro bar, or the Observation lounge, at a single seating with unassigned tables for an informal atmosphere and easy mingling. Menus feature sustainable choices, local where possible.

Cabins

81 outside cabins. All cabins face outside with windows or portholes, private bathroom, and climate controls. Cabins are equipped with Wi-Fi, multiple electrical outlets, USB outlets, full length mirror and phones. TV featuring entertainment on demand, live feed for onboard presentations, bow camera and ship's position. Luxury bed linens and pillows. Botanically inspired shampoo, conditioner, shower gel, and lotion are all available in cabin bathrooms, as well as an Expedition Essential Kit. Hair dryers, complimentary insulated water bottles and a National Geographic Atlas is available in each cabin.

Expedition Equipment

Zodiac landing craft, a fleet of double kayaks, a crew's nest camera, a hydrophone, underwater video cameras, video microscope, and an ROV. Plus, for South Pacific voyages: snorkeling gear for all guests, scuba gear for a number of pre-qualified guests, stand-up paddleboards, glass-bottom Zodiac, and splash-cam.



Special Features

A full-time doctor, undersea specialist, National Geographic photographer, Lindblad-National Geographic certified photo instructor and video chronicler, internet café and laundry. Enjoy a session in the topside library with a good book, or with the book in your lap, eyes trained on the horizon.

Wellness

A glass-enclosed fitness center, outdoor stretching area, a LEXspa treatment room and sauna, staffed by wellness specialists.

Self-Disinfecting Ships

ACT Clean Coat™ is a light-activated, self-disinfecting cleaning process that continuously breaks down viruses, bacteria, mold, and airborne allergens across all ship surfaces. Not only does this create a cleaner, healthier shipboard environment for guests and crew alike, but this non-toxic, chemical-free system also saves more than one million gallons of water each year in our cleaning procedures, and reduces our carbon footprint as well as the amount of plastic and waste in our supply chain.

Special Offers

GIFT OF EXPLORATION: \$500 CREDIT

Book from December 3, 2024, to March 4, 2025. Receive a credit of \$500 per person on select departures, deducted from cabin fare prior to any additional applicable savings with the purchase of cabin fare. Valid for new bookings only on select departures, subject to availability, not applicable on airfare or extensions and may not be combined with other offers. Call for details.

GIFT OF EXPLORATION: FREE AIR UP TO \$2,000 PER CHILD

Free economy air up to \$2,000 per child per adult based on select departures. Book from December 3 to December 31, 2024, and receive free economy round trip air for one child per adult up to \$2,000 based on select departures. The offer is valid for 1 child per adult. Free Kids Air Offer must be communicated at time of booking by quoting "KID INCLUDED". To qualify for the offer, airfare must be ticketed by Lindblad Expeditions and is for economy class air only. Any upgrades or additional classes are not included. Offer may be applied to any recommended air Lindblad offers. Offer is valid for new bookings only, on select departures, subject to availability, may not be combined with other offers. Baggage fees may incur additional costs and seat assignments may not be guaranteed. Call for details.

GIFT OF EXPLORATION: UP TO 40% SOLO SAVINGS

Book from December 3, 2024, to March 4, 2025. Save 33% or 40% on solo cabins on select departures. Solo savings are subject to availability. Other expeditions may be available with a solo saving. Not applicable on airfare or extensions and may not be combined with

other offers. A full list of solo savings is available via expeditions.com or call for details.

GIFT OF EXPLORATION: ADDITIONAL 5% SAVINGS WHEN YOU PAY IN FULL

Book from December 3, 2024, to March 4, 2025. Save an additional 5% on the cabin fare on select departures when you pay in full at time of booking. To qualify for the discount, non-refundable payment in full is due at the time of booking. Valid for new bookings only on select departures, subject to availability, not applicable on airfare or extensions and may not be combined with other offers. Call for details.

CELEBRATE LIFE'S MILESTONES

Celebrate a milestone with a group of eight or more and enjoy a special amenity package including: 5% savings on voyage fares, custom group photo, US\$150 shipboard credit for the group, and other special gifts. Milestone celebration to be communicated at time of booking.

BRINGING THE KIDS

We believe sharing an expedition with children is a life-enhancing experience. Take \$500 off for each child under the age of 18 on any departure. Not applicable on extensions or airfare. Call for details.

COMBINING OFFERS

Certain offers may be combinable, up to two savings opportunities, except where noted otherwise. For example, travel with a group of 8 or more on back-to-back expeditions, and take advantage of both savings.

Travel protection plan

We strongly recommend our guests to take advantage of our Travel Protection Plan. This plan offers comprehensive coverage to protect you from cancellation fees, costs incurred due to trip delays/interruption, damage or loss of baggage, medical assistance, and evacuation during your travels. Our Travel Protection Plan is available for U.S. residents only, and may be purchased any time prior to final payment due date, Travel Protection premiums are non-refundable once plan is purchased. Learn more about our Travel Protection "Plus" Plan: <https://www.expeditions.com/terms-conditions/travel-protection-plan/>

Cancellation policy

Review our cancellation policy: <https://www.expeditions.com/cancellation-policy/>