





 California Coast & North America
33° 23' N 118° 24' W

Discovering Channel Islands National Park: A 5-Day Voyage

Discover a hidden wild side of a well-known region. Just off the coast of California, one of the lesser-known U.S. national parks beckons, with dramatic sea cliffs, grassy headlands, and rocky islets. Dayboats can take you to individual islands to hike or camp, but our small ships provide a mobile base camp from which to actively explore the full natural splendor of this unique archipelago.

From
\$ 3,310 / per person
Does not include flights

 DATES Apr, May, Oct and Nov	 DURATION 5 Days
 SHIPS <i>National Geographic Quest</i> <i>National Geographic Venture</i>	
 STARTS AT Los Angeles, California	 ENDS AT Los Angeles, California

Highlights

- ★ Discover the islands by walking miles of trails, paddling crystal-clear waters by kayak or stand-up paddleboard, or exploring by Zodiac
- ★ Hike in a Torrey pine grove, one of only two on Earth, and enjoy a picnic lunch with sweeping views of the natural harbor
- ★ Watch for iconic animals such as the American bison, bald eagles, and the Channel Island fox
- ★ Delve into the natural wonders and curious history of Catalina Island, including a visit to Avalon—a haven for movie stars in Hollywood's golden era





Day by day

■ DAY 1

Los Angeles, California / Embark Ship

Arrive in Los Angeles by early afternoon and transfer to the Crowne Plaza Los Angeles Harbor Hotel in San Pedro before embarking the ship. Enjoy a cocktail on the deck and meet the expedition team as you set sail in early evening.

Meals included: dinner

◇ DAY 2

Anacapa and Santa Cruz Islands, Channel Islands National Park

Wake to the ship at anchor off the rocky outcropping of East Anacapa Island. Join your wellness specialist on the sundeck for morning yoga and then enjoy the breakfast buffet. After breakfast, join naturalists aboard Zodiacs to go ashore on East Anacapa. The goal is the Anacapa Lighthouse, built in 1932, the last major light station to be built on the West Coast. Soak in the views from Inspiration Point or, for a more relaxing option, explore Arch Rock via Zodiac.

Meals included: breakfast, lunch, dinner

◇ DAY 3

Santa Rosa Island, Channel Islands National Park

Start your morning with an optional stretch class before breakfast. Weather permitting, go kayaking, hike one of the many trails or simply relax ashore. With luck, you may catch a glimpse—or photo—of the elusive fox species endemic to the island. Join the naturalists for a more strenuous hike out to the base of the Torrey pines grove, which contains what is considered one of the world's rarest pines and is one of only two naturally occurring groves in the world. End the day with a sunset cocktail party.

Meals included: breakfast, lunch, dinner

◇ DAY 4

Catalina Island

Spend the day discovering the colorful history and natural wonders of Catalina Island. Once a haunt of smugglers and gold diggers, the island was transformed into a resort destination by chewing gum tycoon William Wrigley, Jr. in the 1920s. Some 50 years later, William's heirs, Philip K. Wrigley and Dorothy Wrigley Offield, established the Catalina Island Conservancy, protecting nearly 90 percent of the island. Meet a conservancy member to learn about their work on the island before heading out on the trail for spectacular views of the coastline and the Catalina backcountry. With luck, catch a glimpse of the elusive bison herd that have resided on Catalina Island since 1924. Head for the water to kayak or stand-up paddleboard. Return to the ship for a farewell dinner and a last evening at sea under the stars.

Meals included: breakfast, lunch, dinner

■ DAY 5

Los Angeles / Disembark

Awake dockside in the bustling Port of Los Angeles (early risers can catch the action in one of the world's largest ports). Disembark after breakfast for transfers to the airport.

Meals included: breakfast

Expedition

Los Angeles, California → Los Angeles, California

2025 Departure Dates

Aboard *National Geographic Quest*

28 Apr

02 May

Aboard *National Geographic Venture*

23 Oct

27 Oct

31 Oct

2026 Departure Dates

Aboard *National Geographic Quest*

26 Apr

30 Apr

Aboard *National Geographic Venture*

31 Oct

04 Nov

08 Nov



National Geographic Quest

Guests 100	Cabins 50
----------------------	---------------------

***National Geographic Quest*, built in 2017, is designed for sailing into fast-moving channels and shallow coves in pan-American waters.**

When she rolled out of Nichols Brothers shipyard and into the bay on Whidbey Island, the 100 guest *National Geographic Quest* became the third ship in the Lindblad fleet built at this storied Pacific Northwest shipyard. In the 1970s, Nichols Brothers built the twin ships *National Geographic Sea Bird* and *National Geographic Sea Lion*, which continue to sail the waters of the west coast of North America and Central America.

National Geographic Quest was purpose-built to explore the fast-moving channels and narrow straits of Alaska, along the coast of Costa Rica, and into the gray whale nursery lagoons of Baja, her design and engineering informed by our nearly 40 years of experience in these regions. Her twin boarding platforms, for example, were suggested by a veteran staffer. Enabling our team to load two Zodiacs at once means guests get off the ship quickly to take advantage of wildlife sightings and maximize exploring time.

Larger than her siblings *National Geographic Sea Bird* and *National Geographic Sea Lion*, *National Geographic Quest* has the same shallow draft, allowing her captain to navigate the same inner reaches and provide the same intimate, "insider" experiences in these charismatic regions. Modern, clean-lined, with large expanses of glass to keep you connected to the extraordinary views, *National Geographic Quest* enables you to see, do, and experience the best of her geographies.



Cabin Categories

Category 1

Main Deck: #301-306

Cabins feature two single beds that can convert to a Queen, a writing desk, two nightstands and two portholes, full length mirror, and reading lights.



Category 2

Main Deck: #307-315

Cabins feature two single beds that can convert to a Queen, a writing desk, two nightstands and two portholes, full length mirror, and reading lights.



Category 3

Upper Deck: #201-206

Cabins feature two single beds that can convert to a Queen, a writing desk, two nightstands, a large view window, full-length mirror, and reading lights.



Category 4

Upper Deck: #207-229

Cabins feature two single beds that can convert to a Queen, a writing desk, closet, two nightstands, full-length mirror, reading lights, sliding glass door, and a small, private balcony.



Note: Solo occupancy cabins are available in Categories 1 and 2 only. Third person rates are available in Category 5 cabins at one half the double occupancy rate.

Connecting Cabins via internal doorway access:

Main Deck: #312-314, #311-315, #306-307;
Upper Deck: #224-226, #225-227

Category 5

Observation Deck: #101-108 (SUITE)

Cabins feature two single beds that can convert to a Queen, large view windows, closet, two nightstands, full-length mirror, reading lights, a suite-sized expanded bathroom, writing desk, ample storage space, and a convertible sofa bed to accommodate a third person.



Observation Deck

Category 5

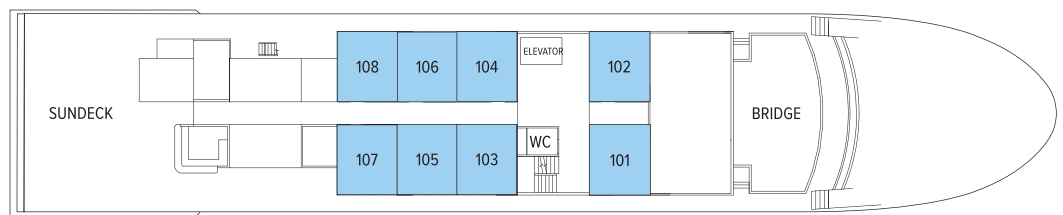

Lounge Deck

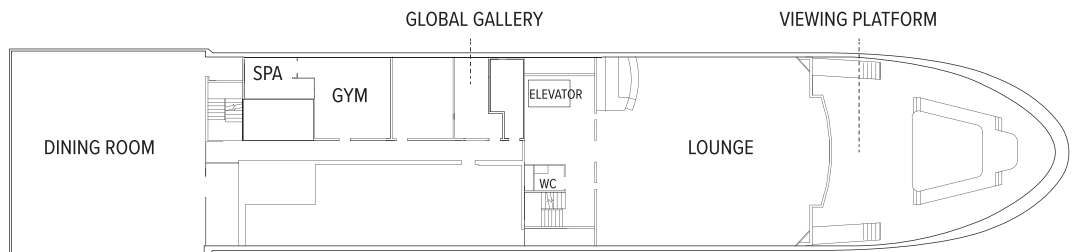

Upper Deck

Category 3

Category 4

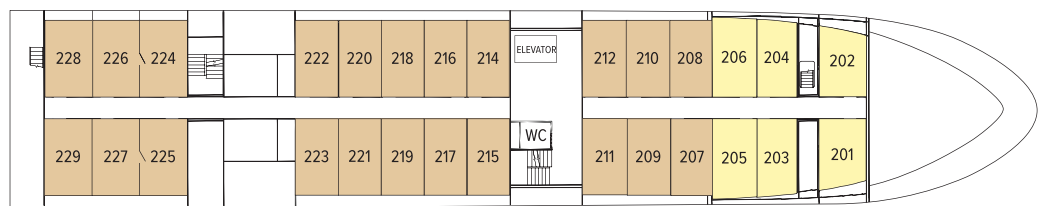

Main Deck

Category 1

Category 2

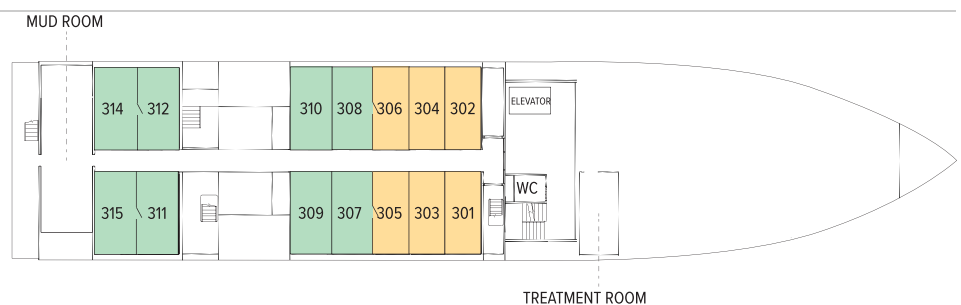

Ship amenities

Public Areas

Reception; main dining area; global gallery; fitness center; lounge with full-service bar and state-of-the-art presentation facilities; observation deck; mudroom with lockers for expedition gear; partially-covered furnished sundeck; plus open access to the Bridge, the Captain, officers and on-duty wildlife spotters.

Meals

Meals are served in the dining room at a single seating with unassigned tables for an informal atmosphere and easy mingling. Menus feature sustainable choices, local where possible.

Cabins

50 outside cabins. All cabins face outside with windows, private bathroom, and climate controls. Cabins are equipped with Wi-Fi, phone, multiple electrical and USB outlets, and phones. Luxury linens and pillows. Botanically inspired shampoo, conditioner, shower gel, and lotion are all available in cabin bathrooms, as well as an Expedition Essential Kit. Hair dryers, complimentary insulated water bottles and a National Geographic Atlas are also available in each cabin.

Expedition Equipment

A fleet of 8 Zodiacs, 24 kayaks, paddleboards; an ROV, hydrophone, splash-cam, underwater video camera, video microscope; snorkeling gear and wet suits for all guests (where applicable).

Special Features

Lindblad-National Geographic certified photo instructor, undersea specialist and video chronicler. Internet access. Elevator. The design of the outside decks—with the perfect wildlife viewing platform. And the way the proximity of the Lounge to the deck gives you instant access to spontaneous sightings. Have your camera ready!

Wellness

A fitness center with elliptical, treadmill, weights, resistance bands; LEXspa treatment room, staffed by wellness specialists.



Self-Disinfecting Ships

ACT Clean Coat™ is a light-activated, self-disinfecting cleaning process that continuously breaks down viruses, bacteria, mold, and airborne allergens across all ship surfaces. Not only does this create a cleaner, healthier shipboard environment for guests and crew alike, but this non-toxic, chemical-free system also saves more than one million gallons of water each year in our cleaning procedures, and reduces our carbon footprint as well as the amount of plastic and waste in our supply chain.



National Geographic Venture

Guests 100	Cabins 50
----------------------	---------------------

The *National Geographic Venture* is a state-of-the-art expedition ship ideal for discovering remote locations in domestic waters.

Following the build of *National Geographic Quest* at Nichols Brothers shipyard, her sister ship the 100 guest *National Geographic Venture* floated into the bay on Whidbey Island, becoming the 4th ship in the Lindblad fleet built at this storied PNW shipyard. In the 1970s, Nichols Brothers built the twin ships *National Geographic Sea Bird* and *National Geographic Sea Lion*, which continue to sail the waters of the west coast of North America and Central America.

Venture, like much of the wildlife she follows, is migratory. She follows the seasons from Alaska, along the coast of British Columbia, up the Columbia & Snake Rivers, and along the Baja coast and into the Sea of Cortez. In each region, her design innovations were informed by 50+ years of expedition expertise to ensure extraordinary discoveries. Larger than her sibling twin ships, *National Geographic Sea Bird* and *National Geographic Sea Lion*, *National Geographic Venture* has the same shallow draft, enabling her to nimbly navigate the same inner reaches and provide the same intimate, 'insider' experiences of the charismatic regions we explore.

Like her sister ship *National Geographic Quest*, *National Geographic Venture* has dual boarding platforms, enabling our team to load two Zodiacs at once means guests get off ship quickly, to take advantage of wildlife sightings and maximize exploring time. Modern, cleaned-lined, with large expanses of glass to keep you connected to the extraordinary views, *National Geographic Venture* enables you to see, do and experience the best of her geographies.



Cabin Categories

Category 1

Main Deck: #301-306

Cabins feature two single beds that can convert to a Queen, a writing desk, two nightstands and two portholes, full length mirror, and reading lights.



Category 2

Main Deck: #307-315

Cabins feature two single beds that can convert to a Queen, a writing desk, two nightstands and two portholes, full length mirror, and reading lights.



Category 3

Upper Deck: #201-206

Cabins feature two single beds that can convert to a Queen, a writing desk, two nightstands, a large view window, full-length mirror, and reading lights.



Category 4

Upper Deck: #207-229

Cabins feature two single beds that can convert to a Queen, a writing desk, closet, two nightstands, full-length mirror, reading lights, sliding glass door, and a small, private balcony.



Note: Solo occupancy cabins are available in Categories 1 and 2 only. Third person rates are available in Category 5 cabins at one half the double occupancy rate.

Connecting Cabins via internal doorway access:

Main Deck: #312-314, #311-315, #306-307;
Upper Deck: #224-226, #225-227

Category 5

Observation Deck: #101-108 (SUITE)

Cabins feature two single beds that can convert to a Queen, large view windows, closet, two nightstands, full-length mirror, reading lights, a suite-sized expanded bathroom, writing desk, ample storage space, and a convertible sofa bed to accommodate a third person.



Observation Deck

Category 5

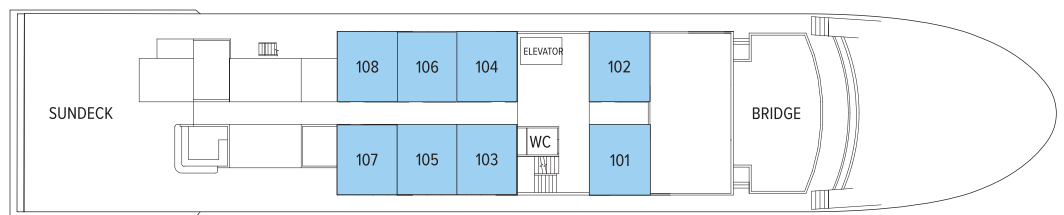

Lounge Deck

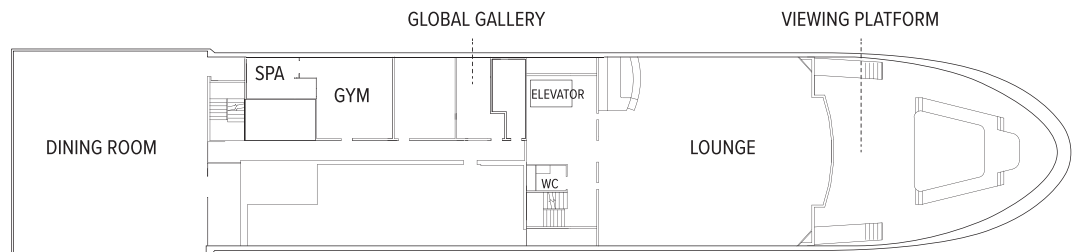

Upper Deck

Category 3

Category 4

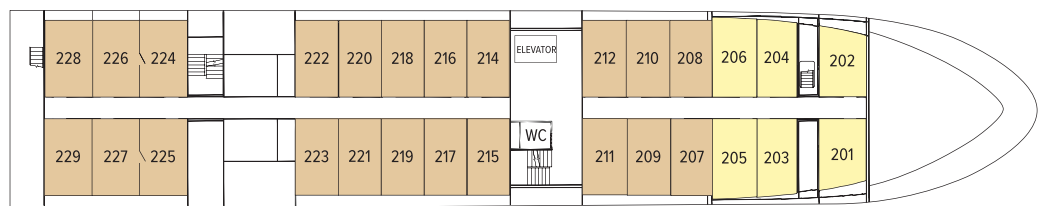

Main Deck

Category 1

Category 2

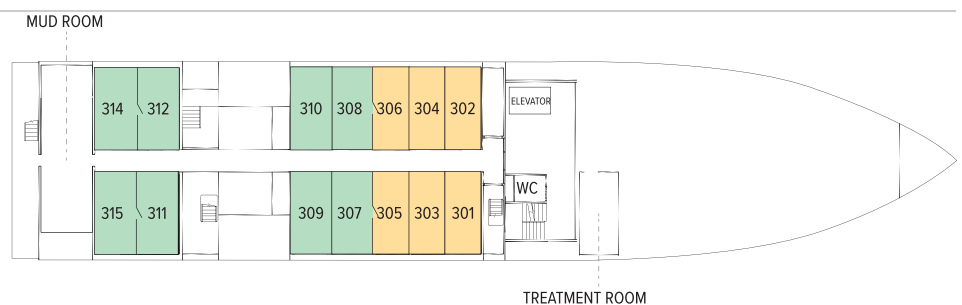

Ship amenities

Public Areas

Reception; main dining area; global gallery; fitness center; lounge with full-service bar and state-of-the-art presentation facilities; observation deck; mudroom with lockers for expedition gear; partially-covered furnished sundeck; plus open access to the Bridge, the Captain, officers and on-duty wildlife spotters.

Meals

Meals are served in the dining room at a single seating with unassigned tables for an informal atmosphere and easy mingling. Menus feature sustainable choices, local where possible.

Cabins

50 outside cabins. All cabins face outside with windows, private bathroom, and climate controls. Cabins are equipped with Wi-Fi, phone, multiple electrical and USB outlets, and phones. Luxury linens and pillows. Botanically inspired shampoo, conditioner, shower gel, and lotion are all available in cabin bathrooms, as well as an Expedition Essential Kit. Hair dryers, complimentary insulated water bottles and a National Geographic Atlas are also available in each cabin.

Expedition Equipment

A fleet of 8 Zodiacs, 24 kayaks, paddleboards; an ROV, hydrophone, splash-cam, underwater video camera, video microscope; snorkeling gear and wet suits for all guests (where applicable).

Special Features

Lindblad-National Geographic certified photo instructor, undersea specialist and video chronicler. Internet access. Elevator. The design of the outside decks—with the perfect wildlife viewing platform. And the way the proximity of the Lounge to the deck gives you instant access to spontaneous sightings. Have your camera ready!

Wellness

A fitness center with elliptical, treadmill, weights, resistance bands; LEXspa treatment room, staffed by wellness specialists.



Self-Disinfecting Ships

ACT Clean Coat™ is a light-activated, self-disinfecting cleaning process that continuously breaks down viruses, bacteria, mold, and airborne allergens across all ship surfaces. Not only does this create a cleaner, healthier shipboard environment for guests and crew alike, but this non-toxic, chemical-free system also saves more than one million gallons of water each year in our cleaning procedures, and reduces our carbon footprint as well as the amount of plastic and waste in our supply chain.

Special Offers

GIFT OF EXPLORATION: \$500 CREDIT

Book from December 3, 2024, to March 4, 2025. Receive a credit of \$500 per person on select departures, deducted from cabin fare prior to any additional applicable savings with the purchase of cabin fare. Valid for new bookings only on select departures, subject to availability, not applicable on airfare or extensions and may not be combined with other offers. Call for details.

GIFT OF EXPLORATION: FREE AIR UP TO \$1,000 PER CHILD

Free economy air up to \$1,000 per child per adult based on select departures. Book from December 3 to December 31, 2024, and receive free economy round trip air for one child per adult up to \$1,000 based on select departures. The offer is valid for 1 child per adult. Free Kids Air Offer must be communicated at time of booking by quoting "KID INCLUDED". To qualify for the offer, airfare must be ticketed by Lindblad Expeditions and is for economy class air only. Any upgrades or additional classes are not included. Offer may be applied to any recommended air Lindblad offers. Offer is valid for new bookings only, on select departures, subject to availability, may not be combined with other offers. Baggage fees may incur additional costs and seat assignments may not be guaranteed. Call for details.

GIFT OF EXPLORATION: 40% SOLO SAVINGS

Book from December 3, 2024, to March 4, 2025. Save 40% on solo cabins on select departures. Solo savings are subject to availability. Other expeditions may be available with a solo saving. Not applicable on airfare or extensions and may not be combined with

other offers. A full list of solo savings is available via expeditions.com or call for details.

GIFT OF EXPLORATION: ADDITIONAL 5% SAVINGS WHEN YOU PAY IN FULL

Book from December 3, 2024, to March 4, 2025. Save an additional 5% on the cabin fare on select departures when you pay in full at time of booking. To qualify for the discount, non-refundable payment in full is due at the time of booking. Valid for new bookings only on select departures, subject to availability, not applicable on airfare or extensions and may not be combined with other offers. Call for details.

SUITE EXCLUSIVES

Spacious living areas and incredible views immerse you in the beauty of your marine surroundings. Our new Suite Exclusives package helps make your voyage all the more memorable. [Learn more](#)

SAVE 5% TRAVELING AS A GROUP

Save 5% when traveling as a group of eight or more people. Valid on voyage fares only and not applicable on extensions or airfare. Deposit, final payments, and cancellation policies for group travel vary from our regular policies. Valid for new bookings only, subject to availability, and may not be combined with other offers. Call for details.

COMBINING OFFERS

Certain offers may be combinable, up to two savings opportunities, except where noted otherwise. For example, travel with a group of 8 or more on back-to-back expeditions, and take advantage of both savings.

Included in price

All accommodations aboard ship or in hotels per itinerary; all meals as indicated in the itinerary, both aboard and onshore; beer and wine on all 2023 departures (starting in 2024, spirits and cocktails are also included, with super premium wines and liquors available for purchase); hors d'oeuvres, 24-hour access to snacks, premium coffees and teas, non-alcoholic beverages, and filtered water; excursions and airport transfers to and from recommended flights, as indicated in the itinerary; exploration tools curated to destination, such as Zodiacs, stand-up paddleboards, kayaks; guidance and company of our leading expedition staff; assistance by the Lindblad Expeditions-National Geographic certified photo instructor; access to the OM System Photo Gear Locker; presentations by expedition staff and expert guest speakers; complimentary reusable water bottle; services of a physician, physician's assistant, nurse practitioner, or paramedic; morning stretch classes and 24-hour access to exercise equipment; 24-hour access to lounges, observation decks, library, and other shared spaces; park and site entrance fees, special access permits, and port taxes. Unused services or items included in our programs are non-refundable.

Not included in price

Airfare (except flights when indicated as included); pre- and post-expedition extensions; scuba diving for pre-qualified divers (available at additional cost); additional hotel nights (except when indicated as included); crew gratuities; private transfers; laundry, spa treatments, Wi-Fi, and phone services (except when indicated as included); travel protection plans; and passport, visa, and immigration fees.

Travel protection plan

We strongly recommend our guests to take advantage of our Travel Protection Plan. This plan offers comprehensive coverage to protect you from cancellation fees, costs incurred due to trip delays/interruption, damage or loss of baggage, medical assistance, and evacuation during your travels. Our Travel Protection Plan is available for U.S. residents only, and may be purchased any time prior to final payment due date, Travel Protection premiums are non-refundable once plan is purchased. Learn more about our Travel Protection "Plus" Plan: <https://www.expeditions.com/>

[terms-conditions/travel-protection-plan/](#)

Cancellation policy

Review our cancellation policy: <https://www.expeditions.com/cancellation-policy/>