







# Norway's Fjords and Arctic Svalbard

Sail Norway’s beautiful fjord-carved coast from colorful Bergen past the North Cape to remote Trømso, gateway to the Arctic. Glide into dramatic narrow straits and survey secluded inlets and coves by kayak and Zodiac. Experience the seabird spectacle of Bear Island, cross the Barents Sea, and spend five days exploring the icy wilderness of the Svalbard archipelago in the midnight sun above the Arctic Circle—where polar bears prowl and walrus lumber. A choice of activities allows guests to tailor their days as they see fit and experience an extraordinary adventure in Norway’s coastal wonderland.

From  
**\$ 24,607** / per person  
Does not include flights

 <b>DATES</b> May	 <b>DURATION</b> 16 Days
 <b>SHIPS</b> National Geographic Resolution National Geographic Endurance	
 <b>STARTS AT</b> Bergen, Norway	 <b>ENDS AT</b> Longyearbyen, Svalbard, Norway

## Highlights

- ★ Sail into Norway's spectacular fjords and discover the pristine beauty of secluded inlets and coves by kayak, Zodiac, or on foot
- ★ Explore the northern fjords and ice-carved narrows, standing on the ship's bow as the captain noses up to towering glaciers and waterfalls
- ★ Hike, walk, and kayak through stunning scenery and coastal fishing villages
- ★ Survey the wilderness and ice of Svalbard to see Arctic wildlife, including polar bears in their natural habitat, plus reindeer, arctic foxes, fur seals, and rookeries teeming with thousands of birds







## Day by day

### ■ DAY 1

#### Bergen, Norway / Embark Ship

Arrive in the colorful port town of Bergen, the gateway to the Norwegian fjords. Stroll historic Bryggens Wharf, a UNESCO World Heritage site, before embarkation.

Meals included: lunch, dinner

### ◇ DAY 2

#### Nordfjord

Arrive at the spectacular glacial mountain landscape of Nordfjord, a haven for adventurers and photographers. Travel up the Loen Valley by coach amidst picture-book beauty, surrounded by a turquoise lake and craggy peaks. Consider hiking a trail through the valley carved by the Briksdal Glacier. Alternatively, take a scenic boat ride across Kjenndal Lake to catch a glimpse of this retreating glacier and the striking geography of the region. Capture these scenic peaks and valleys from the railing as we sail back out of the fjord in the afternoon.

Meals included: breakfast, lunch, dinner

### ◇ DAYS 3-5

#### Exploring the Fjords of Norway

Spend three days exploring the central Norway coast, revered by travelers worldwide for its mountainous islands and steep-walled fjords. Your expedition leader and captain will consult with local Norwegian pilots on landing spots offering optimal adventure options. Zodiac under vertical rock faces, paddle serenely in a deep fjord surrounded by cascading waterfalls, or venture ashore for hikes with our naturalist staff. Visit local island communities protecting their cultural and natural heritage and go for walks with resident guides that have grown up

surrounded by the ocean and these remote coastal islands.

Meals included: breakfast, lunch, dinner

### ◇ DAY 6

#### Lofoten Islands

The Lofoten archipelago boasts an enchanting landscape of picturesque villages ringed by jagged granite peaks. Enjoy village walks and island explorations as we venture through an area known for its dramatic landscapes and its cod fishing traditions throughout the centuries. A bit later, admire one of Norway's most dramatic fjords from the deck as we glide through Trollfjorden.

Meals included: breakfast, lunch, dinner

### ◇ DAY 7

#### Tysfjorden

Our nimble ship enters Tysfjorden, where mile after mile of near-vertical walls ascend above us and a scant few villages manage to cling to the rocky shores. Enjoy a Zodiac cruise or kayak within this magical place alive with birch forests and tumbling waterfalls. Explore a hiking trail through Hellemobotn Valley that reaches almost to the Swedish border.

Meals included: breakfast, lunch, dinner

### ◇ DAY 8

#### Tromsø

Arrive in Tromsø, known as the "gateway to the Arctic" for numerous Arctic expeditions that originated from here. Explore this charming coastal city and its surrounding area: choose a visit to a local husky farm—known for its beautiful setting, friendly dogs, and world-caliber dog musher—or choose to stay in town and visit the waterfront



museums, which offer a range of local food tastings and historical insights into the variable aspects of this dynamic region.

Meals included: breakfast, lunch, dinner

◇ DAY 9

## Bear Island

Zodiac cruise around mist-shrouded Bear Island, a remote birdwatcher's paradise housing one lonely meteorological station—and countless thousands of fulmars, kittiwakes, guillemots, and gulls. It's the southernmost member of the Svalbard archipelago and sits at the confluence of the Norwegian and Barents Seas.

Meals included: breakfast, lunch, dinner

◇ DAYS 10-14

## Exploring Svalbard

We operate in true expedition style, letting nature dictate our day-to-day movements within an immense Arctic wonderland. Our fully stabilized, ice-class expedition ship probes deep into the ice where the polar bears forage, walrus sun themselves, and the Svalbard reindeer roam. Join our spotters on the Bridge as we scan the floes and islands for these iconic creatures, along with bearded and ringed seals; Arctic fox; and whales that call these waters home, like beluga, fin, and minke. There's no greater thrill than a sighting that brings everyone rushing to the bow or Bridge for a close-up view.

Sail deep into protected bays and fjords, where even a novice kayaker can comfortably paddle surrounded by sparkling bergs and dramatic mountains. Video from our Remotely Operated Vehicle (ROV) allows you to peer into the mysterious world that exists 1,000 feet below us during Recaps with our multi-talented field staff.

Meals included: breakfast, lunch, dinner

◇ DAY 15

## Longyearbyen / Disembark Ship / Oslo

Disembark in Longyearbyen for one more taste of civilization in this northern frontier. Fly back to Oslo on a private charter flight, enjoy dinner with fellow guests, and overnight at the Radisson Blu Airport Hotel.

Meals included: breakfast, lunch, dinner

■ DAY 16

## Oslo / Home

After breakfast at the hotel, proceed to the airport for flights home.

Meals included: breakfast

**National Geographic Endurance (Northbound)**

Bergen, Norway → Longyearbyen, Svalbard,  
Norway

**2025 Departure Dates**

Aboard *National Geographic Endurance*

25 May		
--------	--	--

**Alternative Routes**

Visit [Expeditions.com](http://Expeditions.com) for more information.

**2025 Departure Dates**

13 May, 28 May





## ***National Geographic Resolution***

---

**Guests**

138

**Cabins**

76

---

**The sister ship to *National Geographic Endurance*,  
she explores polar & temperate regions**

Our second new polar build, *National Geographic Resolution*, is named to honor the second voyage of the legendary Captain James Cook.

A fully-stabilized vessel of the highest ice class (PC5 Category A), she will enable adventurous guests to go where few have or can. *Resolution's* most striking exterior feature is her distinctive profile, the patented X-Bow®, a game-changing design that guarantees the smoothest, most comfortable ride in all kinds of conditions; and since it eliminates bow impact, a quieter ride, as well.



An equally impressive feature may well be her capacity: she carries just 138 guests, a commitment to expedition excellence over scale. Scandinavian-inflected, luxuriously appointed, her inviting interiors would be a destination in themselves. Because she is a Lindblad expedition ship, however, her attention is focused on the world outside— with acres of window glass to keep you connected to the stunning views beyond the pane, and a fleet of expedition tools to get you out exploring.

*National Geographic Endurance* and *National Geographic Resolution* are next-generation expedition ships. Purpose-built for polar navigation. Fully stabilized, highly strengthened, ice-class Polar Code PC5 (Category A) vessels, they are designed to navigate polar passages year-round, and safely explore uncharted waters, while providing exceptional comfort. The patented X-bow<sup>®</sup> is key to their design; its powerful wave-slicing action provides an extremely smooth ride even in adverse conditions, and even reduces spray on deck for superior observation. They carry a full suite of expedition tools, and offer a variety of experience enhancing amenities.





# Cabin Categories

## Category 1

**Fore Deck:** #406, 408, 411, 413, 415

Fore Deck, with two large windows, two singles that can convert to a queen, armchair, writing desk and chair, two bedside tables, window sofa, and a closet.



## Category 2

**Fore Deck:** #410, 412, 414, 416-419, 421-427

Fore Deck, with two large windows, two single beds that can convert to a queen, window sofa, 2 seat sofa, coffee table, armchair, writing desk with an office chair, two bedside tables, and a closet.



## Category 3

**Main Deck:** #512-524

Suite with balcony that features two balcony chairs, hammock, and a table; two single beds that convert to a queen, convertible sleeper sofa, writing desk with a chair, two bedside tables, and a closet.



## Category 4

**Lounge Deck:** #608, 610, 612, 613-623

Suite with balcony that features two balcony chairs, hammock, and a table; two single beds that convert to a queen, convertible sleeper sofa, writing desk with a chair, two bedside tables, and a closet.



## Category 5

**Bridge Deck:** #700-707, 712, 713, 715, 717

Cabin with balcony that features two balcony chairs, hammock, and a table; two single beds that convert to a queen; convertible sleeper sofa; coffee table; writing desk with chair; two bedside tables; and a closet.



## Category 6

**Bridge Deck:** #714

Junior suite with balcony that features two balcony chairs, hammock, and table; two single beds that convert to a queen; pull-out sofa; writing desk with chair; two bedside tables; coffee table; espresso maker; and a closet. Guests receive a welcome amenity, complimentary laundry, priority access to one igloo reservation, and one spa appointment per departure.

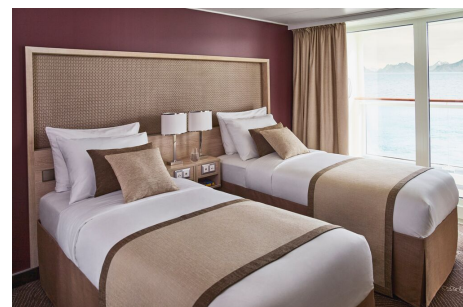

## Category 7

**Bridge Deck:** #708-711, 716, 718, 719, 721

These large balcony suites feature two balcony chairs, hammock, and table; two single beds that can convert to a queen; pull-out sofa; coffee table; writing desk and chair; espresso maker; hammock; and a large walk-in closet with full length mirror. Expanded bathroom has a double vanity, bathtub, towel warmer, and rain shower. Guests receive a welcome amenity, complimentary laundry, priority access to one igloo reservation, and one spa appointment per departure.

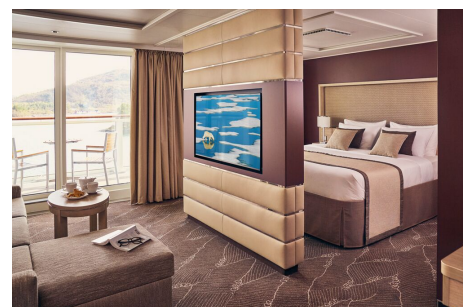

## Category A Solo

**Main Deck:** #504-510, 513

Suite with balcony that features two balcony chairs and a table; single bed, writing desk with an office chair, bedside table, and a closet.



## Category B Solo

**Lounge Deck:** #604-607, 609, 611

Suite with balcony that features two balcony chairs, hammock, and a table; single bed, bedside table, writing desk with chair, hammock, and a closet.





## Observation Deck

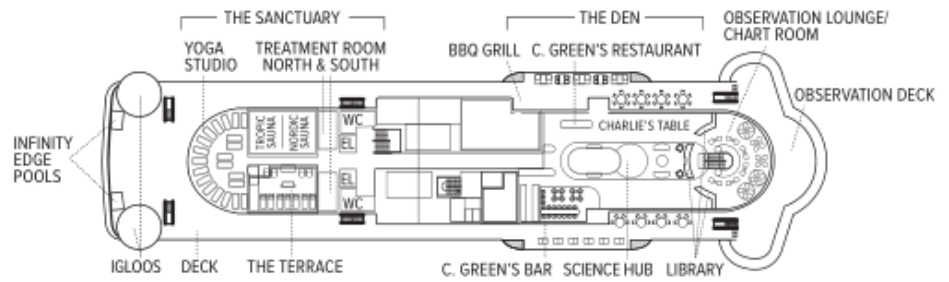

## Bridge Deck

- Category 5
- Category 6
- Category 7

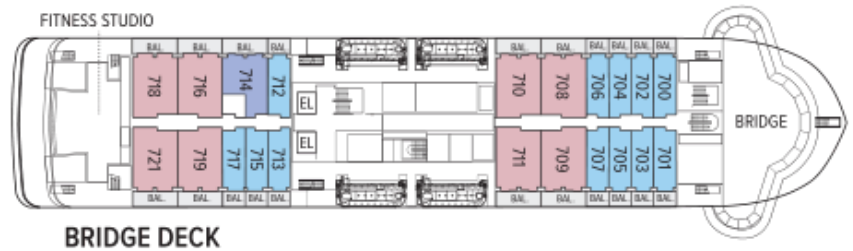

## Lounge Deck

- Category 4
- Category B Solo



## Main Deck

- Category 3
- Category 2 Solo



## Fore Deck

- Category 1
- Category 2



## Expedition Deck

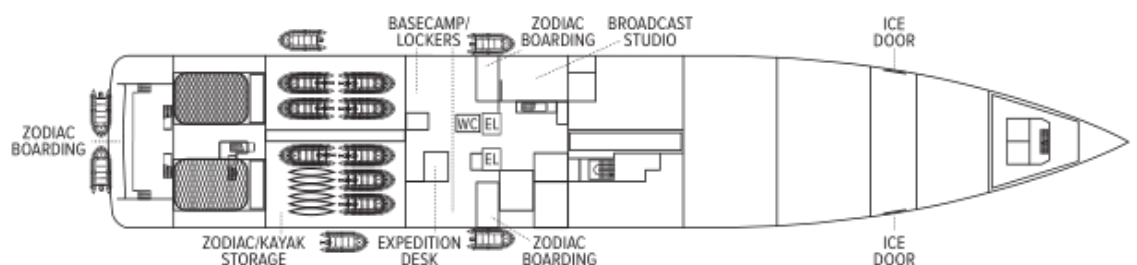

# Ship amenities

## Public Areas

Reception; three dining areas; an observation lounge with bar, gym, wellness area, infinity-style outdoor hot tubs with adjacent igloos; library; main lounge with full service bar, 24-hour beverage station, state-of-the-art tech for films/presentations; B&H Photo locker and a photo workshop area; science hub; an onboard broadcast studio; an expedition base with lockers for expedition gear; and open access to the Bridge, Captain, officers and on-duty wildlife spotters.

## Meals

Restaurant 270° features wrap-around views; two other dining areas offer lighter, made-to-order fare or intimate, small group dinners. All feature sustainable choices, local where possible, and unassigned, flexible, inclusive seating.

## Cabins

All cabins face outside with large windows, private bathroom, and climate controls. Cabins are equipped with expedition command centers with iPad tablets, multiple electrical and USB outlets, TVs, with on demand entertainment, phone, Wi-Fi, clock, barometers, hygrometers, vanity mirror, mini refrigerator, small safe, ice bucket, glasses, hair dryer, reading lights and National Geographic Atlas. Luxury linens and pillows. Bathrooms outfitted with Rain showers & hand held shower, botanically inspired shampoo, conditioner, shower gel and lotion. Complimentary insulated water bottles. Balcony cabins have hammocks, chairs and table.

## Expedition Equipment

Zodiac landing craft, kayaks, snowshoes, cross-country skis, an ROV and underwater video camera for unique access to the polar undersea, hydrophone, aerial remote-controlled camera and video microscope.

## Special Features

A full-time doctor, undersea specialist, National Geographic photographer, Lindblad-National Geographic certified photo instructor and video chronicler, an internet cafe and laundry. A forward and aft staircase, and elevators, reach all decks. Echoing the pioneering installation aboard *National Geographic Endurance*, artist Zaria Forman has curated a new exhibit, featuring a wide range of artists.



## Wellness

A glass-enclosed yoga studio, gym, treatment rooms and spa relax area, and high and low-heat saunas with ocean views, staffed by wellness specialists.

## Self-Disinfecting Ships

ACT Clean Coat™ is a light-activated, self-disinfecting cleaning process that continuously breaks down viruses, bacteria, mold, and airborne allergens across all ship surfaces. Not only does this create a cleaner, healthier shipboard environment for guests and crew alike, but this non-toxic, chemical-free system also saves more than one million gallons of water each year in our cleaning procedures, and reduces our carbon footprint as well as the amount of plastic and waste in our supply chain.



## National Geographic Endurance

---

Guests	Cabins
138	76

---

The most advanced ice-class expedition ship afloat, the *National Geographic Endurance* offers unprecedented access to polar regions.

The first new polar build in Lindblad's 50-year history, *National Geographic Endurance* is named to honor explorer Ernest Shackleton and his legendary Transantarctic Expedition.

A fully-stabilized vessel of the highest ice class (PC5 Category A), she will enable adventurous guests to go where few have or can. Endurance's most striking exterior feature is her distinctive profile, the patented X-Bow®, a game-changing design that guarantees the smoothest, most comfortable ride in all kinds of conditions; and since it eliminates bow impact, a quieter ride, as well.



An equally impressive feature may well be her capacity: she carries just 138 guests, a commitment to expedition excellence over scale. Scandinavian-inflected, luxuriously appointed, her inviting interiors would be a destination in themselves. Because she is a Lindblad expedition ship, however, her attention is focused on the world outside—with acres of window glass to keep you connected to the stunning views beyond the pane, and a fleet of expedition tools to get you out exploring.

*National Geographic Endurance* and *National Geographic Resolution* are next-generation expedition ships. Purpose-built for polar navigation. Fully stabilized, highly strengthened, ice-class Polar Code PC5 (Category A) vessels, they are designed to navigate polar passages year-round, and safely explore uncharted waters, while providing exceptional comfort. The patented X-bow<sup>®</sup> is key to their design; its powerful wave-slicing action provides an extremely smooth ride even in adverse conditions, and even reduces spray on deck for superior observation. They carry a full suite of expedition tools, and offer a variety of experience enhancing amenities.





# Cabin Categories

## Category 1

**Fore Deck:** #406, 408, 411, 413, 415

Fore Deck, with two large windows, two singles that can convert to a queen, armchair, writing desk and chair, two bedside tables, window sofa, and a closet.



## Category 2

**Fore Deck:** #410, 412, 414, 416-419, 421-427

Fore Deck, with two large windows, two single beds that can convert to a queen, window sofa, 2 seat sofa, coffee table, armchair, writing desk with an office chair, two bedside tables, and a closet.



## Category 3

**Main Deck:** #512-524

Suite with balcony that features two balcony chairs, hammock, and a table; two single beds that convert to a queen, convertible sleeper sofa, writing desk with a chair, two bedside tables, and a closet.



## Category 4

**Lounge Deck:** #608, 610, 612, 613-623

Suite with balcony that features two balcony chairs, hammock, and a table; two single beds that convert to a queen, convertible sleeper sofa, writing desk with a chair, two bedside tables, and a closet.



## Category 5

**Bridge Deck:** #700-707, 712, 713, 715, 717

Cabin with balcony that features two balcony chairs, hammock, and a table; two single beds that convert to a queen; convertible sleeper sofa; coffee table; writing desk with chair; two bedside tables; and a closet.



## Category 6

**Bridge Deck:** #714

Junior suite with balcony that features two balcony chairs, hammock, and table; two single beds that convert to a queen; pull-out sofa; writing desk with chair; two bedside tables; coffee table; espresso maker; and a closet. Guests receive a welcome amenity, complimentary laundry, priority access to one igloo reservation, and one spa appointment per departure.



## Category 7

**Bridge Deck:** #708-711, 716, 718, 719, 721

These large balcony suites feature two balcony chairs, hammock, and table; two single beds that can convert to a queen; pull-out sofa; coffee table; writing desk and chair; espresso maker; hammock; and a large walk-in closet with full length mirror. Expanded bathroom has a double vanity, bathtub, towel warmer, and rain shower. Guests receive a welcome amenity, complimentary laundry, priority access to one igloo reservation, and one spa appointment per departure.



## Category A Solo

**Main Deck:** #504-510, 513

Suite with balcony that features two balcony chairs and a table; single bed, writing desk with an office chair, bedside table, and a closet.



## Category B Solo

**Lounge Deck:** #604-607, 609, 611

Suite with balcony that features two balcony chairs, hammock, and a table; single bed, bedside table, writing desk with chair, hammock, and a closet.



## Observation Deck

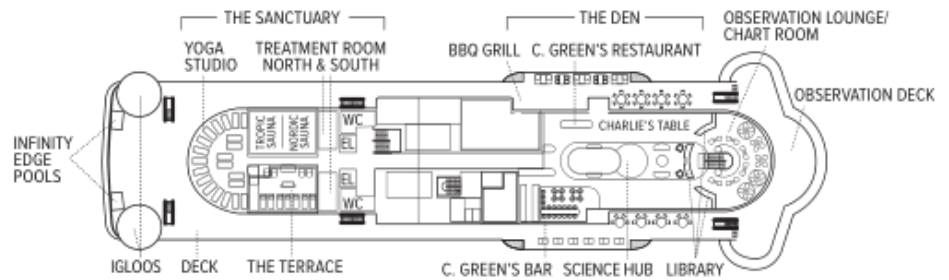

## Bridge Deck

- Category 5
- Category 6
- Category 7

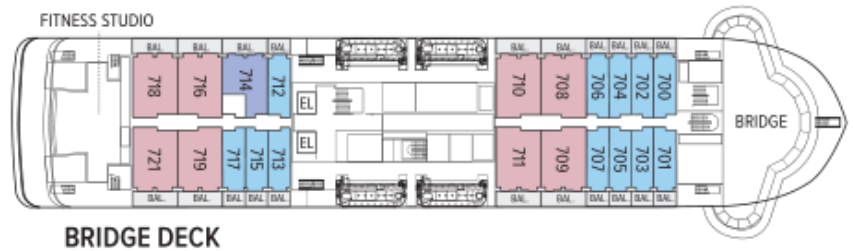

## Lounge Deck

- Category 4
- Category B Solo



## Main Deck

- Category 3
- Category 2 Solo



## Fore Deck

- Category 1
- Category 2



## Expedition Deck

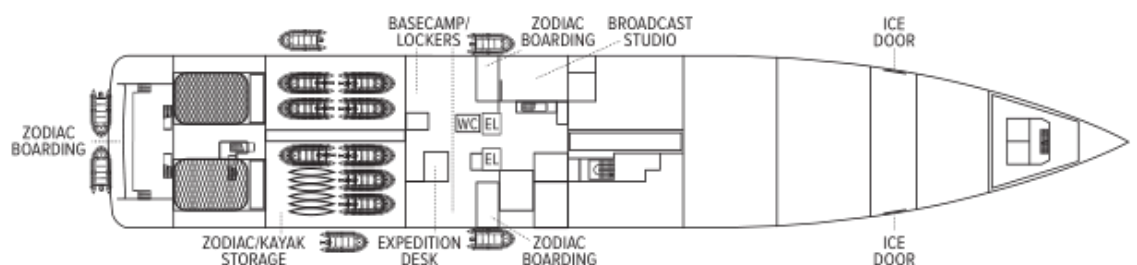



# Ship amenities

## Public Areas

Reception; three dining areas; an observation lounge with bar, gym, wellness area, infinity-style outdoor hot tubs with adjacent igloos; library; main lounge with full service bar, 24-hour beverage station, state-of-the-art tech for films/presentations; B&H Photo locker and a photo workshop area; science hub; an onboard broadcast studio; an expedition base with lockers for expedition gear; and open access to the Bridge, Captain, officers and on-duty wildlife spotters.

## Meals

Restaurant 270° features wrap-around views; two other dining areas offer lighter, made-to-order fare or intimate, small group dinners. All feature sustainable choices, local where possible, and unassigned, flexible, inclusive seating.

## Cabins

All cabins face outside with large windows, private bathroom, and climate controls. Cabins are equipped with expedition command centers with iPad tablets, multiple electrical and USB outlets, TVs, with on demand entertainment, phone, Wi-Fi, clock, barometers, hygrometers, vanity mirror, mini refrigerator, small safe, ice bucket, glasses, hair dryer, reading lights and National Geographic Atlas. Luxury linens and pillows. Bathrooms outfitted with Rain showers & hand held shower, botanically inspired shampoo, conditioner, shower gel and lotion. Complimentary insulated water bottles. Balcony cabins have hammocks, chairs and table.

## Expedition Equipment

Zodiac landing craft, kayaks, snowshoes, cross-country skis, an ROV and underwater video camera for unique access to the polar undersea, hydrophone, aerial remote-controlled camera and video microscope.

## Special Features

A full-time doctor, undersea specialist, National Geographic photographer, Lindblad-National Geographic certified photo instructor and video chronicler, an internet cafe and laundry. A forward and aft staircase, and elevators, reach all decks. Echoing the pioneering installation aboard *National Geographic Endurance*, artist Zaria Forman has curated a new exhibit, featuring a wide range of artists.



## Wellness

A glass-enclosed yoga studio, gym, treatment rooms and spa relax area, and high and low-heat saunas with ocean views, staffed by wellness specialists.

## Self-Disinfecting Ships

ACT Clean Coat™ is a light-activated, self-disinfecting cleaning process that continuously breaks down viruses, bacteria, mold, and airborne allergens across all ship surfaces. Not only does this create a cleaner, healthier shipboard environment for guests and crew alike, but this non-toxic, chemical-free system also saves more than one million gallons of water each year in our cleaning procedures, and reduces our carbon footprint as well as the amount of plastic and waste in our supply chain.



## Special Offers

### SUITE EXCLUSIVES

Spacious living areas and incredible views immerse you in the beauty of your marine surroundings.

Our new Suite Exclusives package helps make your voyage all the more memorable. [Learn more](#)

---

### 10% OFF BACK-TO-BACK VOYAGES

Save 10% on consecutive departures, applicable on voyage fares only and not valid on extensions or airfare. Valid for new bookings only, subject to availability, and may not be combined with other offers. Call for details.

---

### BRINGING THE KIDS

We believe sharing an expedition with children is a life-enhancing experience. Take \$500 off for each child under the age of 18 on any departure. Not applicable on extensions or airfare. Call for details.

---

### SAVE 5% TRAVELING AS A GROUP

Save 5% when traveling as a group of eight or more people. Valid on voyage fares only and not applicable on extensions or airfare. Deposit, final payments, and cancellation policies for group travel vary from our regular policies. Valid for new bookings only, subject to availability, and may not be combined with other offers. Call for details.

---

### COMBINING OFFERS

Certain offers may be combinable, up to two savings opportunities, except where noted otherwise.

For example, travel with a group of 8 or more on back-to-back expeditions, and take advantage of both savings.

## Included in price

All accommodations aboard ship or in hotels per itinerary; all meals as indicated in the itinerary, both aboard and onshore; beer, wine, cocktails, and spirits aboard the ship (except certain super premium brands which are available for purchase); hors d'oeuvres, 24-hour access to snacks, premium coffees and teas, non-alcoholic beverages, and filtered water; excursions and airport transfers to and from recommended flights, as indicated in the itinerary; crew gratuities; exploration tools curated to destination, such as Zodiacs, kayaks, guidance and company of our leading expedition staff; assistance by the National Geographic Photography Expert and Lindblad Expeditions-National Geographic certified photo instructor; access to the OM System Photo Gear Locker; presentations by expedition staff and expert guest speakers; complimentary parka or jacket, complimentary reusable water bottle; services of a physician, physician's assistant, nurse practitioner, or paramedic; morning stretch classes and 24-hour access to exercise equipment; 24-hour access to lounges, observation decks, library, and other shared spaces; park and site entrance fees, special access permits, and port taxes. Unused services or items included in our programs are non-refundable.

## Not included in price

Airfare (except flights when indicated as included); pre- and post-expedition extensions; additional hotel nights (except when indicated as included); private transfers; laundry, spa treatments, Wi-Fi, and phone services (except when indicated as included); travel protection plans; and passport, visa, and immigration fees.

## Travel protection plan

We strongly recommend our guests to take advantage of our Travel Protection Plan. This plan offers comprehensive coverage to protect you from cancellation fees, costs incurred due to trip delays/interruption, damage or loss of baggage, medical assistance, and evacuation during your travels. Our Travel Protection Plan is available for U.S. residents only, and may be purchased any time prior to final payment due date, Travel Protection premiums are non-refundable once plan is purchased. Learn more about our Travel Protection "Plus" Plan: <https://www.expeditions.com/terms-conditions/travel-protection-plan/>

## Cancellation policy

Review our cancellation policy: <https://www.expeditions.com/cancellation-policy/>