



Atlantic Isles & Europe
37° 44' N 25° 40' W

Islands of the Azores: Basalt Peaks to Volcanic Vineyards

Towering basalt peaks, bubbling hot springs, emerald-green farmlands, fascinating seafaring history, world-class wine and cheese and captivating fado music—this is just some of the beauty and vitality you'll discover as we explore the dramatically beautiful Portuguese archipelago of the Azores aboard the state-of-the-art *National Geographic Endurance*.

From
\$ 10,940 / per person
Does not include flights



DATES

Apr



DURATION

9 Days



SHIPS

National Geographic Endurance



STARTS AT

Ponta
Delgada,
Azores,
Portugal



ENDS AT

Ponta
Delgada,
Azores,
Portugal

Highlights

- ★ Go whale-watching, follow scenic hiking trails, and learn of the volcanic history unique to the Azores
- ★ Soak up Azorean culture, sampling local wine and cheese, and dine on a delectable local specialty: a stew cooked underground by volcanic heat
- ★ Discover the varied past and the stories of explorers, whalers, and conquerors who all had a part in weaving the tapestry of island history
- ★ Experience the commitment the locals have to sustainable growth and protecting the natural beauty and ecosystems of the archipelago

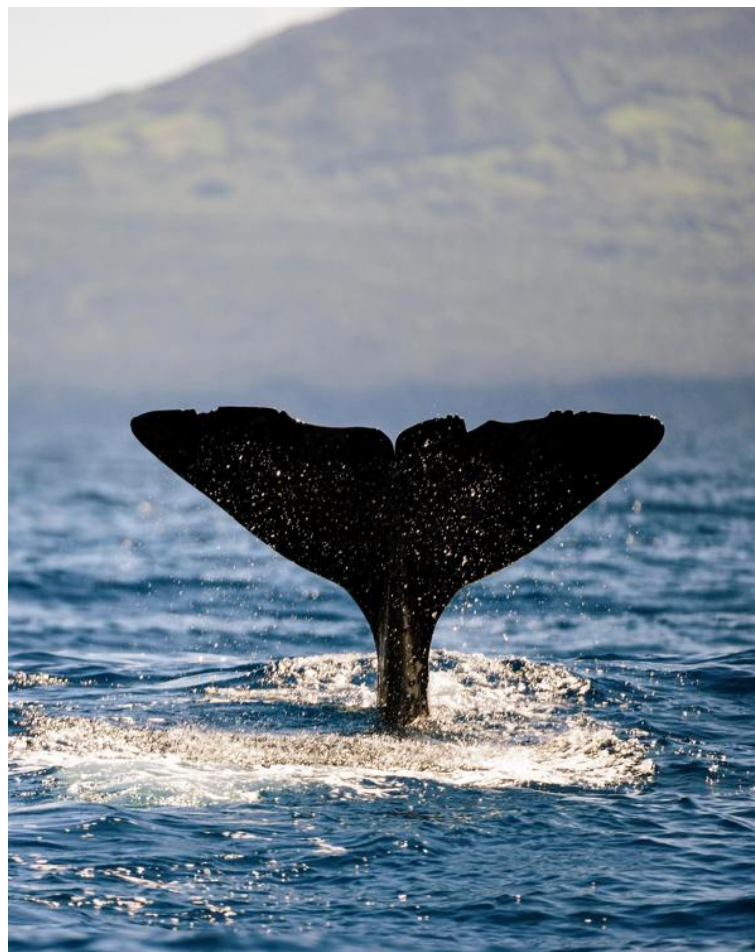

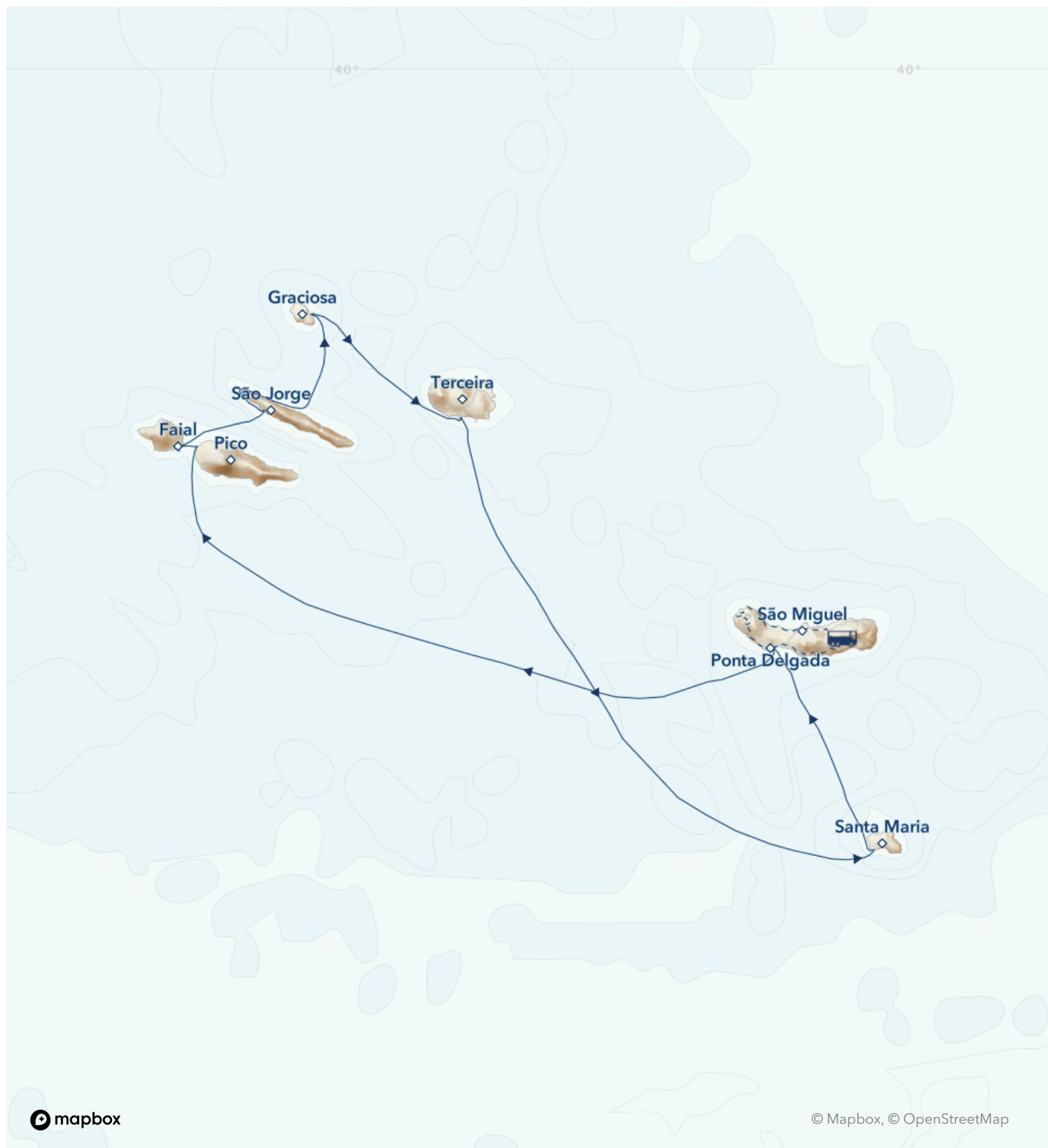

Day by day

■ DAY 1

São Miguel, Azores, Portugal / Embark Ship

Arrive in Ponta Delgada, on the island of São Miguel in the Azores, where we embark the *National Geographic Endurance*.

Arrival Time: Arrive before 9:00 a.m. local time.

Arrival City: Ponta Delgada, Azores

Meals included: lunch, dinner

◇ DAY 2

Pico

The tallest mountain on the Atlantic Ridge, the long dormant Ponta do Pico, is a defining feature of this beautiful island whose claims to fame are whaling history and wine. Visit the once-booming former whaling village Lajes do Pico and learn about the importance of the whaling industry to these islands at the Whalers' Museum. Then travel to the wine region, a UNESCO World Heritage site, where the moonscape terrain left by the lava flows has been painstakingly converted to vineyards. See the unlikely lava stone corrals that protect the precious vines before ending the day with a tasting of these very special wines.

Meals included: breakfast, lunch, dinner

◇ DAY 3

Faial

More than 20 types of cetaceans can be spotted in the waters surrounding the Azores, and today we go in search of these gentle giants in the channel north of Pico and Faial. A researcher from the biology department of Azores University will join us and share details of the university's ongoing studies

as we scan the sea. Once ashore on the island of Faial, we head to Capelinhos, where we can see how dramatically the landscape changed when its volcano erupted in 1957. Farms and villages were covered with ash, which added nearly an extra mile of land to the island.

Later, stroll in the marina, visit the excellent scrimshaw museum, and raise a glass at Peter Café Sport, a legendary pub where sea adventurers historically dropped off their mail. This evening enjoy a very special musical performance of achingly beautiful *fado*. The genre may trace its roots to mainland Portugal, but the islands have made it their own.

Meals included: breakfast, dinner, lunch

◇ DAY 4

São Jorge

This morning visit São Jorge, formed by volcanic fissures. An impressive mix of imposing sea cliffs and *fajãs*—coastal plateaus formed from lava flows—the island has fertile soil that supports picturesque grasslands and farms. On trails that crisscross the ridge and beaches, hike to Caldeira de Santo Cristo Lake, known for its clams; visit the small villages perched on the *fajãs*; explore the coffee and tea plantations; and taste world-renowned São Jorge cheese. Be on deck with your binoculars this afternoon as we sail around the tip of the island, passing cliffs with nesting sea birds and looking for Risso's dolphin and whales. We'll go ashore by Zodiac to explore the secluded saltwater lagoons of Fajã dos Cubres and Fajã de Santo Cristo, "Wetlands of International Importance."

Meals included: breakfast, lunch, dinner

◇ DAY 5

Graciosa

Aptly named, this “gracious” island has been designated a UNESCO Biosphere Reserve for the balance its inhabitants have achieved between the preservation of the geography and sustainable human development. Travel through a beautiful patchwork of farmland and vineyards dotted with windmills en route to the ancient village of Santa Cruz. At the natural monument Caldeira da Graciosa, we will see Furna do Enxofre, a unique lava cave and underground lake. Later, stroll through the village of Praia, enjoy the sweet pastry *queijada da Graciosa*, and soak up the tranquility of this quiet harbor. Weather permitting, we will explore the islet Ilhéu da Praia in Zodiacs and kayaks before ending the day with a presentation by a local historian who will set the stage for our visit to Terceira.

Meals included: breakfast, lunch, dinner

◇ DAY 6

Terceira

First settled by Portuguese navigators around 1450, Terceira became a popular port of call for merchant ships and the economic and religious center of the Azores. We will wind along the coastline and explore historic villages like Porto Judeu, a small fishing community; Sao Sebastiao, which has a notable 15th-century parish church; and Altares, with its quaint whitewashed houses capped with traditional chimneys and painted cones. Upland at Algar do Carvao, be amazed by a huge lava tube adorned with stalactites and stalagmites, and later stroll the streets of Praia da Vitoria. Or, take a walking tour with local guides to see the forts, palaces, churches, museums, and gardens of Angra do Heroismo. Step back in time in this 15th-century UNESCO World Heritage site and see firsthand the indelible mark left by the ancient explorers, conquerors, and religious leaders.

Meals included: breakfast, lunch, dinner

◇ DAY 7

Santa Maria

Today we will be joined by a local whale guide who will share centuries of expertise on a morning whale-watching expedition as we take to the waters in search of the islands’ many cetaceans. In the afternoon, we go ashore at Santa Maria, historically significant as the first landfall of Christopher Columbus on his return from the Americas in 1493. We’ll see a statue of the explorer in the village of Anjos and admire breathtaking vistas as we travel along the coast. Those who choose to hike the Pico Alto-Baía dos Anjos trail will travel from the highest point on the island to the sea to observe marine birds in their azure surroundings.

Meals included: breakfast, lunch, dinner

◇ DAY 8

São Miguel

Today we explore the Furnas Valley and its famed hot springs, hiking the trails or perhaps visiting a tea plantation or the lovely garden of Terra Nostra. Sample a typical Azorean dish for lunch: naturally cooked underground from the heat of volcanic activity, *cozido* is a dish made with a variety of meats and vegetables.

Meals included: breakfast, lunch, dinner

■ DAY 9

São Miguel / Disembark Ship

This morning we disembark and travel to Sete Cidades, a lovely village set amongst green and blue lakes. We will explore the lakes and village and conclude our expedition with a traditional Azorean lunch before transferring to the airport in Ponta Delgada.

Departure Time: Depart after 4:00 p.m. local time.

Departure City: Ponta Delgada, Azores

Meals included: lunch

Expedition

Ponta Delgada, Azores, Portugal → Ponta
Delgada, Azores, Portugal

2024 Departure Dates

Aboard *National Geographic Endurance*

30 Apr		
--------	--	--

2025 Departure Dates

Aboard *National Geographic Endurance*

02 Apr	10 Apr	18 Apr	
--------	--------	--------	--



National Geographic Endurance

Guests	Cabins
138	76

The most advanced ice-class expedition ship afloat, the *National Geographic Endurance* offers unprecedented access to polar regions.

The first new polar build in Lindblad's 50-year history, *National Geographic Endurance* is named to honor explorer Ernest Shackleton and his legendary Transantarctic Expedition.

A fully-stabilized vessel of the highest ice class (PC5 Category A), she will enable adventurous guests to go where few have or can. Endurance's most striking exterior feature is her distinctive profile, the patented X-Bow®, a game-changing design that guarantees the smoothest, most comfortable ride in all kinds of conditions; and since it eliminates bow impact, a quieter ride, as well.

An equally impressive feature may well be her capacity: she carries just 138 guests, a commitment to expedition excellence over scale. Scandinavian-inflected, luxuriously appointed, her inviting interiors would be a destination in themselves. Because she is a Lindblad expedition ship, however, her attention is focused on the world outside—with acres of window glass to keep you connected to the stunning views beyond the pane, and a fleet of expedition tools to get you out exploring.

National Geographic Endurance and *National Geographic Resolution* are next-generation expedition ships. Purpose-built for polar navigation. Fully stabilized, highly strengthened, ice-class Polar Code PC5 (Category A) vessels, they are designed to navigate polar passages year-round, and safely explore uncharted waters, while providing exceptional comfort. The patented X-bow[®] is key to their design; its powerful wave-slicing action provides an extremely smooth ride even in adverse conditions, and even reduces spray on deck for superior observation. They carry a full suite of expedition tools, and offer a variety of experience enhancing amenities.



Cabin Categories

Category 1

Fore Deck: #406, 408, 411, 413, 415

Fore Deck, with two large windows, two singles that can convert to a queen, armchair, writing desk and chair, two bedside tables, window sofa, and a closet.



Category 2

Fore Deck: #410, 412, 414, 416-419, 421-427

Fore Deck, with two large windows, two single beds that can convert to a queen, window sofa, 2 seat sofa, coffee table, armchair, writing desk with an office chair, two bedside tables, and a closet.



Category 3

Main Deck: #512-524

Suite with balcony that features two balcony chairs, hammock, and a table; two single beds that convert to a queen, convertible sleeper sofa, writing desk with a chair, two bedside tables, and a closet.



Category 4

Lounge Deck: #608, 610, 612, 613-623

Suite with balcony that features two balcony chairs, hammock, and a table; two single beds that convert to a queen, convertible sleeper sofa, writing desk with a chair, two bedside tables, and a closet.



Category 5

Bridge Deck: #700-707, 712, 713, 715, 717

Cabin with balcony that features two balcony chairs, hammock, and a table; two single beds that convert to a queen; convertible sleeper sofa; coffee table; writing desk with chair; two bedside tables; and a closet.



Category 6

Bridge Deck: #714

Junior suite with balcony that features two balcony chairs, hammock, and table; two single beds that convert to a queen; pull-out sofa; writing desk with chair; two bedside tables; coffee table; espresso maker; and a closet. Guests receive a welcome amenity, complimentary laundry, priority access to one igloo reservation, and one spa appointment per departure.

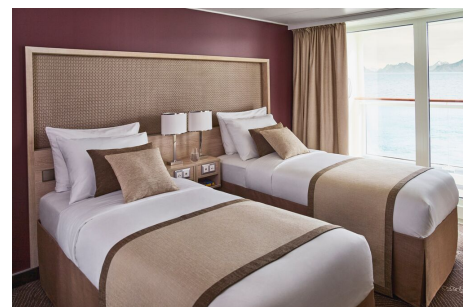

Category 7

Bridge Deck: #708-711, 716, 718, 719, 721

These large balcony suites feature two balcony chairs, hammock, and table; two single beds that can convert to a queen; pull-out sofa; coffee table; writing desk and chair; espresso maker; hammock; and a large walk-in closet with full length mirror. Expanded bathroom has a double vanity, bathtub, towel warmer, and rain shower. Guests receive a welcome amenity, complimentary laundry, priority access to one igloo reservation, and one spa appointment per departure.



Category A Solo

Main Deck: #504-510, 513

Suite with balcony that features two balcony chairs and a table; single bed, writing desk with an office chair, bedside table, and a closet.



Category B Solo

Lounge Deck: #604-607, 609, 611

Suite with balcony that features two balcony chairs, hammock, and a table; single bed, bedside table, writing desk with chair, hammock, and a closet.



Observation Deck

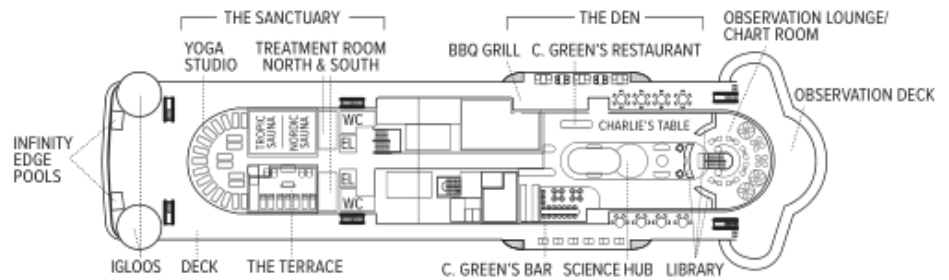

Bridge Deck

- Category 5
- Category 6
- Category 7

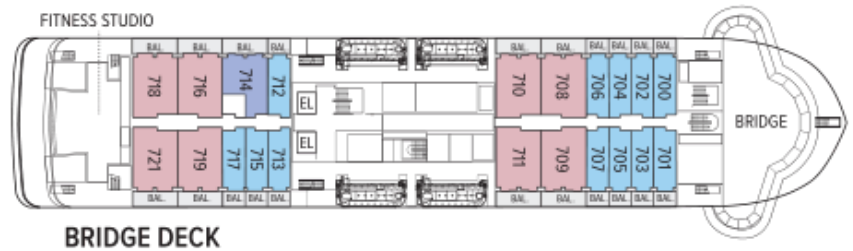

Lounge Deck

- Category 4
- Category B Solo

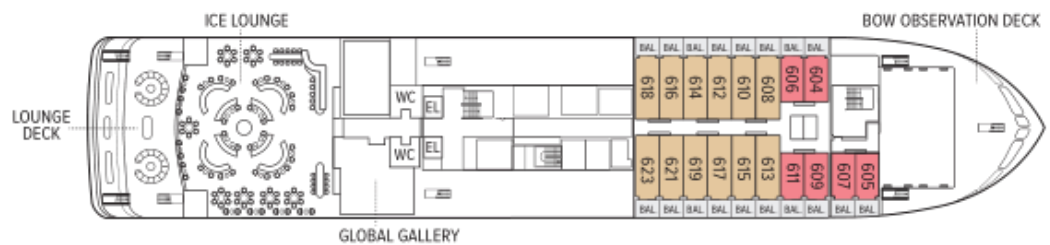

Main Deck

- Category 3
- Category 2 Solo



Fore Deck

- Category 1
- Category 2



Expedition Deck

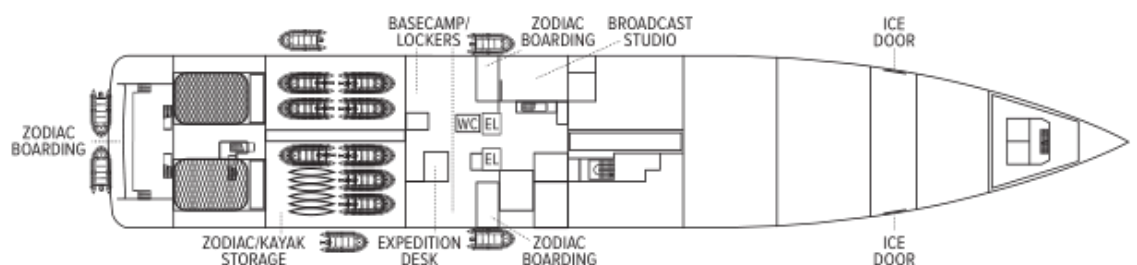

Ship amenities

Public Areas

Reception; three dining areas; an observation lounge with bar, gym, wellness area, infinity-style outdoor hot tubs with adjacent igloos; library; main lounge with full service bar, 24-hour beverage station, state-of-the-art tech for films/presentations; B&H Photo locker and a photo workshop area; science hub; an onboard broadcast studio; an expedition base with lockers for expedition gear; and open access to the Bridge, Captain, officers and on-duty wildlife spotters.

Meals

Restaurant 270° features wrap-around views; two other dining areas offer lighter, made-to-order fare or intimate, small group dinners. All feature sustainable choices, local where possible, and unassigned, flexible, inclusive seating.

Cabins

All cabins face outside with large windows, private bathroom, and climate controls. Cabins are equipped with expedition command centers with iPad tablets, multiple electrical and USB outlets, TVs, with on demand entertainment, phone, Wi-Fi, clock, barometers, hygrometers, vanity mirror, mini refrigerator, small safe, ice bucket, glasses, hair dryer, reading lights and National Geographic Atlas. Luxury linens and pillows. Bathrooms outfitted with Rain showers & hand held shower, botanically inspired shampoo, conditioner, shower gel and lotion. Complimentary insulated water bottles. Balcony cabins have hammocks, chairs and table.

Expedition Equipment

Zodiac landing craft, kayaks, snowshoes, cross-country skis, an ROV and underwater video camera for unique access to the polar undersea, hydrophone, aerial remote-controlled camera and video microscope.

Special Features

A full-time doctor, undersea specialist, National Geographic photographer, Lindblad-National Geographic certified photo instructor and video chronicler, an internet cafe and laundry. A forward and aft staircase, and elevators, reach all decks. Echoing the pioneering installation aboard *National Geographic Endurance*, artist Zaria Forman has curated a new exhibit, featuring a wide range of artists.



Wellness

A glass-enclosed yoga studio, gym, treatment rooms and spa relax area, and high and low-heat saunas with ocean views, staffed by wellness specialists.

Self-Disinfecting Ships

ACT Clean Coat™ is a light-activated, self-disinfecting cleaning process that continuously breaks down viruses, bacteria, mold, and airborne allergens across all ship surfaces. Not only does this create a cleaner, healthier shipboard environment for guests and crew alike, but this non-toxic, chemical-free system also saves more than one million gallons of water each year in our cleaning procedures, and reduces our carbon footprint as well as the amount of plastic and waste in our supply chain.

Special Offers

SUITE EXCLUSIVES

Spacious living areas and incredible views immerse you in the beauty of your marine surroundings. Our new Suite Exclusives package helps make your voyage all the more memorable. [Learn more](#)

10% OFF BACK-TO-BACK VOYAGES

Save 10% on consecutive departures, applicable on voyage fares only and not valid on extensions or airfare. Valid for new bookings only, subject to availability, and may not be combined with other offers. Call for details.

BRINGING THE KIDS

We believe sharing an expedition with children is a life-enhancing experience. Take \$500 off for each child under the age of 18 on any departure. Not applicable on extensions or airfare. Call for details.

CELEBRATE LIFE'S MILESTONES

Celebrate a milestone with a group of eight or more and enjoy a special amenity package including: 5% savings on voyage fares, custom group photo, US\$150 shipboard credit for the group, and other special gifts. Milestone celebration to be communicated at time of booking. Valid for new bookings only on select departures, subject to availability, not applicable on airfare or extensions, and may not be combined with other offers. Deposit, final payments, and cancellation policies for group travel vary from our regular policies. Call for details.

SAVE 5% TRAVELING AS A GROUP

Save 5% when traveling as a group of eight or more

people. Valid on voyage fares only and not applicable on extensions or airfare. Deposit, final payments, and cancellation policies for group travel vary from our regular policies. Valid for new bookings only, subject to availability, and may not be combined with other offers. Call for details.

COMBINING OFFERS

Certain offers may be combinable, up to two savings opportunities, except where noted otherwise. For example, travel with a group of 8 or more on back-to-back expeditions, and take advantage of both savings.

Included in price

All accommodations aboard ship or in hotels per itinerary; all meals as indicated in the itinerary, both aboard and onshore; beer, wine, cocktails, and spirits aboard the ship (except certain super premium brands which are available for purchase); hors d'oeuvres, 24-hour access to snacks, premium coffees and teas, non-alcoholic beverages, and filtered water; excursions and airport transfers to and from recommended flights, as indicated in the itinerary; crew gratuities; exploration tools curated to destination, such as Zodiacs and kayaks; guidance and company of our leading expedition staff; assistance by the National Geographic Photography Expert and Lindblad Expeditions-National Geographic certified photo instructor; access to the OM System Photo Gear Locker; presentations by expedition staff and expert guest speakers; complimentary reusable water bottle; services of a physician, physician's assistant, nurse practitioner, or paramedic; morning stretch classes and 24-hour access to exercise equipment; 24-hour access to lounges, observation decks, library, and other shared spaces; park and site entrance fees, special access permits, and port taxes. Unused services or items included in our programs are non-refundable.

Not included in price

Airfare (except flights when indicated as included); pre- and post-expedition extensions; additional hotel nights (except when indicated as included); private transfers; laundry, spa treatments, Wi-Fi, and phone services (except when indicated as included); travel protection plans; and passport, visa, and immigration fees.

Travel protection plan

We strongly recommend our guests to take advantage of our Travel Protection Plan. This plan offers comprehensive coverage to protect you from cancellation fees, costs incurred due to trip delays/interruption, damage or loss of baggage, medical assistance, and evacuation during your travels. Our Travel Protection Plan is available for U.S. residents only, and may be purchased any time prior to final payment due date, Travel Protection premiums are non-refundable once plan is purchased. Learn more about our Travel Protection "Plus" Plan: <https://www.expeditions.com/terms-conditions/travel-protection-plan/>

Cancellation policy

Review our cancellation policy: <https://www.expeditions.com/cancellation-policy/>