



Alaska & North America
58° 39' N 136° 54' W

Exploring Alaska's Coastal Wilderness

Do more than just see Alaska—be an active participant in all that it has to offer. Voyage into majestic fjords, come face to face with glaciers, and kayak along the coast in search of marine life. Learn about whale behavior and watch for breaching and spy-hopping humpbacks and orcas. Enjoy a full day immersed in the beauty of Glacier Bay National Park.

From

\$ 6,286 / per person
Does not include flights



DATES

May, Jun, Jul,
Aug and Sep



DURATION

8 Days



SHIPS

National Geographic Quest
National Geographic Venture



STARTS AT

Juneau,
Alaska



ENDS AT

Sitka, Alaska

Please review the [Essential Eligibility Criteria](#) for hiking activities on this voyage.

The [National Park Service](#) and the Department of the Interior authorize this institution to serve the public in Glacier Bay National Park and Preserve.

This institution is an [equal opportunity provider](#).

Highlights

- ★ Hike through lush forests and muskegs, kayak into secluded inlets, and cruise by Zodiac among electric blue icebergs and curious wildlife
- ★ Encounter iconic Alaska wildlife such as humpback whales, bears, otters, and bald eagles
- ★ Witness calving glaciers and search for puffins and mountain goats on a full-day exploration of Glacier Bay National Park and Preserve
- ★ Meet our conservation partners from the Alaska Whale Foundation (schedules permitting) and learn how you can contribute to their research throughout your voyage





Day by day

■ DAY 1

Juneau, Alaska / Embark Ship

Arrive in Juneau, Alaska’s capital city, in the early afternoon and embark *National Geographic Venture* or *National Geographic Quest* in time for cocktails and an introduction of the vessel staff and crew.

Please note: Itinerary stops and sequence subject to modification.

Arrival Time: Arrive by 3:00 p.m. local time.

Arrival City: Juneau, Alaska

Meals included: dinner

◇ DAY 2

Tracy Arm-Fords Terror Wilderness

Our Forest Service Special Use Permit for Tongass National Forest enables guests to hike and kayak in wild and remote areas of Southeast Alaska.

Voyage into Tracy or Endicott Arm, both spectacular fjords with waterfalls cascading from glacially carved walls. See the soaring Dawes or South Sawyer Glacier up close and take a cruise in a Zodiac for an unbeatable view among sculpted icebergs. Keep an eye out for harbor seals, harbor porpoises, and arctic terns.

Meals included: breakfast, lunch, dinner

◇ DAY 3

Petersburg

Visit the small, true Alaska fishing town of Petersburg on Mitkof Island, which still retains much of its Norwegian heritage. Explore a unique Southeast Alaska ecosystem, the muskeg, with stunted trees and carnivorous plants. There is an opportunity to stretch your legs with an optional bike ride around town. This evening, enjoy a crab feast.

Meals included: breakfast, lunch, dinner

◇ DAY 4

Frederick Sound and Chatham Strait

These waters are prime areas for both orca and humpback whales. With luck, guests may observe their fascinating behavior—breaching, tail-slapping and variations on feeding—as we fill the deck and listen to the play-by-play from our expert naturalists. We will explore spectacular bays and inlets, following bear trails and salmon streams. Once ashore, we have the opportunity to walk along a quiet forest trail. The still waters are excellent for kayaking, offering another option for up-close exploration.

Meals included: breakfast, lunch, dinner

◇ DAY 5

Icy Strait and the Inian Islands

Explore among the Inian Islands, a busy feeding ground for myriad wildlife species including Steller sea lions and sea otters. We will search for marine mammals in the nutrient-rich waters of Icy Strait and choose the perfect spot around Chichagof Island to hike where sightings of bald eagles are common.

Meals included: breakfast, lunch, dinner

◇ DAY 6

Glacier Bay National Park

Spend the entire day amid the coves, fjords, tidewater glaciers, and majestic mountains of Glacier Bay National Park. Witness glaciers that end abruptly at the water’s edge and observe them calving, when tons of ice separate and crash into the water accompanied by a thunderous sound. Mountain goats scaling the peaks, as well as harbor seals, Steller sea lions, and puffins, are some of the

creatures we may observe. A visit to Tidal Inlet may bring the sight of brown bears lumbering up the hillside.

Meals included: breakfast, lunch, dinner

◇ DAY 7

Southeast Alaska's Islands, Bays, and Fjords

Today, nature is our guide as we set forth with the flexibility to take advantage of wildlife and weather conditions. We may stop at an isolated beach to take a closer look at tide pools, beachcomb, and hike stunning forest trails. Keep an eye out for old bear tracks worn into the soil as you move from forest to meadow. Sightings of bald eagles are common. If conditions permit, we will do some kayaking, always watching for marine and terrestrial life.

Meals included: breakfast, lunch, dinner

■ DAY 8

Sitka / Disembark Ship

Disembark after breakfast in picturesque Sitka on the western coast of Baranof Island. Schedules permitting, walk among Tlingit and Haida totem poles at Sitka National Historic Park and visit the Alaska Raptor Center for an up-close look at Alaska's birds of prey. Transfer to the airport for flights home.

Departure Time: After 1:00 p.m. local time.

Departure City: Sitka, Alaska

Meals included: breakfast

Expedition (Westbound)

Juneau, Alaska → Sitka, Alaska

2024 Departure Dates

Aboard *National Geographic Quest*

26 May		
09 Jun	23 Jun	
07 Jul		
04 Aug	18 Aug	
01 Sep		

Aboard *National Geographic Venture*

18 May		
01 Jun	15 Jun	29 Jun
13 Jul	27 Jul	
10 Aug	24 Aug	

2025 Departure Dates

Aboard *National Geographic Quest*

01 Jun	15 Jun	29 Jun	
13 Jul	27 Jul		
10 Aug	24 Aug		
07 Sep			

Aboard *National Geographic Venture*

17 May	31 May		
14 Jun	28 Jun		
12 Jul	26 Jul		
09 Aug	23 Aug		

Alternative Routes

Visit Expeditions.com for more information.

2024 Departure Dates

11 May, 19 May, 25 May, 02 Jun, 08 Jun,
16 Jun, 22 Jun, 30 Jun, 06 Jul, 20 Jul,
28 Jul, 03 Aug, 11 Aug, 17 Aug, 25 Aug

2025 Departure Dates

10 May, 24 May, 25 May, 07 Jun, 08 Jun,
21 Jun, 22 Jun, 05 Jul, 06 Jul, 19 Jul, 20 Jul,
02 Aug, 03 Aug, 16 Aug, 17 Aug, 31 Aug



National Geographic Quest

Guests

100

Cabins

50

***National Geographic Quest*, built in 2017, is designed for sailing into fast-moving channels and shallow coves in pan-American waters.**

When she rolled out of Nichols Brothers shipyard and into the bay on Whidbey Island, the 100 guest *National Geographic Quest* became the third ship in the Lindblad fleet built at this storied Pacific Northwest shipyard. In the 1970s, Nichols Brothers built the twin ships *National Geographic Sea Bird* and *National Geographic Sea Lion*, which continue to sail the waters of the west coast of North America and Central America.

National Geographic Quest was purpose-built to explore the fast-moving channels and narrow straits of Alaska, along the coast of Costa Rica, and into the gray whale nursery lagoons of Baja, her design and engineering informed by our nearly 40 years of experience in these regions. Her twin boarding platforms, for example, were suggested by a veteran staffer. Enabling our team to load two Zodiacs at once means guests get off the ship quickly to take advantage of wildlife sightings and maximize exploring time.

Larger than her siblings *National Geographic Sea Bird* and *National Geographic Sea Lion*, *National Geographic Quest* has the same shallow draft, allowing her captain to navigate the same inner reaches and provide the same intimate, "insider" experiences in these charismatic regions. Modern, clean-lined, with large expanses of glass to keep you connected to the extraordinary views, *National Geographic Quest* enables you to see, do, and experience the best of her geographies.



Cabin Categories

Category 1

Main Deck: #301-306

Cabins feature two single beds that can convert to a Queen, a writing desk, two nightstands and two portholes, full length mirror, and reading lights.



Category 2

Main Deck: #307-315

Cabins feature two single beds that can convert to a Queen, a writing desk, two nightstands and two portholes, full length mirror, and reading lights.



Category 3

Upper Deck: #201-206

Cabins feature two single beds that can convert to a Queen, a writing desk, two nightstands, a large view window, full-length mirror, and reading lights.



Category 4

Upper Deck: #207-229

Cabins feature two single beds that can convert to a Queen, a writing desk, closet, two nightstands, full-length mirror, reading lights, sliding glass door, and a small, private balcony.



Note: Solo occupancy cabins are available in Categories 1 and 2 only. Third person rates are available in Category 5 cabins at one half the double occupancy rate.

Connecting Cabins via internal doorway access:

Main Deck: #312-314, #311-315, #306-307;
Upper Deck: #224-226, #225-227

Category 5

Observation Deck: #101-108 (SUITE)

Cabins feature two single beds that can convert to a Queen, large view windows, closet, two nightstands, full-length mirror, reading lights, a suite-sized expanded bathroom, writing desk, ample storage space, and a convertible sofa bed to accommodate a third person.



Observation Deck

Category 5

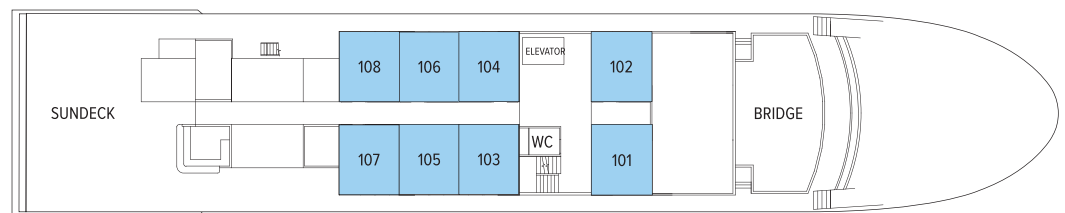

Lounge Deck

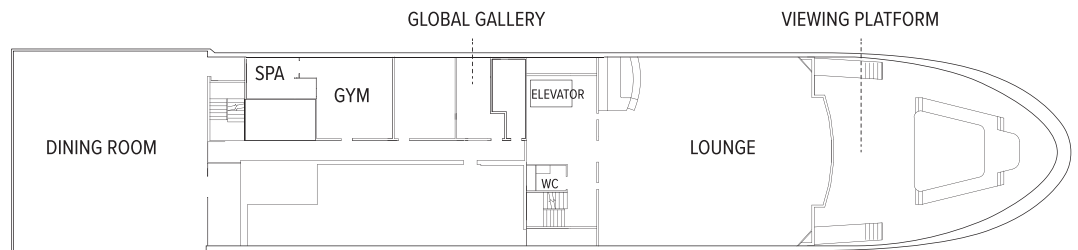

Upper Deck

Category 3

Category 4

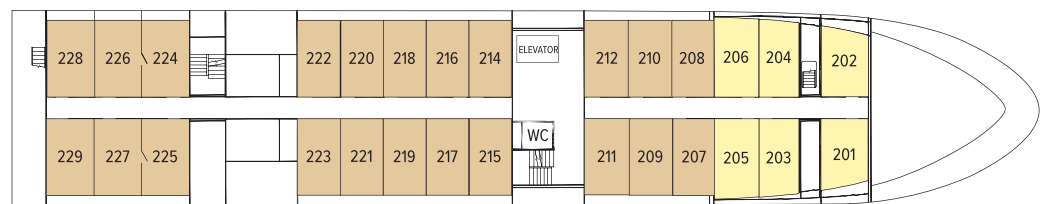

Main Deck

Category 1

Category 2

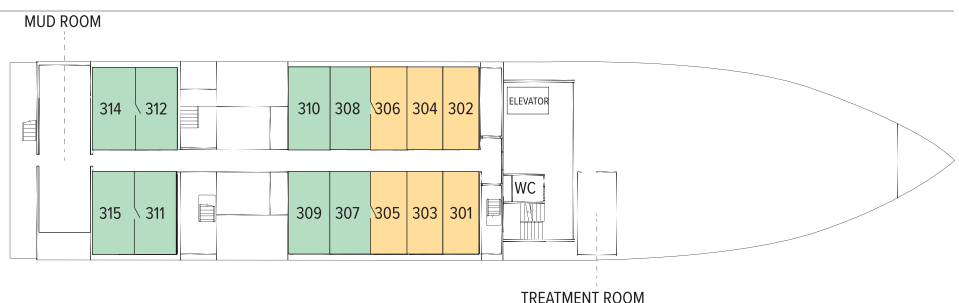

Ship amenities

Public Areas

Reception; main dining area; global gallery; fitness center; lounge with full-service bar and state-of-the-art presentation facilities; observation deck; mudroom with lockers for expedition gear; partially-covered furnished sundeck; plus open access to the Bridge, the Captain, officers and on-duty wildlife spotters.

Meals

Meals are served in the dining room at a single seating with unassigned tables for an informal atmosphere and easy mingling. Menus feature sustainable choices, local where possible.

Cabins

50 outside cabins. All cabins face outside with windows, private bathroom, and climate controls. Cabins are equipped with Wi-Fi, phone, multiple electrical and USB outlets, and phones. Luxury linens and pillows. Botanically inspired shampoo, conditioner, shower gel, and lotion are all available in cabin bathrooms, as well as an Expedition Essential Kit. Hair dryers, complimentary insulated water bottles and a National Geographic Atlas are also available in each cabin.

Expedition Equipment

A fleet of 8 Zodiacs, 24 kayaks, paddleboards; an ROV, hydrophone, splash-cam, underwater video camera, video microscope; snorkeling gear and wet suits for all guests (where applicable).

Special Features

Lindblad-National Geographic certified photo instructor, undersea specialist and video chronicler. Internet access. Elevator. The design of the outside decks—with the perfect wildlife viewing platform. And the way the proximity of the Lounge to the deck gives you instant access to spontaneous sightings. Have your camera ready!

Wellness

A fitness center with elliptical, treadmill, weights, resistance bands; LEXspa treatment room, staffed by wellness specialists.



Self-Disinfecting Ships

ACT Clean Coat™ is a light-activated, self-disinfecting cleaning process that continuously breaks down viruses, bacteria, mold, and airborne allergens across all ship surfaces. Not only does this create a cleaner, healthier shipboard environment for guests and crew alike, but this non-toxic, chemical-free system also saves more than one million gallons of water each year in our cleaning procedures, and reduces our carbon footprint as well as the amount of plastic and waste in our supply chain.



National Geographic Venture

Guests

100

Cabins

50

The *National Geographic Venture* is a state-of-the-art expedition ship ideal for discovering remote locations in domestic waters.

Following the build of *National Geographic Quest* at Nichols Brothers shipyard, her sister ship the 100 guest *National Geographic Venture* floated into the bay on Whidbey Island, becoming the 4th ship in the Lindblad fleet built at this storied PNW shipyard. In the 1970s, Nichols Brothers built the twin ships *National Geographic Sea Bird* and *National Geographic Sea Lion*, which continue to sail the waters of the west coast of North America and Central America.

Venture, like much of the wildlife she follows, is migratory. She follows the seasons from Alaska, along the coast of British Columbia, up the Columbia & Snake Rivers, and along the Baja coast and into the Sea of Cortez. In each region, her design innovations were informed by 50+ years of expedition expertise to ensure extraordinary discoveries. Larger than her sibling twin ships, *National Geographic Sea Bird* and *National Geographic Sea Lion*, *National Geographic Venture* has the same shallow draft, enabling her to nimbly navigate the same inner reaches and provide the same intimate, 'insider' experiences of the charismatic regions we explore.

Like her sister ship *National Geographic Quest*, *National Geographic Venture* has dual boarding platforms, enabling our team to load two Zodiacs at once means guests get off ship quickly, to take advantage of wildlife sightings and maximize exploring time. Modern, cleaned-lined, with large expanses of glass to keep you connected to the extraordinary views, *National Geographic Venture* enables you to see, do and experience the best of her geographies.



Cabin Categories

Category 1

Main Deck: #301-306

Cabins feature two single beds that can convert to a Queen, a writing desk, two nightstands and two portholes, full length mirror, and reading lights.



Category 2

Main Deck: #307-315

Cabins feature two single beds that can convert to a Queen, a writing desk, two nightstands and two portholes, full length mirror, and reading lights.



Category 3

Upper Deck: #201-206

Cabins feature two single beds that can convert to a Queen, a writing desk, two nightstands, a large view window, full-length mirror, and reading lights.



Category 4

Upper Deck: #207-229

Cabins feature two single beds that can convert to a Queen, a writing desk, closet, two nightstands, full-length mirror, reading lights, sliding glass door, and a small, private balcony.



Note: Solo occupancy cabins are available in Categories 1 and 2 only. Third person rates are available in Category 5 cabins at one half the double occupancy rate.

Connecting Cabins via internal doorway access:

Main Deck: #312-314, #311-315, #306-307;
Upper Deck: #224-226, #225-227

Category 5

Observation Deck: #101-108 (SUITE)

Cabins feature two single beds that can convert to a Queen, large view windows, closet, two nightstands, full-length mirror, reading lights, a suite-sized expanded bathroom, writing desk, ample storage space, and a convertible sofa bed to accommodate a third person.



Observation Deck

Category 5

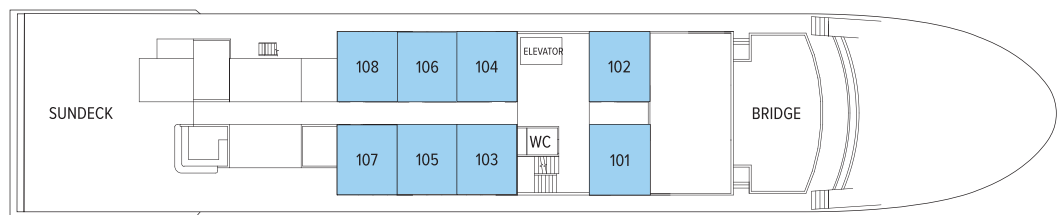

Lounge Deck

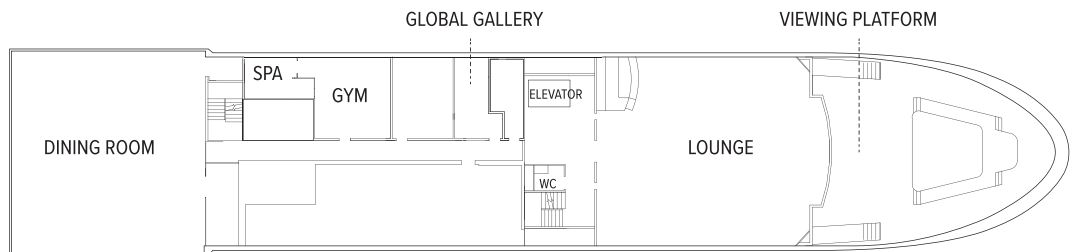

Upper Deck

Category 3

Category 4

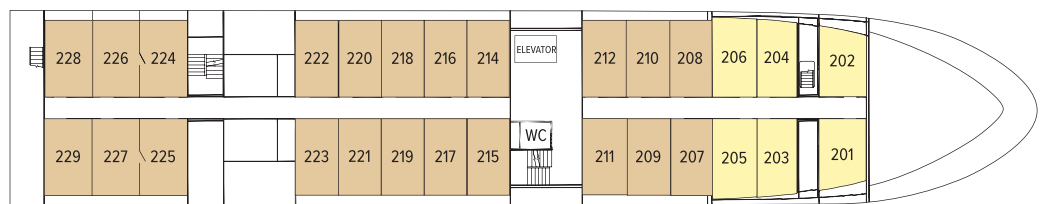

Main Deck

Category 1

Category 2

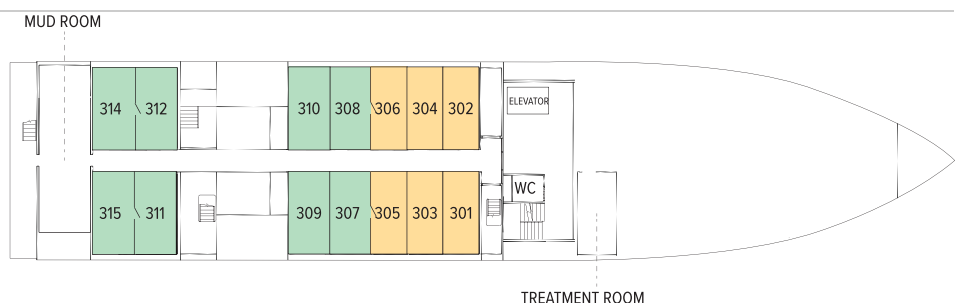

Ship amenities

Public Areas

Reception; main dining area; global gallery; fitness center; lounge with full-service bar and state-of-the-art presentation facilities; observation deck; mudroom with lockers for expedition gear; partially-covered furnished sundeck; plus open access to the Bridge, the Captain, officers and on-duty wildlife spotters.

Meals

Meals are served in the dining room at a single seating with unassigned tables for an informal atmosphere and easy mingling. Menus feature sustainable choices, local where possible.

Cabins

50 outside cabins. All cabins face outside with windows, private bathroom, and climate controls. Cabins are equipped with Wi-Fi, phone, multiple electrical and USB outlets, and phones. Luxury linens and pillows. Botanically inspired shampoo, conditioner, shower gel, and lotion are all available in cabin bathrooms, as well as an Expedition Essential Kit. Hair dryers, complimentary insulated water bottles and a National Geographic Atlas are also available in each cabin.

Expedition Equipment

A fleet of 8 Zodiacs, 24 kayaks, paddleboards; an ROV, hydrophone, splash-cam, underwater video camera, video microscope; snorkeling gear and wet suits for all guests (where applicable).

Special Features

Lindblad-National Geographic certified photo instructor, undersea specialist and video chronicler. Internet access. Elevator. The design of the outside decks—with the perfect wildlife viewing platform. And the way the proximity of the Lounge to the deck gives you instant access to spontaneous sightings. Have your camera ready!

Wellness

A fitness center with elliptical, treadmill, weights, resistance bands; LEXspa treatment room, staffed by wellness specialists.



Self-Disinfecting Ships

ACT Clean Coat™ is a light-activated, self-disinfecting cleaning process that continuously breaks down viruses, bacteria, mold, and airborne allergens across all ship surfaces. Not only does this create a cleaner, healthier shipboard environment for guests and crew alike, but this non-toxic, chemical-free system also saves more than one million gallons of water each year in our cleaning procedures, and reduces our carbon footprint as well as the amount of plastic and waste in our supply chain.

Special Offers

SUITE EXCLUSIVES

Spacious living areas and incredible views immerse you in the beauty of your marine surroundings. Our new Suite Exclusives package helps make your voyage all the more memorable. [Learn more](#)

10% OFF BACK-TO-BACK VOYAGES

Save 10% on consecutive departures, applicable on voyage fares only and not valid on extensions or airfare. Valid for new bookings only, subject to availability, and may not be combined with other offers. Call for details.

BRINGING THE KIDS

We believe sharing an expedition with children is a life-enhancing experience. Take \$500 off for each child under the age of 18 on any departure. Not applicable on extensions or airfare. Call for details.

SAVE 5% TRAVELING AS A GROUP

Save 5% when traveling as a group of eight or more people. Valid on voyage fares only and not applicable on extensions or airfare. Deposit, final payments, and cancellation policies for group travel vary from our regular policies. Valid for new bookings only, subject to availability, and may not be combined with other offers. Call for details.

CELEBRATE LIFE'S MILESTONES

Celebrate a milestone with a group of eight or more and enjoy a special amenity package including: 5% savings on voyage fares, custom group photo, US\$150 shipboard credit for the group, and other special gifts. Milestone celebration to be communicated at time

of booking. Valid for new bookings only on select departures, subject to availability, not applicable on airfare or extensions, and may not be combined with other offers. Deposit, final payments, and cancellation policies for group travel vary from our regular policies. Call for details.

COMBINING OFFERS

Certain offers may be combinable, up to two savings opportunities, except where noted otherwise. For example, travel with a group of 8 or more on back-to-back expeditions, and take advantage of both savings.

Included in price

All accommodations aboard ship or in hotels per itinerary; all meals as indicated in the itinerary, both aboard and onshore; beer and wine on all 2023 departures (starting in 2024, spirits and cocktails are also included, with super premium wines and liquors available for purchase); hors d'oeuvres, 24-hour access to snacks, premium coffees and teas, non-alcoholic beverages, and filtered water; excursions and airport transfers to and from recommended flights, as indicated in the itinerary; exploration tools curated to destination, such as Zodiacs, stand-up paddleboards, kayaks; guidance and company of our leading expedition staff; assistance by the Lindblad Expeditions-National Geographic certified photo instructor; access to the OM System Photo Gear Locker; presentations by expedition staff and expert guest speakers; complimentary reusable water bottle; services of a physician, physician's assistant, nurse practitioner, or paramedic; morning stretch classes and 24-hour access to exercise equipment; 24-hour access to lounges, observation decks, library, and other shared spaces; park and site entrance fees, special access permits, and port taxes. Unused services or items included in our programs are non-refundable.

Not included in price

Airfare (except flights when indicated as included); pre- and post-expedition extensions; additional hotel nights (except when indicated as included); crew gratuities; private transfers; laundry, spa treatments, Wi-Fi, and phone services (except when indicated as included); travel protection plans; and passport, visa, and immigration fees.

Travel protection plan

We strongly recommend our guests to take advantage of our Travel Protection Plan. This plan offers comprehensive coverage to protect you from cancellation fees, costs incurred due to trip delays/interruption, damage or loss of baggage, medical assistance, and evacuation during your travels. Our Travel Protection Plan is available for U.S. residents only, and may be purchased any time prior to final payment due date, Travel Protection premiums are non-refundable once plan is purchased. Learn more about our Travel Protection "Plus" Plan: <https://www.expeditions.com/terms-conditions/travel-protection-plan/>

Cancellation policy

Review our cancellation policy: <https://www.expeditions.com/cancellation-policy/>